

METRIC
 ALL DIMENSIONS IN METRES
 UNLESS OTHERWISE NOTED

FAR-SIDE BUS STOP

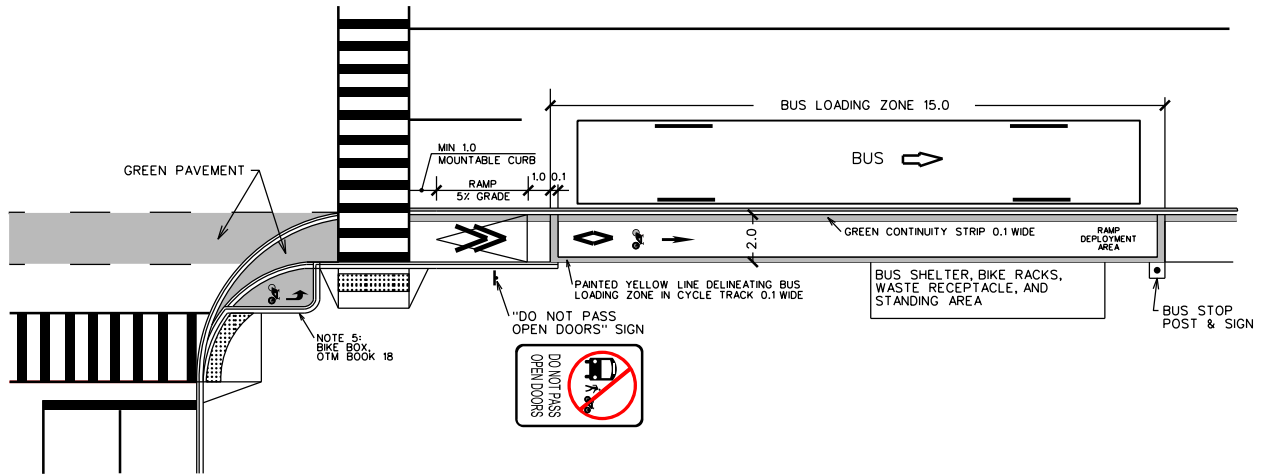

NEAR-SIDE BUS STOP

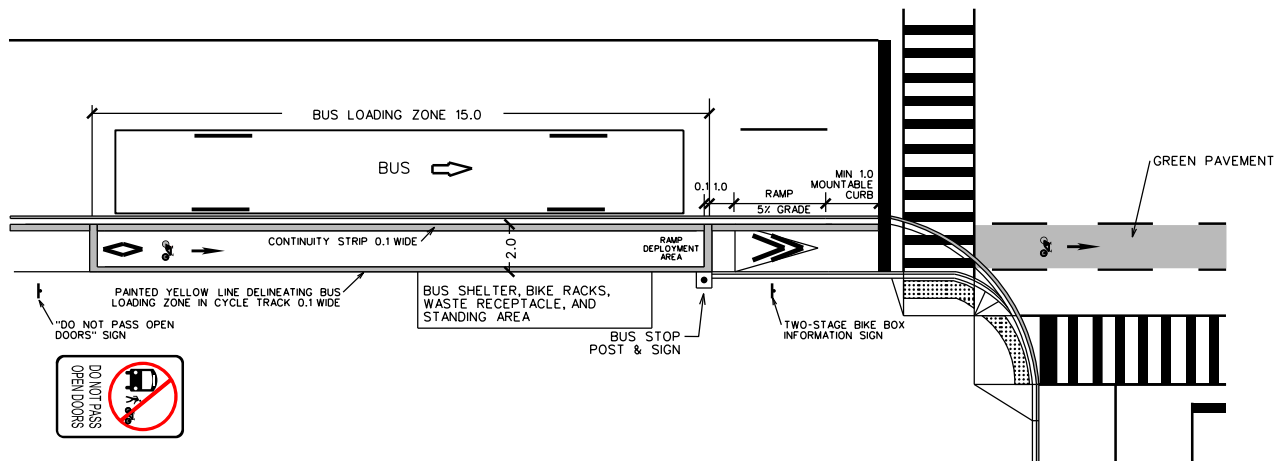

NOTES:

1. FOR BUS STOP DETAIL REFER TO CITY STANDARDS DWG. No. 2260.010 TO No. 2260.030.
2. FOR ADDITIONAL TRANSIT DETAILS REFER TO CITY STANDARDS DWG. No. 2250.010 TO 2250.050, DWG. No. 2260.010 TO 2250.030, DWG. No. 2270.010 TO 2270.050 AND DWG. No. 2280.010
3. FOR ONE-WAY CYCLE TRACK (IN-BOULEVARD) DETAIL REFER TO CITY STANDARD DWG. No. 2240.081
4. ALL PADS AND PLATFORMS TO BE SLOPED 2% TOWARDS THE ROAD OR AS OTHERWISE NOTED.
5. BIKE BOX TO BE CONSIDERED ONLY ON ROADWAYS WITH FOUR OR MORE LANES AND AT INTERSECTIONS WHERE THE PERPENDICULAR ROAD CONTAINS CYCLING INFRASTRUCTURE. FOR ADDITIONAL DETAILS, REFER TO BIKE BOX, OTM BOOK 18.



STANDARD

ONE-WAY RAISED CYCLE TRACK-
 NEAR-SIDE & FAR-SIDE BUS STOPS

EFF. DATE	2016-10-31	SCALE	N.T.S.
REV.		STANDARD No. 2240.083	