

**DEPARTMENTS**

- 03 CRITICAL CARE
- 11 DIAGNOSTIC IMAGING
- 17 SURGICAL INTERVENTIONAL
- 18 CORPORATE ADMIN
- 25 PUBLIC AREAS, RETAIL & AMENITY
- 27 SPIRITUAL CARE
- 28 STAFF + MED STAFF
- 32 CORPORATE SERVICES
- 34 MATERIALS MANAGEMENT
- CIRCULATION PAT/STAFF
- CIRCULATION PUBLIC
- ELEVATOR LABOUR/ DELIVERY
- ELEVATOR PAT/STAFF
- ELEVATOR PUBLIC
- ELEVATOR SERVICE - AGV
- ELEVATOR SERVICE - MDR
- ELEVATOR SERVICE/STAFF
- ELEVATOR TRAUMA
- PLANT - COMMS
- PLANT - ELEC
- PLANT - MECH SHAFT
- STAIRS
- UNASSIGNED

**1 DEPARTMENTAL ZONE STUDY - LEVEL 5**  
A-203 1:500

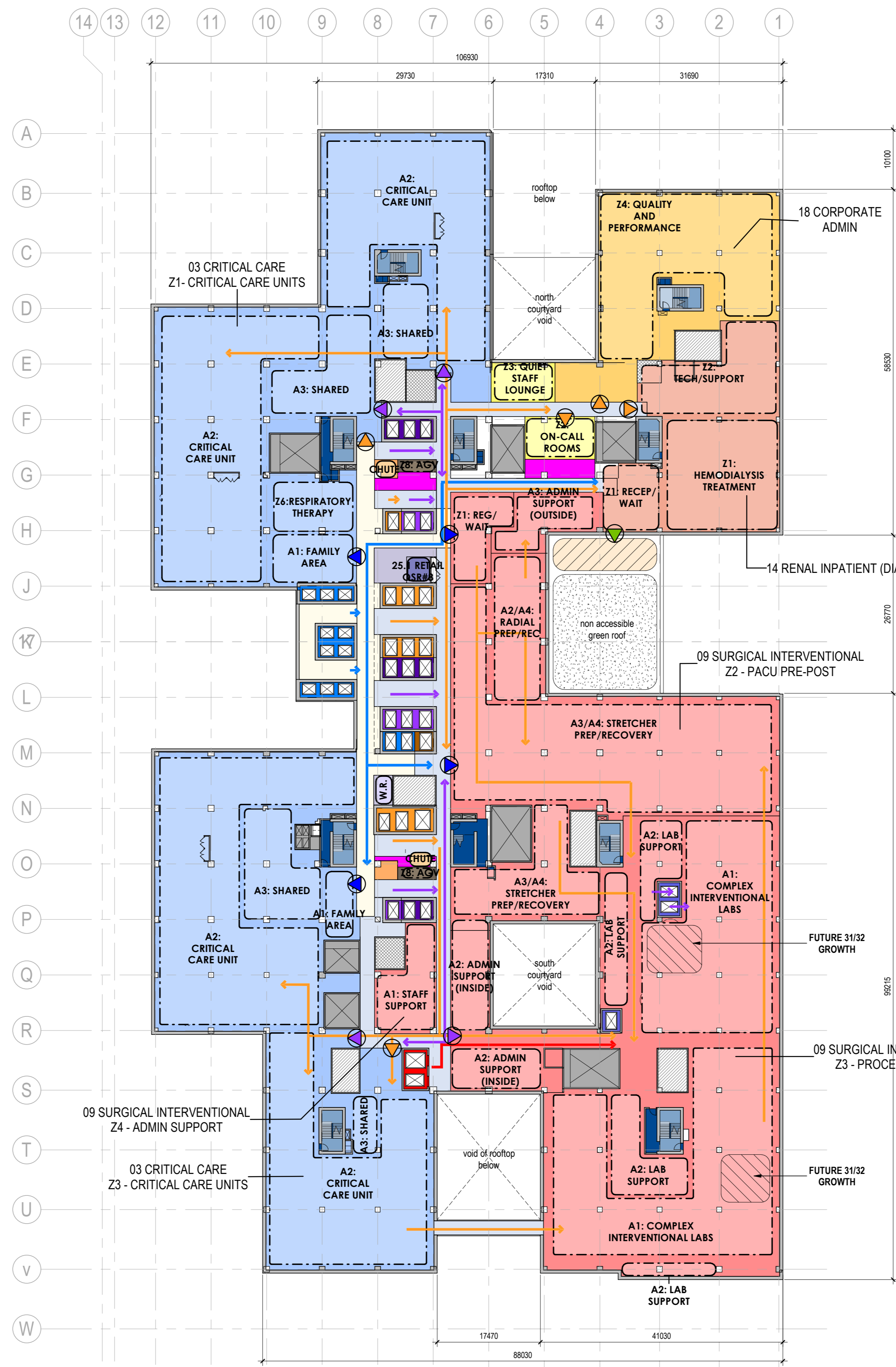

**DEPARTMENTS**

- 03 CRITICAL CARE
- 09 SURGICAL INTERVENTIONAL
- 14 RENAL INPATIENT (DIALYSIS)
- 18 CORPORATE ADMIN
- 25 PUBLIC AREAS, RETAIL & AMENITY
- 25.1 RETAIL/WELLNESS CENTRE
- 28 STAFF + MED STAFF
- 32 CORPORATE SERVICES
- 34 MATERIALS MANAGEMENT
- CIRCULATION PAT/STAFF
- CIRCULATION PUBLIC
- ELEVATOR LABOUR/ DELIVERY
- ELEVATOR PAT/STAFF
- ELEVATOR PUBLIC
- ELEVATOR SERVICE - AGV
- ELEVATOR SERVICE - MDR
- ELEVATOR SERVICE/STAFF
- ELEVATOR TRAUMA
- PLANT - COMMS
- PLANT - ELEC
- PLANT - MECH SHAFT
- STAIRS
- UNASSIGNED

**2 DEPARTMENTAL ZONE STUDY - LEVEL 6**  
A-203 1:500

**DEPARTMENTAL ZONE LEGEND**

**ACCESSIBLE TERRACE TYPE**  
\* INDICATES BALCONIES

- PROGRAMMED ROOF TERRACE (APPROX. 80% PAVING / 20% PLANTING)
- PROPOSED HARD LANDSCAPING
- PAVING AT GRADE OVER OCCUPIED BELOW-GRADE BUILDING AREA

**ROOF TYPE**

- TYPE 1 - NON ACCESSIBLE VEGETATIVE ROOF (APPROX. 80% PLANTING / 20% GRAVEL SERVICE PATHS)
- TYPE 2 - NON ACCESSIBLE DECORATIVE GRAVEL ROOF
- TYPE 3 - TYPICAL FLAT ROOF
- TYPE 4 - HIGH SRI FLAT ROOF

**OTHER SYMBOLS**

- ENTRANCE - PUBLIC
- ENTRANCE - PATIENT/STAFF
- ENTRANCE - SERVICE
- EMERGENCY EXIT
- TERRACE/ROOFTOP ACCESS
- FLOW LINE - PUBLIC
- FLOW LINE - PATIENT/STAFF
- FLOW LINE - SERVICE
- FLOW LINE - TRAUMA
- 90 MIN FIRE SEPARATION (REFER TO I0)

5	SITE PLAN CONTROL APPLICATION (SPA)	2021.12.04
4	PRELIMINARY COORDINATING	2021.08.06
3	BULKHEAD SUBMISSION	2021.05.31
2	ISSUED FOR LOCAL PERMIT	2021.03.24
1	STAGE 2 SUBMISSION	2020.12.18
Issue/Revision		By App'd YYYY.MM.DD

CONFIDENTIAL PROJECT  
**NOT FOR CONSTRUCTION**

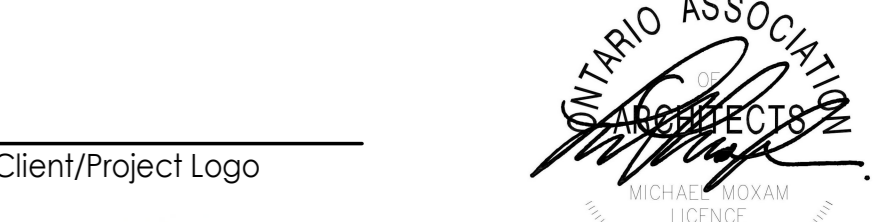

Client/Project  
TRILLIUM HEALTH PARTNERS  
NEW MISSISSAUGA HOSPITAL TOWER  
PAM 21-323 W7

100 QUEENSWAY WEST & 2250 HURONTARIO ST  
MISSISSAUGA ON

Title  
LEVEL 5 AND 6 DEPARTMENTAL ZONE PLANS

Project No. 140020191 Scale As Indicated  
Revision Drawing No. 5

