

## RESIDENTIAL SOLID WASTE MANAGEMENT NOTES:

### SOLID WASTE MANAGEMENT REQUIREMENTS AS PER THE PEEL WASTE COLLECTION DESIGN STANDARDS MANUAL:

PEEL WASTE MANAGEMENT REQUIRES INTERNAL STORAGE AREAS TO BE LARGE ENOUGH TO CONTAIN ALL THE REQUIRED NUMBER OF FRONT-END GARBAGE BINS, IN ADDITION TO A SPACE (A MINIMUM OF 10 m<sup>2</sup>) FOR THE STORAGE OF BULKY ITEMS.

THE AREA OF GARBAGE BINS IS CALCULATED AT 10 m<sup>2</sup> FOR THE FIRST BIN AND 6m<sup>2</sup> FOR EACH BIN THEREAFTER. EACH 4 CUBIC YARD BIN CONTAINING COMPACTED WASTE CAN ACCOMMODATE 72 UNITS. FOR RECYCLABLE MATERIALS, EACH 10 UNITS REQUIRES 0.5 CUBIC YARDS OF SPACE WHICH ARE NOT TO BE COMPACTED.

THE TURNING RADIUS FROM THE CENTRE LINE HAS TO BE A MINIMUM OF 13 METRES ON ALL TURNS FOR THE WASTE COLLECTION VEHICLE WITH THE MAXIMUM GRADE CHANGE PERMITTED ALONG THE ACCESS ROUTE BEING 8%. THE COLLECTION AREA IS TO BE DESIGNED SUCH THAT IT WILL CONSIST OF A LEVEL (+/-2%) CONCRETE SURFACE.

TRAINED ON-SITE PERSONNEL MUST MANEUVER COLLECTION BINS IN FRONT OF COLLECTION VEHICLE DURING COLLECTION DAY.

TRAINED ON-SITE PERSONNEL MUST ASSIST THE COLLECTION VEHICLE IN REVERSING OUT OF THE LOADING SPACE ON COLLECTION DAY.

THE FOLLOWING MINIMUM CLEARANCES ARE TO BE PROVIDED FOR THE WASTE COLLECTION VEHICLE:

- IN THE COLLECTION AREA AN OVERHEAD CLEARANCE OF 7.5 METRES FROM OBSTRUCTIONS
- SUCH AS BALCONIES, WIRES AND TREES MUST BE PROVIDED.
- OUTSIDE OF THE COLLECTION AREA AN OVERHEAD CLEARANCE OF 4.4 METRES FROM OBSTRUCTIONS SUCH AS BALCONIES, WIRES AND TREES MUST BE PROVIDED.

### PROPERTY MANAGEMENT STAFF TO FACILITATE WASTE COLLECTION

- I. DRIVER IS NOT REQUIRED TO EXIT THE WASTE COLLECTION VEHICLE TO FACILITATE COLLECTION;
- II. PROPERTY MANAGEMENT STAFF IS RESPONSIBLE FOR JOCKEYING OF FRONT-END BINS DURING COLLECTION;
- III. THE REGION WILL NOT BE RESPONSIBLE FOR EMPTYING BINS THAT ARE INACCESSIBLE TO THE WASTE COLLECTION VEHICLE; AND
- IV. PROPERTY MANAGEMENT STAFF MUST BE VISIBLE TO WASTE COLLECTION VEHICLE ON APPROACH TO THE SITE, OTHERWISE THE WASTE COLLECTION VEHICLE WILL NOT ENTER THE SITE.

## RESIDENTIAL WASTE MANAGEMENT CALCULATIONS:

### BUILDING 4 WASTE STORAGE ROOM SIZE AND NUMBER OF BINS REQUIRED:

NUMBER OF UNITS = 824

12 SOLID WASTE BINS (4 CU YD) REQUIRED FOR 744 UNITS  
10 m<sup>2</sup> FOR FIRST BIN AND 66 m<sup>2</sup> FOR 11 BINS @ 6 m<sup>2</sup> /BIN

10 m<sup>2</sup> FOR BULKY ITEMS

14 RECYCLABLE MATERIALS BIN (4 CU YD) REQUIRED FOR 744 UNITS  
84 m<sup>2</sup> FOR 6 BINS @ 6 m<sup>2</sup> /BIN

**TOTAL SOLID WASTE STORAGE ROOM REQUIRED:**  
170 m<sup>2</sup>

**SOLID WASTE MANAGEMENT AREA PROVIDED :**  
160 m<sup>2</sup>

### BUILDING 5 WASTE STORAGE ROOM SIZE AND NUMBER OF BINS REQUIRED:

NUMBER OF UNITS = 714

10 SOLID WASTE BINS (4 CU YD) REQUIRED FOR 628 UNITS  
10 m<sup>2</sup> FOR FIRST BIN AND 54 m<sup>2</sup> FOR 8 BINS @ 6 m<sup>2</sup> /BIN

10 m<sup>2</sup> FOR BULKY ITEMS

12 RECYCLABLE MATERIALS BIN (4 CU YD) REQUIRED FOR 628 UNITS  
72 m<sup>2</sup> FOR 11 BINS @ 6 m<sup>2</sup> /BIN

**TOTAL SOLID WASTE STORAGE ROOM REQUIRED:**  
146 m<sup>2</sup>

**SOLID WASTE MANAGEMENT AREA PROVIDED :**  
137 m<sup>2</sup>

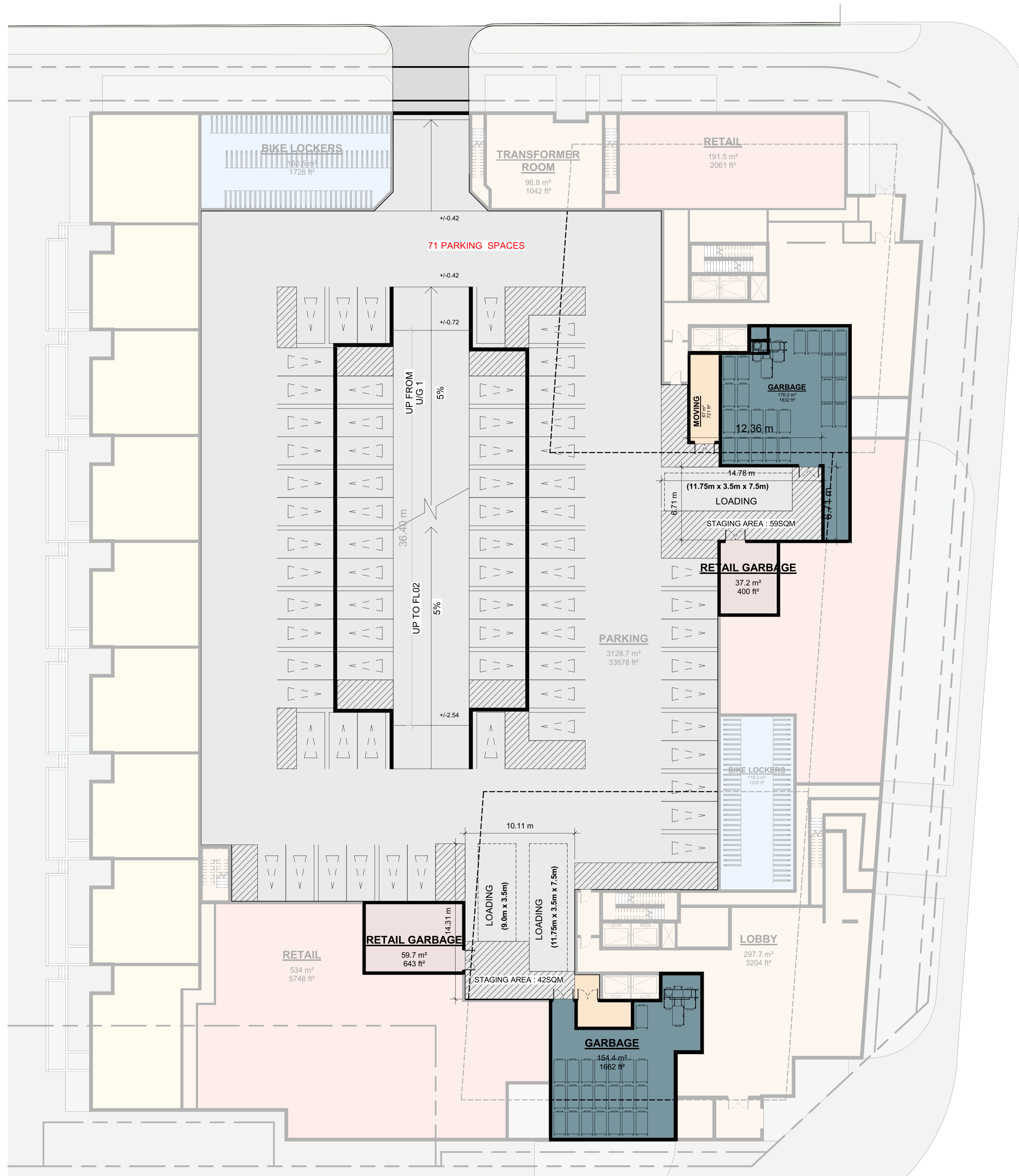

| # | DATE | DESCRIPTION | BY |
|---|------|-------------|----|
|---|------|-------------|----|

PROJECT  
**325 Burnhamthorpe Rd W**

325 Burnhamthorpe Rd W  
Mississauga, ON  
L5B 3R2

DRAWING  
**RESIDENTIAL SOLID WASTE  
MANAGEMENT - PHASE 2**

PROJECT NO.  
20-107CS  
PROJECT DATE  
FEB 2021  
DRAWN BY  
Author  
CHECKED BY  
Checker  
SCALE  
1 : 200

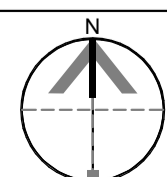

DRAWING NO. SPA012 REV.