

CONTRACTOR SHALL CHECK AND VERIFY ALL DIMENSIONS ON SITE. ALL DRAWINGS ARE THE PROPERTY OF THE ARCHITECT AND MAY NOT BE USED WITHOUT HIS PERMISSION. THIS DRAWING IS NOT TO BE USED FOR CONSTRUCTION UNLESS COUNTERSIGNED BY THE ARCHITECT. DRAWINGS ARE NOT TO BE SCALED.

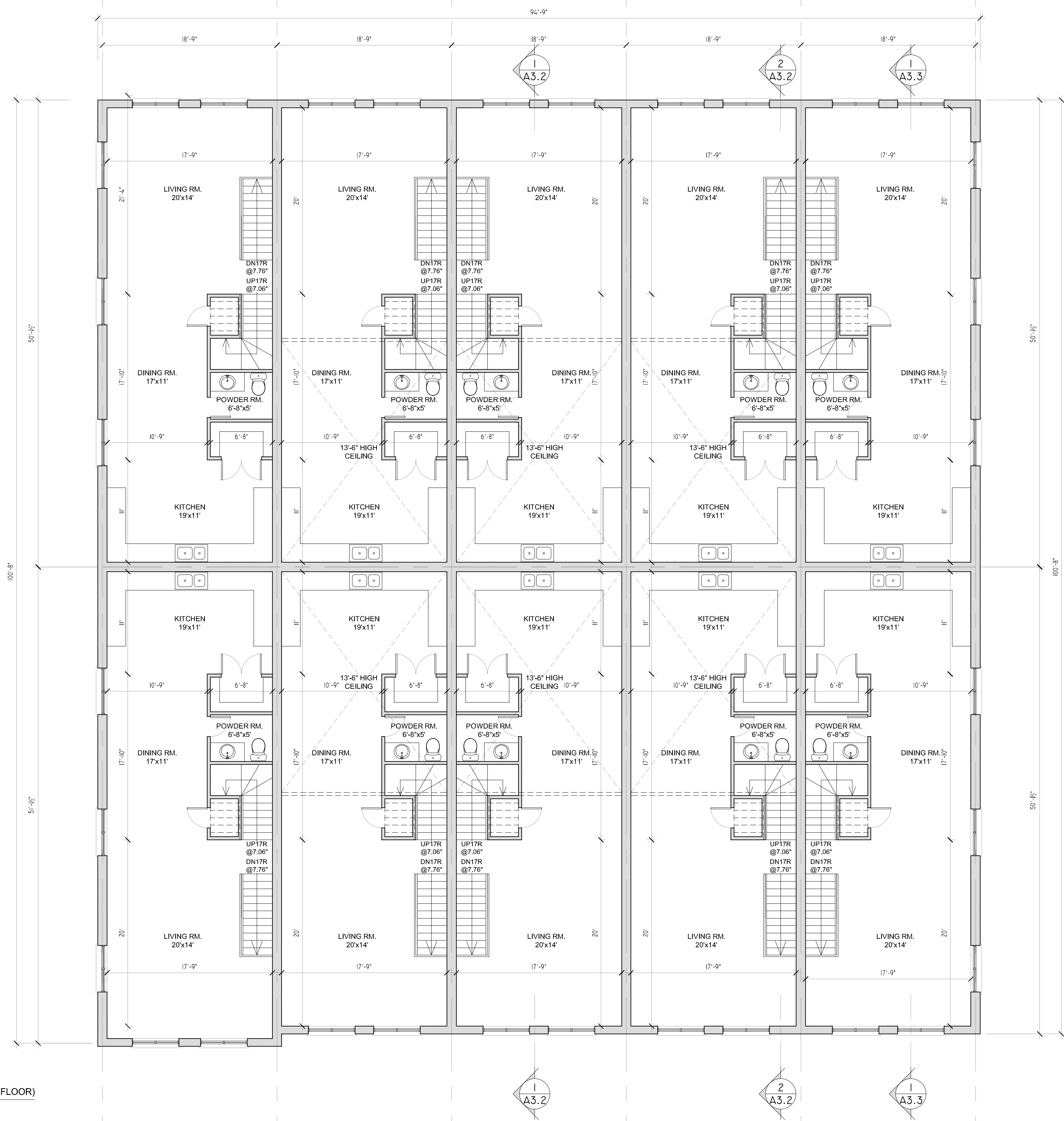

1 MAIN FLOOR (SECOND FLOOR)
A2.1 SCALE: 3/16" = 1'-0"

OWNER:
REXTON DEVELOPMENTS LTD.
4101 STEELES AVE. #201
TORONTO, ON M3N 1V7
SITE PLAN APPLICATION NUMBER: OZ 20 11
& SP 22-122 W11

NO.	DATE	REVISION /ISSUED FOR	BY
4.	FEB 27/24	SITE PLAN APPROVAL COMMENTS	
3.	JULY 5/21	SITE PLAN APPROVAL COMMENTS	
2.	JUN. 5/20	SITE PLAN SUBMISSION	
1.	AUG. 23/19	CONCEPTUAL DRAWINGS	

PROJECT NAME
**PROPOSED
RESIDENTIAL DEVELOPMENT
86 THOMAS ST.
MISSISSAUGA, ON**

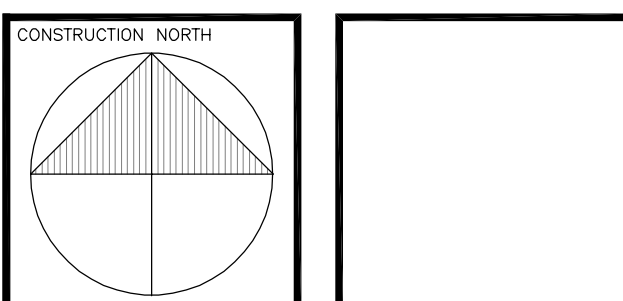

WES SURDYKA
architect inc

3645 KEELE STREET, 2nd FLOOR, STE 108
TORONTO, ONTARIO M3J 1M8
TEL (416) 630-2254 FAX (416) 630-5741
E-mail: surdykaarchitect@bellnet.ca

DRAWING TITLE
**MAIN FLOOR PLAN
(SECOND FLOOR)**

DRAWN BY	DRAWING NO.
PLOTTED FEB 22, 2024	A2.1
SCALE AS SHOWN	OF
DATE AUG. 20, 2019	
PROJECT NO.	
18-12	