

PRE-DEVELOPMENT DRAINAGE PLAN

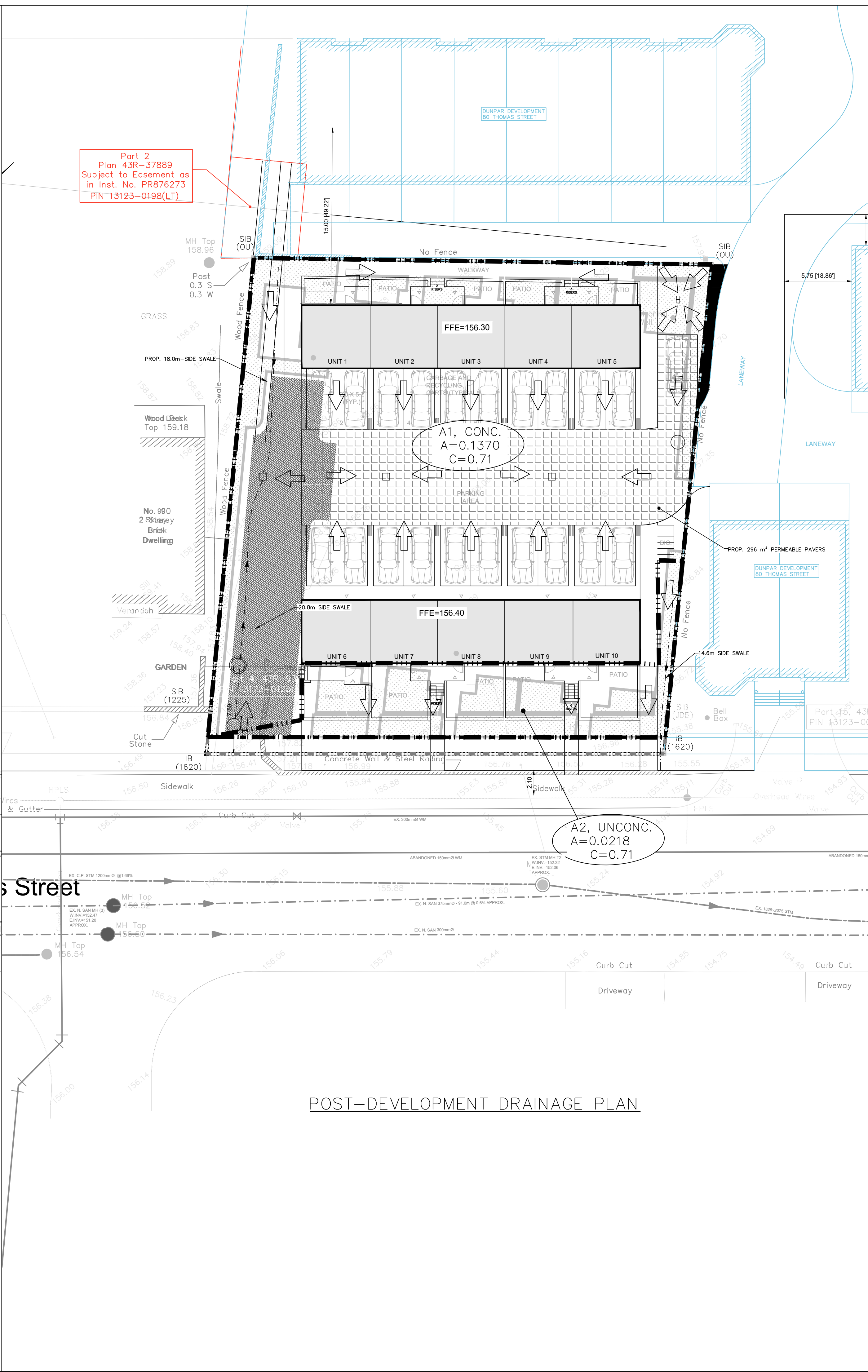

POST-DEVELOPMENT DRAINAGE PLAN

**KEY PLAN**

DISTANCES SHOWN ON THIS PLAN ARE IN METRES AND CAN BE CONVERTED TO FEET BY DIVIDING BY 0.3048. THE POSITION OF POLE LINES, CONDUITS, WATERMANS, SEWERS AND OTHER UNDERGROUND AND OVERGROUND UTILITIES AND STRUCTURES IS NOT NECESSARILY SHOWN ON THE CONTRACT DRAWINGS, AND WHERE SHOWN, THE ACCURACY OF THE POSITION OF SUCH UTILITIES AND STRUCTURES IS NOT GUARANTEED BEFORE STARTING WORK. THE CONTRACTOR SHALL INFORM HIMSELF OF THE EXACT LOCATION OF ALL SUCH UTILITIES AND STRUCTURES, AND SHALL ASSUME ALL LIABILITY FOR DAMAGE TO THEM.

**LEGEND**

- PROPERTY LINE
- - - EXISTING DRAINAGE BOUNDARY
- PROPOSED DRAINAGE BOUNDARY
- EXISTING FLOW ROUTE
- PROPOSED FLOW ROUTE
- DUNPAR DEVELOPMENT
- EASEMENT

| Revision | Date                       | By           | App'd     |
|----------|----------------------------|--------------|-----------|
| 3        | SUBMISSION FOR ZBA         | FEB. 28 2024 | W.L. G.R. |
| 2        | SUBMISSION FOR SP APPROVAL | AUG. 16 2021 | W.L. G.R. |
| 1        | SUBMISSION FOR REVIEW      | JULY 02 2020 | W.L. G.R. |

**BENCHMARK**

BEARINGS ARE ASTRONOMIC AND ARE REFERRED TO THE NORTHERLY LIMIT OF THOMAS STREET, AS SHOWN ON DEPOSITED PLAN 42R-28302, HAVING A BEARING OF N 30° 41' 00" E.

ELEVATIONS ARE REFERENCED TO CITY OF MISSISSAUGA BENCHMARK No. 1069, PUBLISHED AS HAVING AN ELEVATION OF 157.50 METERS (CANADIAN GEODETIC DATUM, 1928). #1069 SET HORIZONTALLY AT THE BASE OF A 750mm CONCRETE TRAFFIC POLE AT THE NORTH-WEST CORNER OF THOMAS STREET AND GAFNEY DRIVE.

CONSULTANT: G. RAMNATH 180322846 PROVINCE OF ONTARIO

ACCEPTED CITY OF MISSISSAUGA

SIGNATURE: DATE

**MISSISSAUGA nextrans CONSULTING ENGINEERS**

Proposed 10 Units Townhouse  
86 THOMAS STREET  
PRE-DEVELOPMENT DRAINAGE PLAN & POST-DEVELOPMENT DRAINAGE PLAN

|                   |                     |                       |
|-------------------|---------------------|-----------------------|
| Surveyed by: W.L. | Checked by: G.R.    | Project No. NT-19-013 |
| Drawn by: W.L.    | Approved by: G.R.   | Drawing No. DAP-01    |
| Designed by: W.L. | Date: JUNE 04, 2019 | Sheet No. 4 OF 5      |

Scale: 1:200  
Mississauga ZBA No.: 02 20-11  
Region File No.: C600401