

COSTS OF ANY/ALL WORKS WITHIN THE MUNICIPAL RIGHT OF WAY ARE TO BE BORNE BY THE OWNER OF THE SITE.

CROSSING INFORMATION

- EX. WM INV.=154.00, PROP. SAN OBV.=151.73
- EX. STM INV.=152.72, PROP. SAN OBV.=151.62
- EX. WM INV.=154.00, PROP. STM OBV.=153.50

Part 2
Plan 43R-37889
Subject to Easement as
in Inst. No. PR876273
PIN 13123-0198(LT)

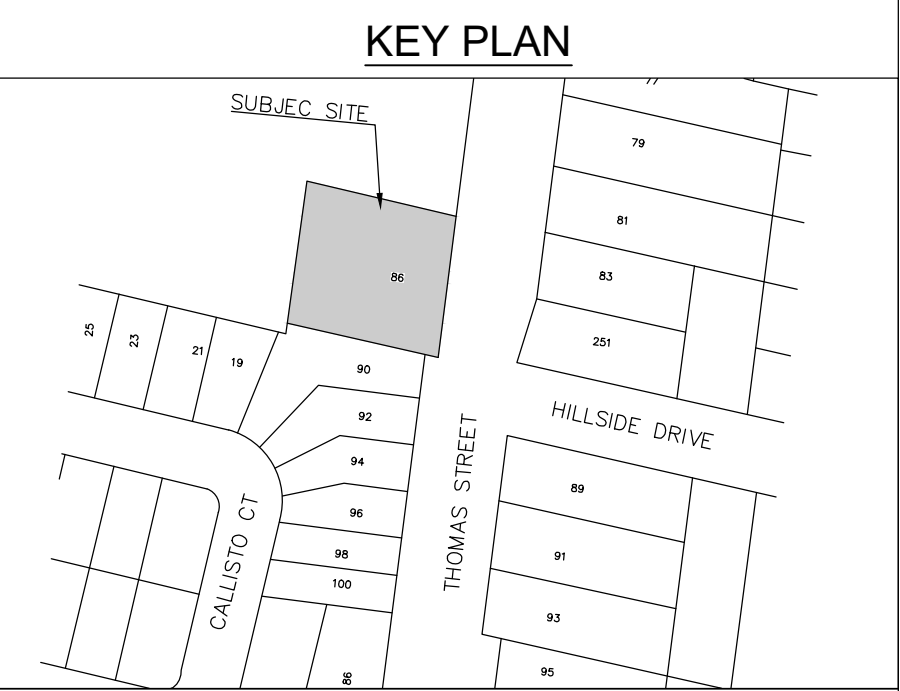

DISTANCES SHOWN ON THIS PLAN ARE IN METRES AND CAN BE CONVERTED TO FEET BY DIVIDING BY 0.3048. THE POSITION OF POLE LINES, CONDUITS, WATERMANS, SEWERS AND OTHER UNDERGROUND AND OVERGROUND UTILITIES AND STRUCTURES IS NOT NECESSARILY SHOWN ON THE CONTRACT DRAWINGS, AND WHERE SHOWN, THE ACCURACY OF THE POSITION OF SUCH UTILITIES AND STRUCTURES IS NOT GUARANTEED BEFORE STARTING WORK. THE CONTRACTOR SHALL INFORM HIMSELF OF THE EXACT LOCATION OF ALL SUCH UTILITIES AND STRUCTURES, AND SHALL ASSUME ALL LIABILITY FOR DAMAGE TO THEM.

LEGEND

- WM PROPOSED WATERMAIN
- WM EXISTING WATERMAIN
- SAN PROPOSED SANITARY SEWER
- SAN EXISTING SANITARY SEWER
- STM PROPOSED STORM SEWER
- STM EXISTING STORM SEWER
- PROPOSED ROOF DRAIN PIPE
- EXISTING HYDRANT AND VALVE
- EXISTING VALVE CHAMBER
- MH EXISTING STORM MH
- MH EXISTING SANITARY MH
- STM MH PROPOSED STORM MH
- SAN MH PROPOSED SANITARY MH
- STM CBMH PROPOSED STORM CATCHBASIN MH
- CB EXISTING CATCHBASIN SINGLE
- CB PROPOSED CATCHBASIN
- PROPERTY LINE
- PROPOSED AREA DRAIN
- PROPOSED DOWNSPOUT
- PROPOSED PERMEABLE PAVERS
- EXISTING RETAINING WALL
- CONSTRUCTION AREA
- DUNPAR DEVELOPMENT
- EASEMENT

Revision	Date	By	Appr'd
3	SUBMISSION FOR ZBA	FEB 28 2024	W.L. G.R.
2	SUBMISSION FOR SP APPROVAL	AUG 16 2021	W.L. G.R.
1	SUBMISSION FOR REVIEW	JULY 02 2020	W.L. G.R.

BENCHMARK
BEARINGS ARE ASTRONOMIC AND ARE REFERRED TO THE NORTHERLY LIMIT OF THOMAS STREET, AS SHOWN ON DEPOSITED PLAN 42R-28302, HAVING A BEARING OF N 30° 41' 00" E.
ELEVATIONS ARE REFERENCED TO CITY OF MISSISSAUGA BENCHMARK No. 1069, PUBLISHED AS HAVING AN ELEVATION OF 157.50 METERS (CANADIAN GEODETIC DATUM, 1928). #1069 SET HORIZONTALLY AT THE BASE OF A 750mm CONCRETE TRAFFIC POLE AT THE NORTH-WEST CORNER OF THOMAS STREET AND GAFNEY DRIVE.

CONSULTANT: G. RAMNATH 180322846, 28 Feb 24, MISSISSAUGA, ONTARIO
ACCEPTED: CITY OF MISSISSAUGA
SIGNATURE: _____ DATE: _____

MISSISSAUGA nextrans CONSULTING ENGINEERS
Suite 201, 520 Industrial Parkway South, Aurora ON L4G 6W8
Tel: 905-903-2563, Web: www.nextrans.ca

**Proposed 10 Units Townhouse
86 THOMAS STREET
SITE SERVICING PLAN**

Surveyed by: W.L.	Checked by: G.R.	Project No. NT-19-013
Designed by: W.L.	Approved by: G.R.	Drawing No. SS-01
Scale: HORIZONTAL: 1:200 VERTICAL: 1:50	Date: JUNE 04, 2019	Sheet No. 2 OF 5

Mississauga ZBA No.: 02 20-11
Region File No.: C600401

