

Building 2\_ZBA\_NorthEast Elevation Angular Plane

Every effort is made to ensure the accuracy of the drawings. However, the drawings are not to be used for any other purpose without the express written consent of the architect. The architect is not liable for any loss or damage of information resulting from a duplicate reproduction of the original drawing.

- GENERAL NOTES:**
- Drawings are to be used by the contractor and not for any other purpose. The contractor is responsible for obtaining all necessary permits and approvals from the relevant authorities.
  - The contractor is responsible for ensuring that the drawings are used in accordance with the contract documents and any applicable laws and regulations.
  - The contractor is responsible for ensuring that the drawings are used in accordance with the contract documents and any applicable laws and regulations.
  - The contractor is responsible for ensuring that the drawings are used in accordance with the contract documents and any applicable laws and regulations.
  - The contractor is responsible for ensuring that the drawings are used in accordance with the contract documents and any applicable laws and regulations.
  - The contractor is responsible for ensuring that the drawings are used in accordance with the contract documents and any applicable laws and regulations.

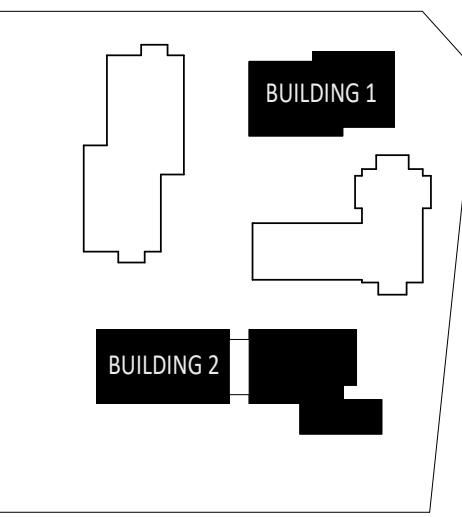

KEY PLAN



Building 1&2\_ZBA\_NorthEast Elevation

No.	Date	Issued
1	2024-04-12	Final Design
2	2024-04-12	Final Design
3	2024-04-12	Final Design
4	2024-04-12	Final Design

**KPMB Architects**  
 251 King St. E. Suite 1200  
 Toronto, ON, Canada M5A 0L6  
 416.977.5104

Application Number:  
 CG-CPA-22-018-WP

Kindred Works  
**WESTMINSTER UNITED  
 MISSISSAUGA**

4094 Tormken Rd, Mississauga, ON  
 L4W 1J5

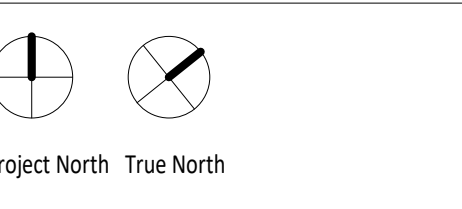

Project No. 2112  
 Scale 1:100  
 Plot Date 04/12/2024

**EAST FULL ELEVATION**