

FOR THE USE OF THE CLIENT:
 The drawings are prepared by the architect and are not to be used for any other purpose without the written consent of the architect.
 The client is responsible for the accuracy and completeness of the information provided to the architect.

- GENERAL NOTES:**
- Drawings are to be used for construction and not for any other purpose.
 - The client is responsible for the accuracy and completeness of the information provided to the architect.
 - The architect is not responsible for the accuracy and completeness of the information provided to the client.
 - The architect is not responsible for the accuracy and completeness of the information provided to the client.
 - The architect is not responsible for the accuracy and completeness of the information provided to the client.
 - The architect is not responsible for the accuracy and completeness of the information provided to the client.

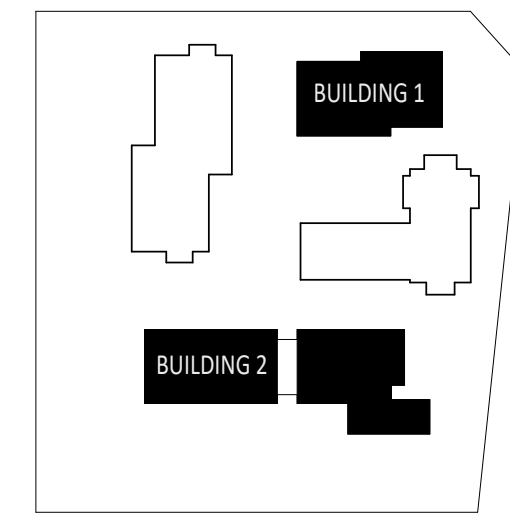

KEY PLAN

NO.	DATE	DESCRIPTION	BY	CHECKED
1	2024-04-12	ISSUE FOR PERMITTING	J. KPMB	M. WESTMINSTER
2	2024-04-12	ISSUE FOR PERMITTING	J. KPMB	M. WESTMINSTER
3	2024-04-12	ISSUE FOR PERMITTING	J. KPMB	M. WESTMINSTER

KPMB Architects
 251 King St. E., Suite 1200
 Toronto, ON, Canada M5A 0L6
 416.977.5104

Application Number:
 CG-CPA-20-218-VQ

Kindred Works
WESTMINSTER UNITED
MISSISSAUGA

4094 Torkmen Rd, Mississauga, ON
 L4W 1J5

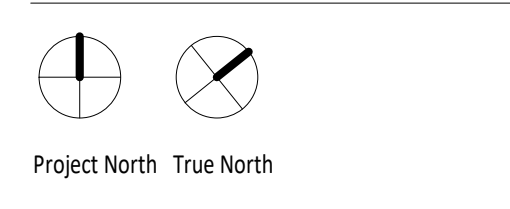

Project No. 2112
 Scale: 1:100
 Plot Date: 04/12/2024

FLOOR PLAN - GROUND LEVEL

A2.03