

Owner: [Redacted]
 Architect: [Redacted]
 Date: [Redacted]

- GENERAL NOTES:**
1. Drawings are to be used by the contractor and not for construction. Location and dimensions are to be confirmed by the contractor on site. All dimensions are to be confirmed by the contractor on site. All dimensions are to be confirmed by the contractor on site.
 2. The contractor is responsible for obtaining all necessary permits and approvals from the relevant authorities. The contractor is responsible for obtaining all necessary permits and approvals from the relevant authorities.
 3. The contractor is responsible for obtaining all necessary permits and approvals from the relevant authorities. The contractor is responsible for obtaining all necessary permits and approvals from the relevant authorities.
 4. The contractor is responsible for obtaining all necessary permits and approvals from the relevant authorities. The contractor is responsible for obtaining all necessary permits and approvals from the relevant authorities.
 5. The contractor is responsible for obtaining all necessary permits and approvals from the relevant authorities. The contractor is responsible for obtaining all necessary permits and approvals from the relevant authorities.
 6. The contractor is responsible for obtaining all necessary permits and approvals from the relevant authorities. The contractor is responsible for obtaining all necessary permits and approvals from the relevant authorities.

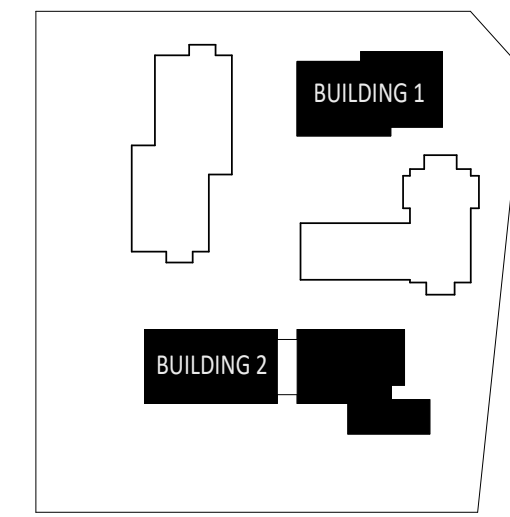

KEY PLAN

No.	Date	Issued
1	2023-08-01	Issue for Construction
2	2023-08-01	Issue for Construction
3	2023-08-01	Issue for Construction
4	2023-08-01	Issue for Construction

KPMB Architects
 251 King St. E. Suite 1200
 Toronto, ON, Canada M5A 0L6
 416-977-5104

Application Number:
 CG-CPA-22-018-193

Kindred Works
**WESTMINSTER UNITED
 MISSISSAUGA**

4094 Tormen Rd, Mississauga, ON
 L4W 1J5

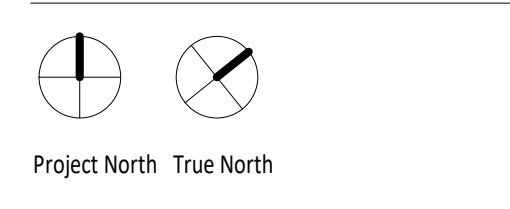

Project No. 2112
 Scale 1:100
 Plot Date 04/12/2024

FLOOR PLAN - LEVEL 2