

Owner: [Redacted]
 Architect: [Redacted]
 Date: [Redacted]

- GENERAL NOTES:**
1. Drawings are to be used by the contractor and not for construction. The contractor is responsible for verifying all dimensions and locations of existing conditions and for providing a site survey to confirm the accuracy of the drawings.
 2. The contractor is responsible for providing all necessary permits and approvals for the proposed construction.
 3. The contractor is responsible for providing all necessary materials and labor for the proposed construction.
 4. The contractor is responsible for providing all necessary safety measures during the construction process.
 5. The contractor is responsible for providing all necessary site access and parking for the construction process.
 6. These drawings are not to be used for construction unless specifically noted otherwise.

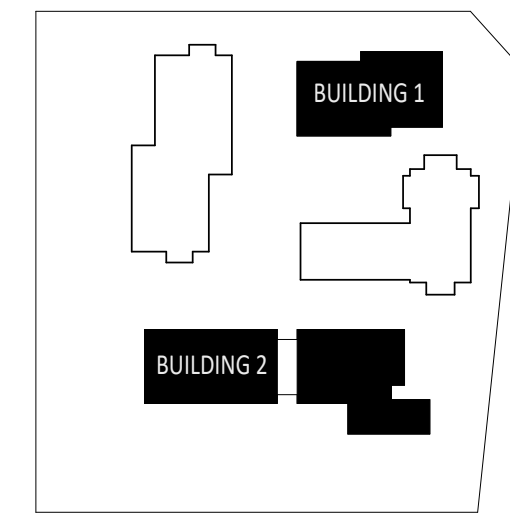

KEY PLAN

No.	Date	Issued
1	2024-04-12	Issue for Review
2	2024-04-15	Issue for Construction
3	2024-04-18	Issue for Construction

KPMB Architects
 251 King St. E., Suite 1200
 Toronto, ON, Canada M5A 0L6
 416.977.5104

Application Number:
 CG-CPA-22-018-193

Kindred Works
WESTMINSTER UNITED
MISSISSAUGA

4094 Tormken Rd, Mississauga, ON
 L4W 1J5

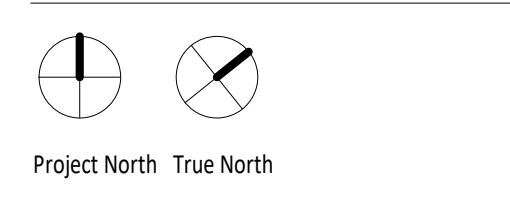

Project No. 2112
 Scale: 1:100
 Plot Date: 04/12/2024

FLOOR PLAN - LEVEL 3