

1. This drawing is for the use of the contractor and is not to be used for any other purpose without the written consent of the architect. The contractor shall be responsible for the accuracy of the information resulting from a site inspection of the original drawing.

- GENERAL NOTES:**
1. Drawings are to be used by the contractor and are not to be used for any other purpose without the written consent of the architect. The contractor shall be responsible for the accuracy of the information resulting from a site inspection of the original drawing.
 2. The contractor shall be responsible for the accuracy of the information resulting from a site inspection of the original drawing.
 3. The contractor shall be responsible for the accuracy of the information resulting from a site inspection of the original drawing.
 4. The contractor shall be responsible for the accuracy of the information resulting from a site inspection of the original drawing.
 5. The contractor shall be responsible for the accuracy of the information resulting from a site inspection of the original drawing.
 6. The contractor shall be responsible for the accuracy of the information resulting from a site inspection of the original drawing.

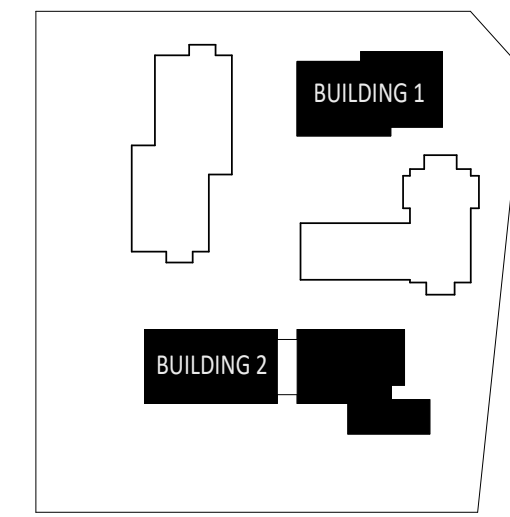

KEY PLAN

No.	Date	Issued
1	2024-04-12	Issue for Construction
2	2024-04-12	Issue for Construction
3	2024-04-12	Issue for Construction

KPMB Architects
 251 King St. E. Suite 1200
 Toronto, ON, Canada M5A 0L6
 416.977.5104

Application Number:
 CG-CPA-22-018-193

Kindred Works
**WESTMINSTER UNITED
 MISSISSAUGA**

4094 Tormken Rd, Mississauga, ON
 L4W 1J5

Project North True North

Project No. 2112
 Scale 1:100
 Plot Date 04/12/2024

FLOOR PLAN - LEVEL 4