

Copyright © 2024 by the architect. All rights reserved. This drawing is the property of the architect and is not to be reproduced, stored in a retrieval system, or transmitted in any form or by any means, electronic, mechanical, photocopying, recording, or by any information storage and retrieval system, without the prior written permission of the architect.

- GENERAL NOTES:**
1. Drawings are to be used by the contractor and not for construction. The contractor shall verify all dimensions and conditions on site before commencing work.
 2. The contractor shall be responsible for obtaining all necessary permits and approvals from the relevant authorities.
 3. The contractor shall be responsible for ensuring that all work is completed in accordance with the approved drawings and specifications.
 4. The contractor shall be responsible for ensuring that all work is completed in accordance with the approved drawings and specifications.
 5. The contractor shall be responsible for ensuring that all work is completed in accordance with the approved drawings and specifications.
 6. These drawings are not to be used for construction unless specifically approved by the architect.

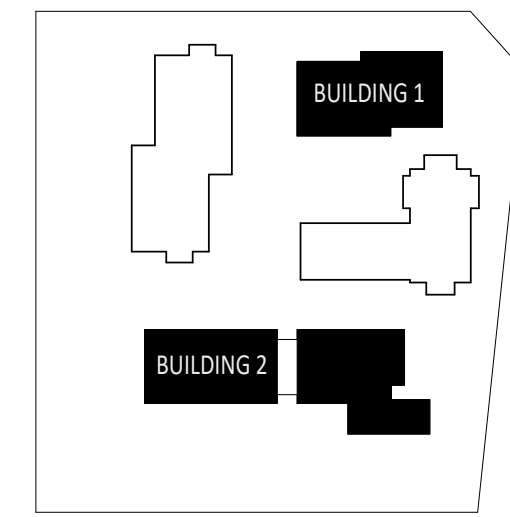

KEY PLAN

No.	Date	By	Issued For
1	2024-04-12	JACOB WILSON	CONCEPT DESIGN
2	2024-04-12	JACOB WILSON	SCHEMATIC DESIGN
3	2024-04-12	JACOB WILSON	PRELIMINARY DESIGN
4	2024-04-12	JACOB WILSON	FINAL DESIGN

KPMB Architects
 251 King St. E. Suite 1200
 Toronto, ON, Canada M5A 0L6
 416.977.5104

Application Number:
 CG-CPA-22-018-193

Kindred Works
WESTMINSTER UNITED
MISSISSAUGA

4094 Tormken Rd, Mississauga, ON
 L4W 1J5

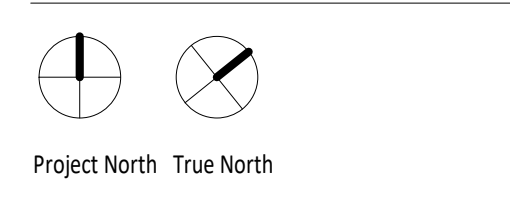

Project No. 2112
 Scale 1:100
 Plot Date 04/12/2024

FLOOR PLAN - LEVEL 9