

Every effort is made to ensure the accuracy of the drawings, but the user is advised to verify the accuracy of the drawings by field inspection. The user is responsible for any errors or omissions in the drawings. The user is responsible for any errors or omissions in the drawings.

- GENERAL NOTES:**
- Drawings are to be used by the contractor and not for construction. The contractor is responsible for any errors or omissions in the drawings.
  - The contractor is responsible for any errors or omissions in the drawings.
  - The contractor is responsible for any errors or omissions in the drawings.
  - The contractor is responsible for any errors or omissions in the drawings.
  - The contractor is responsible for any errors or omissions in the drawings.
  - The contractor is responsible for any errors or omissions in the drawings.

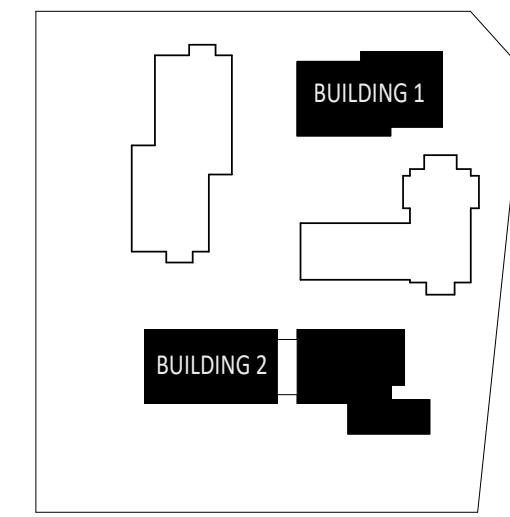

KEY PLAN

No.	Date	By	Check
1	2024-04-12	J. K. KILGUS	J. K. KILGUS
2	2024-04-12	J. K. KILGUS	J. K. KILGUS
3	2024-04-12	J. K. KILGUS	J. K. KILGUS
4	2024-04-12	J. K. KILGUS	J. K. KILGUS

**KPMB Architects**  
 251 King St. E. Suite 1200  
 Toronto, ON, Canada M5A 0L6  
 416.977.5104

Application Number:  
 CG-CPA-22-018 WQ

Kindred Works  
**WESTMINSTER UNITED**  
**MISSISSAUGA**

4094 Tormken Rd, Mississauga, ON  
 L4W 1J5

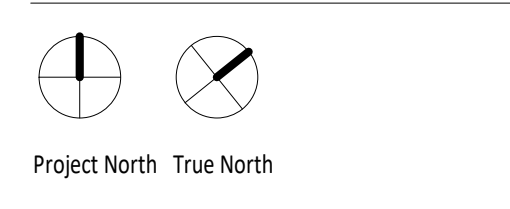

Project No. 2112  
 Scale 1:100  
 Plot Date 04/12/2024

**FLOOR PLAN - LEVEL 10**