

Copyright © 2024 of the architect. All rights reserved. This drawing is the property of the architect and is not to be reproduced, stored in a retrieval system, or transmitted in any form or by any means, electronic, mechanical, photocopying, recording, or by any information storage and retrieval system, without the prior written permission of the architect.

- GENERAL NOTES:**
- Drawings are to be used by the contractor and not for construction. The contractor is responsible for verifying the accuracy of the drawings and for obtaining all necessary permits and approvals from the appropriate authorities.
  - The contractor shall be responsible for obtaining all necessary permits and approvals from the appropriate authorities.
  - The contractor shall be responsible for obtaining all necessary permits and approvals from the appropriate authorities.
  - The contractor shall be responsible for obtaining all necessary permits and approvals from the appropriate authorities.
  - The contractor shall be responsible for obtaining all necessary permits and approvals from the appropriate authorities.
  - The contractor shall be responsible for obtaining all necessary permits and approvals from the appropriate authorities.

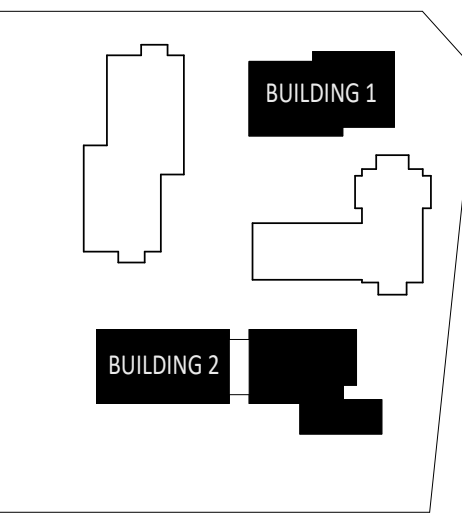

KEY PLAN

No.	Date	Issued
1	2024-04-01	Final Design
2	2024-04-01	Final Design
3	2024-04-01	Final Design
4	2024-04-01	Final Design

**KPMB Architects**  
 251 King St. E. Suite 1200  
 Toronto, ON, Canada M5A 0L6  
 416.977.5104

Application Number:  
 CG-CPA-22-128-193

Kindred Works  
**WESTMINSTER UNITED**  
**MISSISSAUGA**

4094 Tormken Rd, Mississauga, ON  
 L4W 1J5

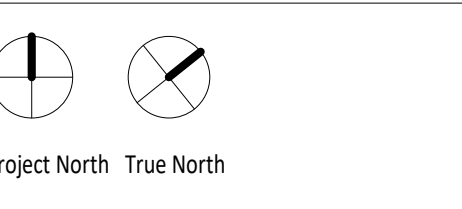

Project No. 2112  
 Scale 1:100  
 Plot Date 04/12/2024

**FLOOR PLAN - LEVEL 11**