

Drawings are the property of the architect. All rights reserved. No part of this drawing may be reproduced, stored in a retrieval system, or transmitted in any form or by any means, electronic, mechanical, photocopying, recording, or by any information storage and retrieval system, without the prior written permission of the architect.

- GENERAL NOTES:**
1. Drawings are to be used by the contractor and not for construction. The contractor shall verify all existing conditions and dimensions prior to construction. The contractor shall be responsible for any discrepancies between the drawings and the actual conditions.
 2. The contractor shall be responsible for obtaining all necessary permits and approvals from the relevant authorities.
 3. The contractor shall be responsible for coordinating with all other trades and subcontractors to ensure a smooth and timely construction process.
 4. The contractor shall be responsible for maintaining the site and ensuring that it remains safe and secure at all times.
 5. The contractor shall be responsible for the quality and workmanship of all work, materials and labor.
 6. The contractor shall be responsible for the safety of all workers and the public at all times.
 7. The contractor shall be responsible for the protection of all existing structures and utilities.
 8. The contractor shall be responsible for the disposal of all waste and debris.
 9. The contractor shall be responsible for the completion of all work within the specified time frame.
 10. The contractor shall be responsible for the final inspection and handover of the project.

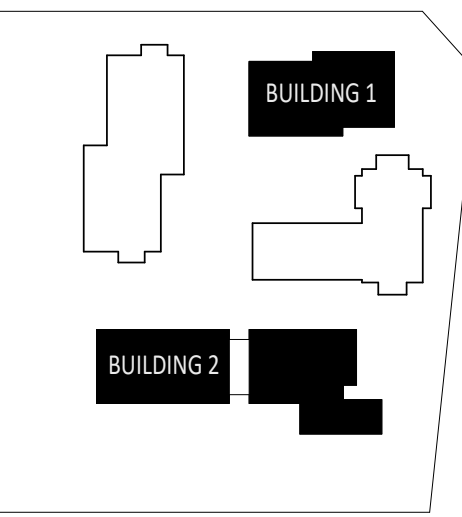

KEY PLAN

No.	Date	Issued For	By
1	2024-04-12	Final Design	J. Smith
2	2024-04-15	Construction	J. Smith
3	2024-04-18	As-Built	J. Smith
4	2024-04-20	Final	J. Smith

KPMB Architects
 251 King St. E., Suite 1200
 Toronto, ON, Canada M5A 0L6
 416.977.5104

Application Number:
 CG-CPA-22-128 W3

Kindred Works
WESTMINSTER UNITED
MISSISSAUGA

4094 Tormken Rd, Mississauga, ON
 L4W 1J5

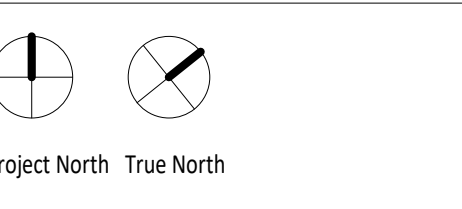

Project No. 2112
 Scale 1:100
 Plot Date 04/12/2024

FLOOR PLAN - LEVEL 12