



IMAGE 4 - SOUTH TOMKEN ROAD



IMAGE 2 - BUILDING 2 FROM COURTYARD



IMAGE 3 - AXO FACING SOUTH WEST



IMAGE 1 - NORTH ENTRY BUILDING 1

Copyright © 2024 by the architect.
 All rights reserved. No part of this drawing may be reproduced by any means, in any form, without the prior written permission of the architect.
 The architect is not liable for any loss or damage of information resulting from a computer reproduction of the original drawing.

- GENERAL NOTES:**
1. Drawings are to be used by the client. Contractors will verify all existing conditions and dimensions prior to performing the work and will report any discrepancies to the architect immediately.
 2. The architect is not responsible for the accuracy of the information provided by the client. The architect is not responsible for the accuracy of the information provided by the client.
 3. The architect is not responsible for the accuracy of the information provided by the client.
 4. The architect is not responsible for the accuracy of the information provided by the client.
 5. The architect is not responsible for the accuracy of the information provided by the client.
 6. These documents are not to be used for construction unless specifically noted by the architect.

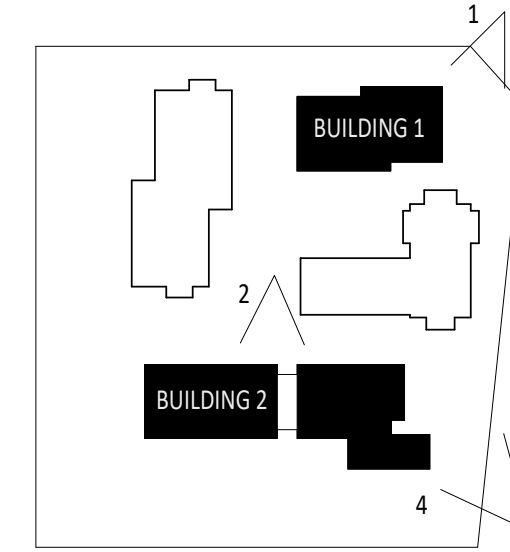

KEY PLAN

No.	Date	Revised
1	2024-04-12	Initial Release
2	2024-04-12	Final Release
3	2024-04-12	Final Release
4	2024-04-12	Final Release

KPMB Architects
 251 King St. E. Suite 1200
 Toronto, ON, Canada M5A 0L6
 416.977.5104

Application Number:
 CG-COPA-22-028 MK2

Kindred Works
**WESTMINSTER UNITED
 MISSISSAUGA**

4094 Tomken Rd, Mississauga, ON
 L4W 1J5

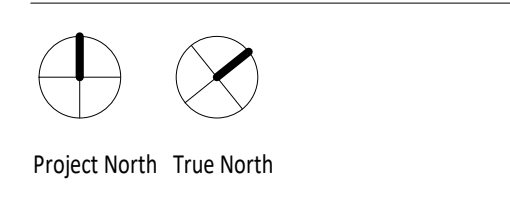

Project No. 2112
 Scale:
 Plot Date 04/12/2024

RENDERINGS