

Every effort is made to ensure the accuracy of the drawings produced by the means from any notes, other than as specifically noted on the drawings to be made. Information is not to be taken as a basis for any action or interpretation of information resulting from a subsequent reproduction of the original drawing.

- GENERAL NOTES:**
1. Drawings are to be used by the contractor and not for any other purpose. The contractor is responsible for obtaining all necessary permits and approvals from the appropriate authorities.
 2. The contractor is responsible for obtaining all necessary permits and approvals from the appropriate authorities.
 3. The contractor is responsible for obtaining all necessary permits and approvals from the appropriate authorities.
 4. The contractor is responsible for obtaining all necessary permits and approvals from the appropriate authorities.
 5. The contractor is responsible for obtaining all necessary permits and approvals from the appropriate authorities.
 6. These drawings are not to be used for construction unless specifically noted on the drawings.

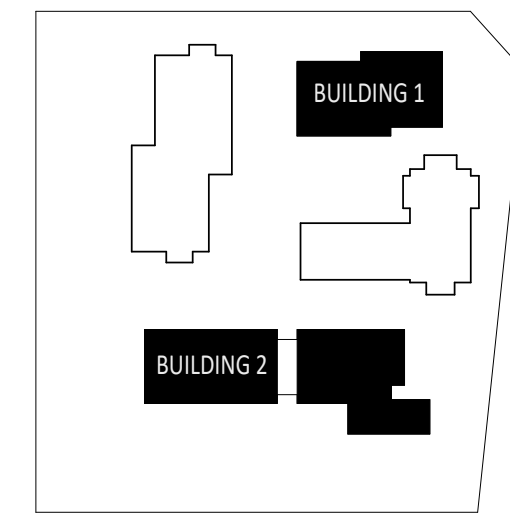

KEY PLAN



No.	Date	Issued For	Issued By
1	2024-04-12	FOR PERMITS	J. KPMB
2	2024-04-12	FOR PERMITS	J. KPMB
3	2024-04-12	FOR PERMITS	J. KPMB
4	2024-04-12	FOR PERMITS	J. KPMB

KPMB Architects
 251 King St. E., Suite 1200
 Toronto, ON, Canada M5A 0L6
 416.977.5104

Application Number:
 CG-CPA-22-018-WF

Kindred Works
**WESTMINSTER UNITED
 MISSISSAUGA**

4094 Torken Rd, Mississauga, ON
 L4W 1J5

Project No. 2112
 Scale 1:100
 Plot Date 04/12/2024

WEST FULL ELEVATION