

Copyright © 2024 by the architect. All rights reserved. No part of this drawing may be reproduced, stored in a retrieval system, or transmitted in any form or by any means, electronic, mechanical, photocopying, recording, or by any information storage and retrieval system, without the prior written permission of the architect.

- GENERAL NOTES:**
1. Drawings are to be used by the contractor and not for any other purpose. The contractor is responsible for obtaining all necessary permits and approvals from the appropriate authorities.
 2. The contractor shall be responsible for obtaining all necessary permits and approvals from the appropriate authorities.
 3. The contractor shall be responsible for obtaining all necessary permits and approvals from the appropriate authorities.
 4. The contractor shall be responsible for obtaining all necessary permits and approvals from the appropriate authorities.
 5. The contractor shall be responsible for obtaining all necessary permits and approvals from the appropriate authorities.
 6. These documents are not to be used for construction unless specifically noted for such purposes.

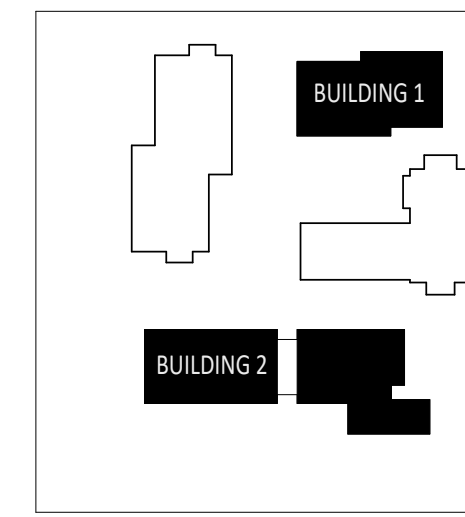

KEY PLAN



No.	Date	Issued For
1	2024-04-12	Final Design
2	2024-04-12	Final Design
3	2024-04-12	Final Design
4	2024-04-12	Final Design

KPMB Architects
 251 King St. E. Suite 1200
 Toronto, ON, Canada M5A 0L6
 416.977.5104

Application Number:
 CG-CPPA-22-028-WG

Kindred Works
WESTMINSTER UNITED
MISSISSAUGA

4094 Torkmen Rd, Mississauga, ON
 L4W 1J5

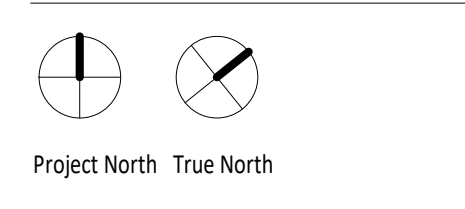

Project No. 2112
 Scale 1:100
 Plot Date 04/12/2024

BUILDING 1 - NORTH
ELEVATION