

Copyright © 2024 of the architect. All rights reserved. No part of this drawing may be reproduced by any means without the prior written consent of the architect. The architect is not liable for any loss or damage of information resulting from a duplicate reproduction of the original drawing.

- GENERAL NOTES:**
1. Drawings are to be used by the contractor and not for construction. Location and dimensions are to be confirmed by the contractor and not by the architect.
 2. The contractor is responsible for obtaining all necessary permits and approvals from the relevant authorities. The architect is not responsible for any delays or costs incurred by the contractor in obtaining such permits and approvals.
 3. The contractor is responsible for ensuring that the work is completed in accordance with the drawings and specifications. The architect is not responsible for any delays or costs incurred by the contractor in completing the work.
 4. The contractor is responsible for ensuring that the work is completed in accordance with the drawings and specifications. The architect is not responsible for any delays or costs incurred by the contractor in completing the work.
 5. The contractor is responsible for ensuring that the work is completed in accordance with the drawings and specifications. The architect is not responsible for any delays or costs incurred by the contractor in completing the work.
 6. These drawings are not to be used for construction unless specifically approved by the architect.

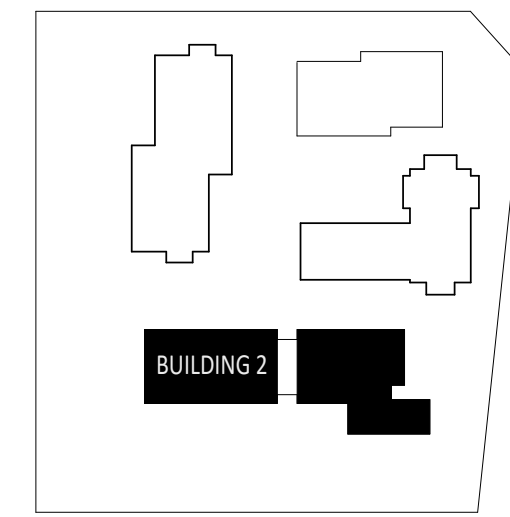

KEY PLAN

No.	Date	By	Check
1	2024-04-12	JACOB KILBINGER	JACOB KILBINGER
2	2024-04-12	JACOB KILBINGER	JACOB KILBINGER
3	2024-04-12	JACOB KILBINGER	JACOB KILBINGER
4	2024-04-12	JACOB KILBINGER	JACOB KILBINGER

KPMB Architects
 251 King St. E. Suite 1200
 Toronto, ON, Canada M5A 0L6
 416.977.5104

Application Number:
 CG-CPA-22-028-WQ

Kindred Works
**WESTMINSTER UNITED
 MISSISSAUGA**

4094 Tormken Rd, Mississauga, ON
 L4W 1J5

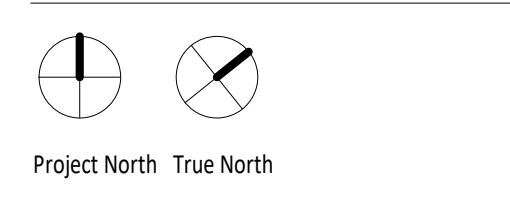

Project No. 2112
 Scale 1:100
 Plot Date 04/12/2024

**BUILDING 2 - NORTH
 ELEVATION**