

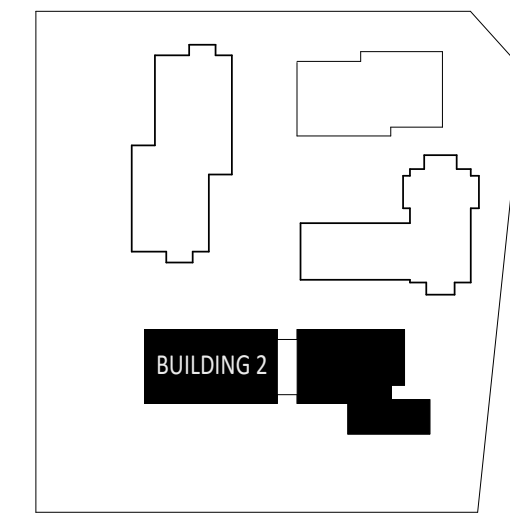

Copyright © 2024 by the author.
 All rights reserved. No part of this publication may be reproduced, stored in a retrieval system, or transmitted, in any form or by any means, electronic, mechanical, photocopying, recording, or by any information storage and retrieval system, without the prior written permission of the author.

- GENERAL NOTES:**
1. Drawings are to be used by the Contractor and not for any other purpose. The Contractor shall be responsible for any errors or omissions in the drawings and shall be liable for any loss or damage of information resulting from an incorrect reproduction of the original drawing.
 2. The Contractor shall be responsible for any errors or omissions in the drawings and shall be liable for any loss or damage of information resulting from an incorrect reproduction of the original drawing.
 3. The Contractor shall be responsible for any errors or omissions in the drawings and shall be liable for any loss or damage of information resulting from an incorrect reproduction of the original drawing.
 4. The Contractor shall be responsible for any errors or omissions in the drawings and shall be liable for any loss or damage of information resulting from an incorrect reproduction of the original drawing.
 5. The Contractor shall be responsible for any errors or omissions in the drawings and shall be liable for any loss or damage of information resulting from an incorrect reproduction of the original drawing.
 6. These drawings are not to be used for construction unless specifically noted to the contrary.



KEY PLAN

No.	Date	Issued For	By
1	2024-08-12	Issue for Construction	J. Smith
2	2024-08-12	Issue for Construction	J. Smith
3	2024-08-12	Issue for Construction	J. Smith
4	2024-08-12	Issue for Construction	J. Smith

KPMB Architects
 251 King St. E. Suite 1200
 Toronto, ON, Canada M5A 0L6
 416.977.5104

Application Number:
 CG-CPA-22-018-WF

Kindred Works
**WESTMINSTER UNITED
 MISSISSAUGA**

4094 Tormken Rd, Mississauga, ON
 L4W 1J5

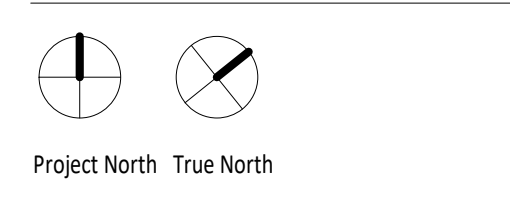

Project No. 2112
 Scale 1:100
 Plot Date 04/12/2024

**BUILDING 2 SECTION -
 LONGITUDINAL**