

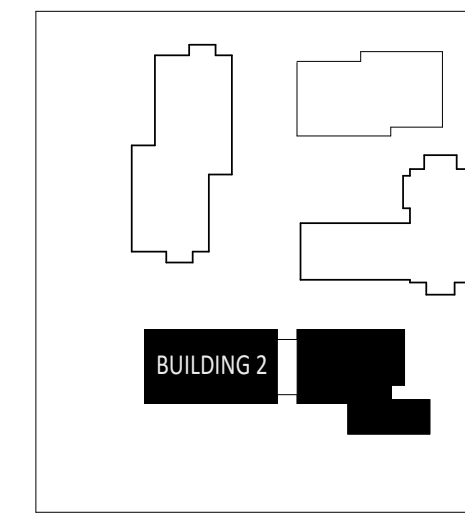

Building_2_ZBA_SouthEast Elevation Angular Plane

Copyright © 2024 of the architect. All rights reserved. This drawing is the property of the architect and is not to be reproduced, stored in a retrieval system, or transmitted in any form or by any means, electronic, mechanical, photocopying, recording, or by any information storage and retrieval system, without the prior written permission of the architect.

- GENERAL NOTES:**
1. This drawing is for the architect's use only. It is not to be used for construction or for any other purpose without the prior written permission of the architect.
 2. The architect is not responsible for any errors or omissions in this drawing or for any consequences arising therefrom.
 3. The architect is not responsible for any errors or omissions in any other drawings or documents prepared by other professionals in connection with this project.
 4. The architect is not responsible for any errors or omissions in any other drawings or documents prepared by other professionals in connection with this project.
 5. The architect is not responsible for any errors or omissions in any other drawings or documents prepared by other professionals in connection with this project.
 6. These documents are not to be used for construction unless specifically noted to the contrary.



KEY PLAN



No.	Date	Issued
1	2024-04-12	Issue for Review
2	2024-04-12	Issue for Review
3	2024-04-12	Issue for Review

KPMB Architects
 351 King St. E. Suite 1200
 Toronto, ON, Canada M5A 0L6
 416.977.5104

Application Number:
 CG-CPA-22-218-193

Kindred Works
**WESTMINSTER UNITED
 MISSISSAUGA**

4094 Tormken Rd, Mississauga, ON
 L4W 1J5

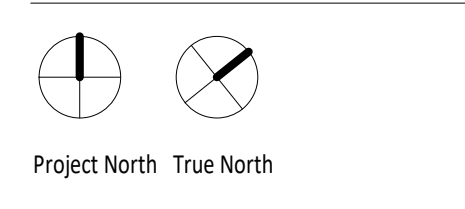

Project No. 2112
 Scale: 1:100
 Plot Date: 04/12/2024

**BUILDING 2 - SOUTH
 ELEVATION**