



TRAIL DAMAGE DUE TO DRAINAGE FROM BRIDGE ABUTMENT

WASHED OUT GRANULAR SURFACE TRAIL

EXISTING TURTLE HABITAT GROUNDS

WASHED OUT GRANULAR SURFACE TRAIL

TRAIL ALTERNATIVES AS PART OF CREDIT HEIGHTS DRIVE BANK EROSION SITE

EXISTING BRIDGE

EXISTING PAVED TRAIL, TRAIL ALTERNATIVES AS PART OF ASHINGTON COURT BANK EROSION SITE

GRANULAR TRAIL PRONE TO WASHOUT ADJACENT TO TURTLE HABITAT



1	R.A.	12/04/2023	ISSUED FOR REVIEW	
NO.	BY	DDMMYY	REVISIONS	CHECKED

LEGEND

	PROPERTY/BUILDING LINE
	WATERCOURSE
	EXISTING TRAIL
	EXISTING CONTOUR
	SANITARY SEWER
	STORM SEWER
	WATERMAIN
	2 YEAR FLOODLINE - EXISTING
	5 YEAR FLOODLINE - EXISTING

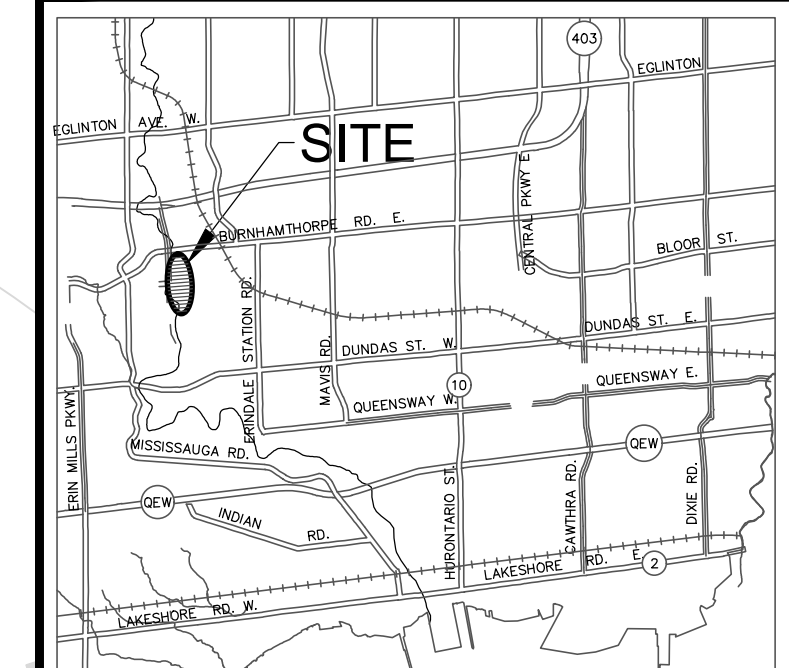

KEY PLAN
N.T.S.

Aquafor Beech Limited
 #4-200-2400 SKYWAY AVE.
 MISSISSAUGA, ONTARIO L4W 5B2
 PHONE: (905) 629-0099 FAX: (905) 629-0089

MISSISSAUGA

Project Name:
**Credit River Erosion Control
From Dundas Street West to Hwy 403**

Drawing Title:
**CULHAM TRAIL - MID TRAIL
ALTERNATIVE 1 - DO NOTHING**

DRAWN BY:	O.C.	CHECKED BY:	R.A.	PROJECT NO.	XX XXX XXXX
DESIGNED BY:	R.A.	CHECKED BY:		DWG. NO.	GP-2
SCALE:	1:1500	DATE:	APRIL 12, 2023	SHEET NO.	1 OF 4

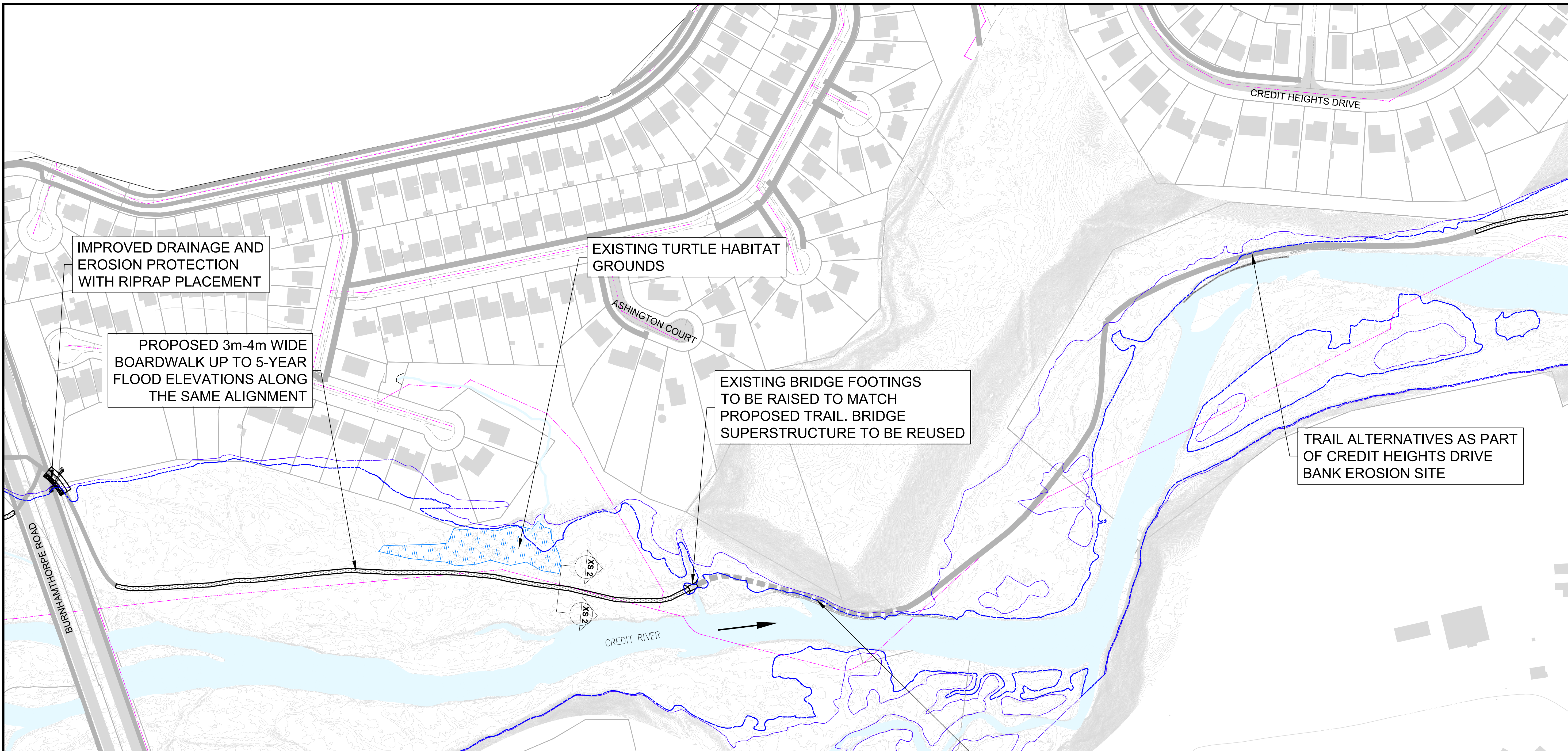

1	R.A.	12/04/2023	ISSUED FOR REVIEW	
NO.	BY	DDMMYY	REVISIONS	CHECKED

LEGEND

- PROPERTY/BUILDING LINE
- WATERCOURSE
- EXISTING TRAIL
- EXISTING CONTOUR
- SANITARY SEWER
- STORM SEWER
- WATERMAIN
- 2 YEAR FLOODLINE - EXISTING
- 5 YEAR FLOODLINE - EXISTING

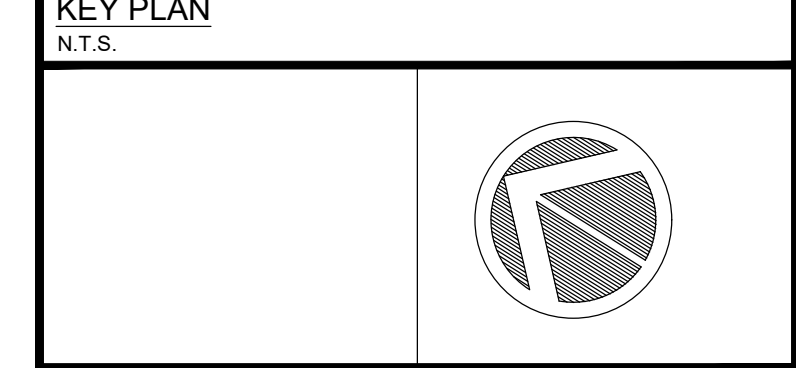
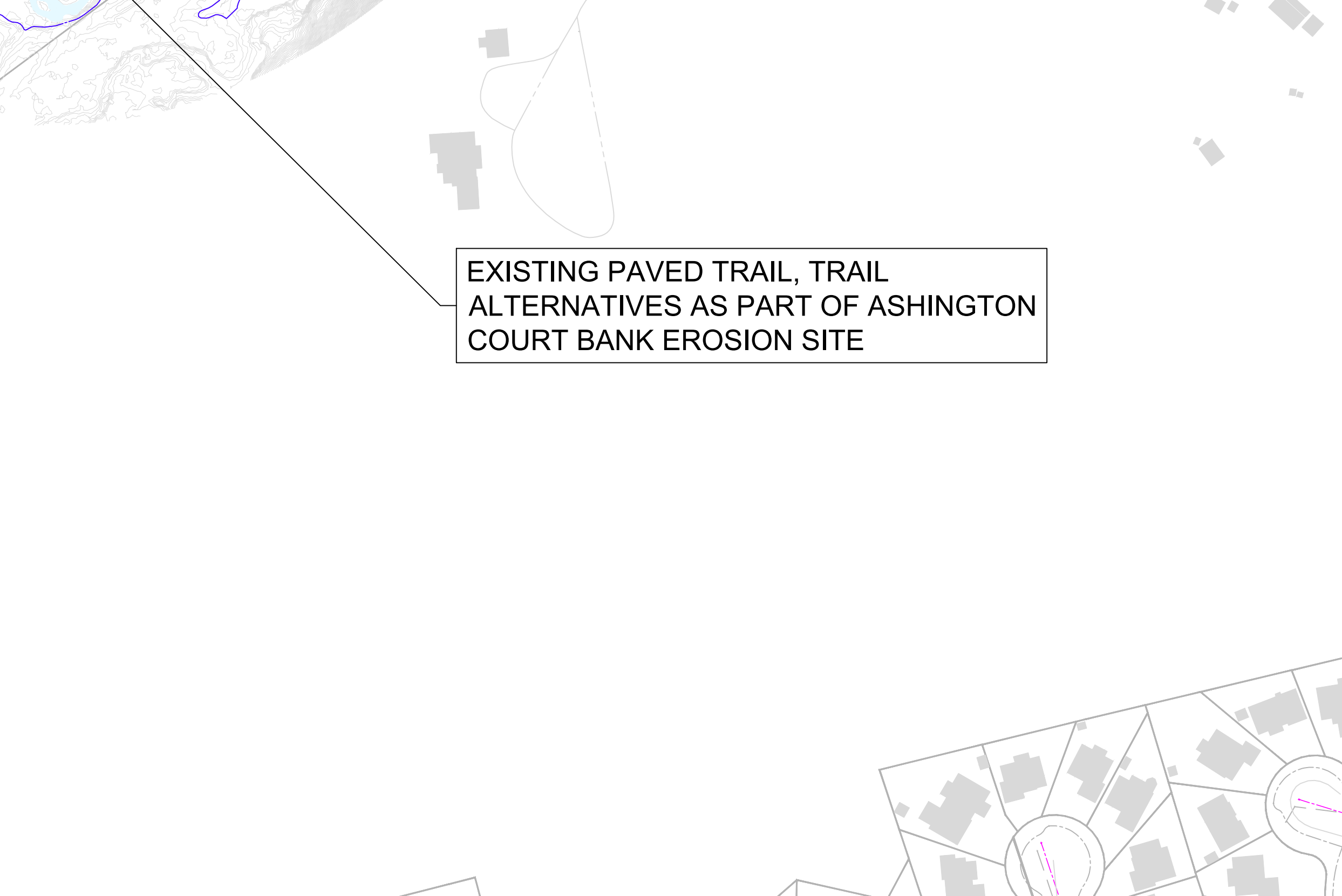
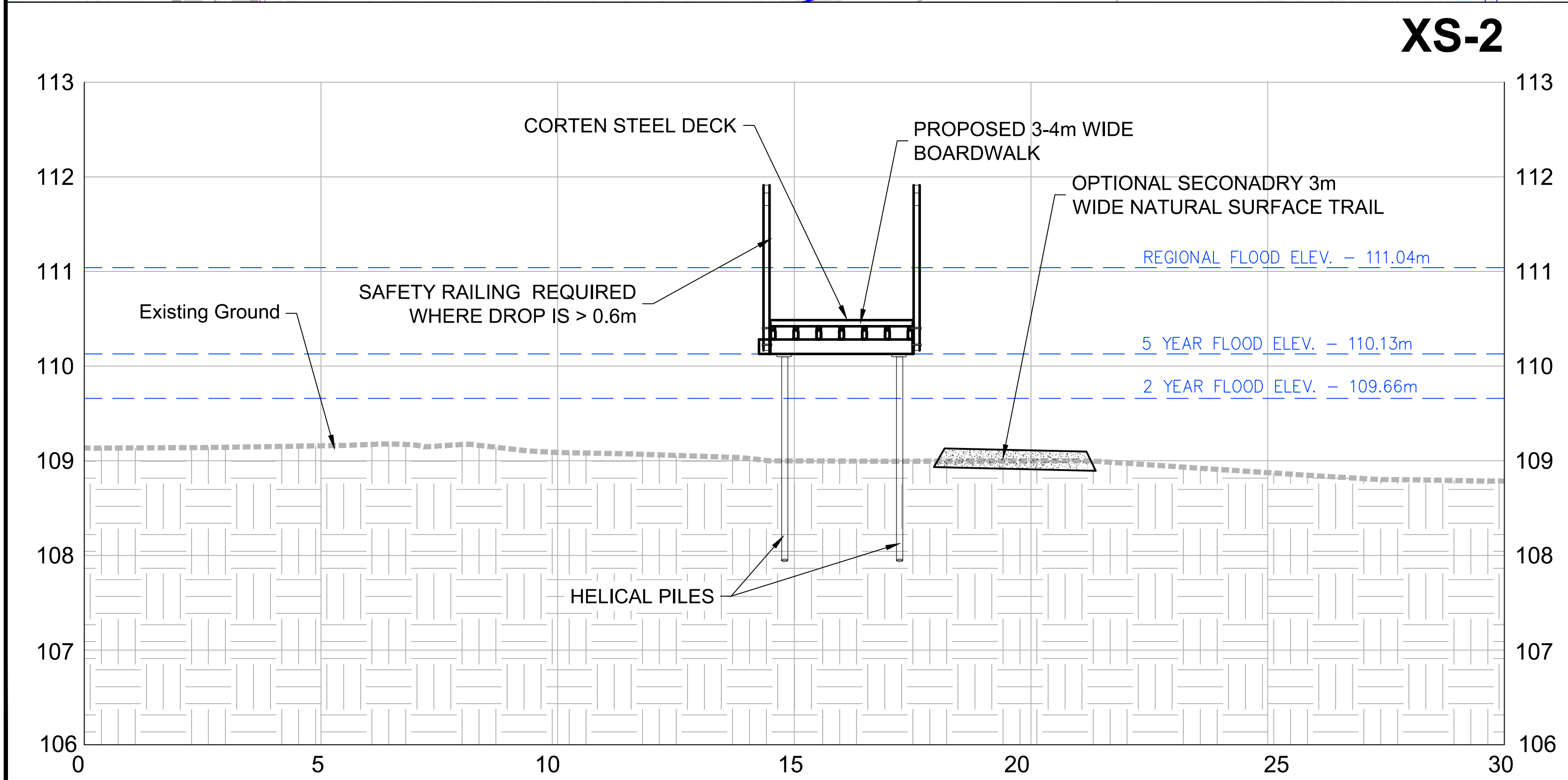
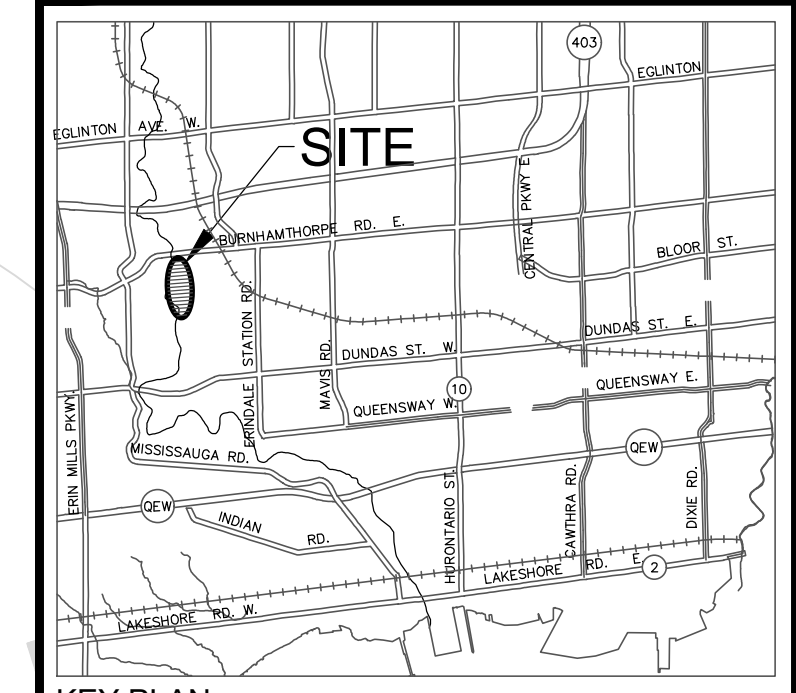
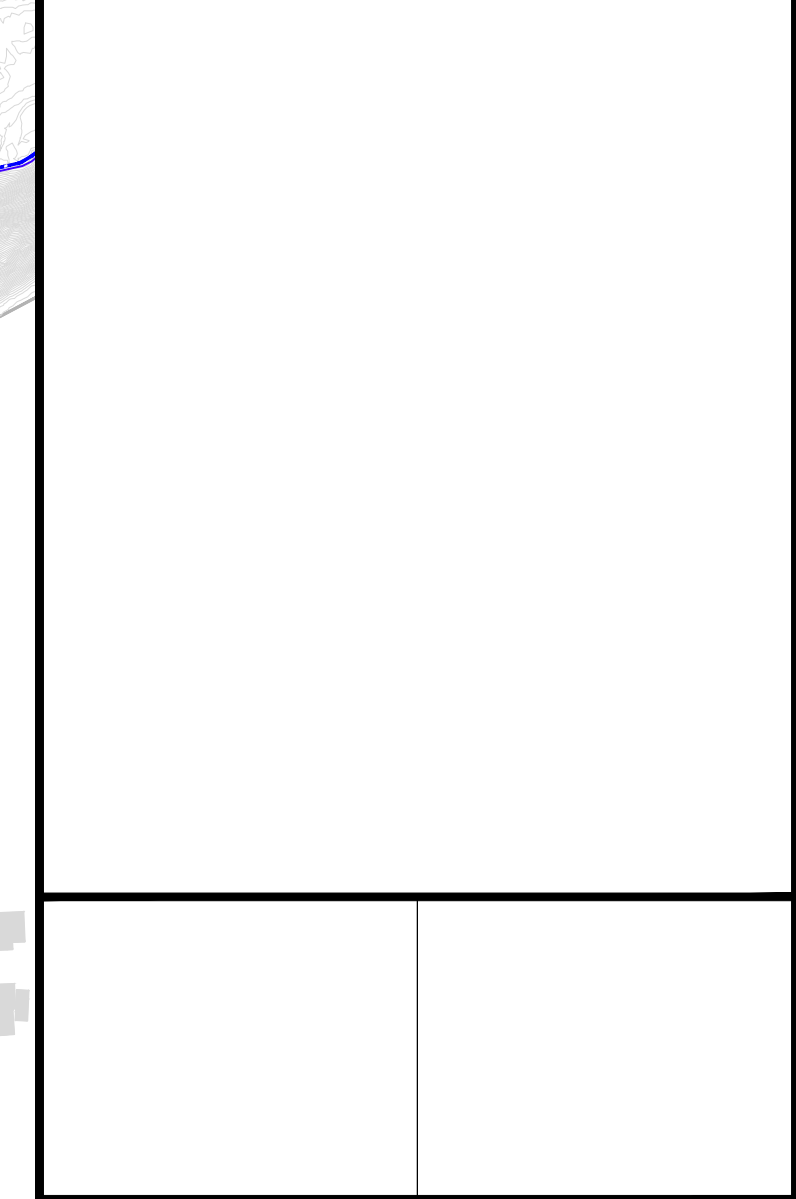

Aquafor Beech Limited
 45-200 2400 SKYWAY AVE.
 MISSISSAUGA, ONTARIO L4W 5B2
 PHONE: (905) 629-0099 FAX: (905) 629-0089



Project Name:
**Credit River Erosion Control
 From Dundas Street West to Hwy 403**

Drawing Title:
**CULHAM TRAIL - MID TRAIL
 ALTERNATIVE 3 - BOARDWALK**

DRAWN BY:	O.C.	CHECKED BY:	R.A.	PROJECT NO.	XX XXX XXXX
DESIGNED BY:	R.A.	CHECKED BY:		DWG. NO.	GP-2
SCALE:	1:1500	DATE:	APRIL 12, 2023	SHEET NO.	3 OF 4

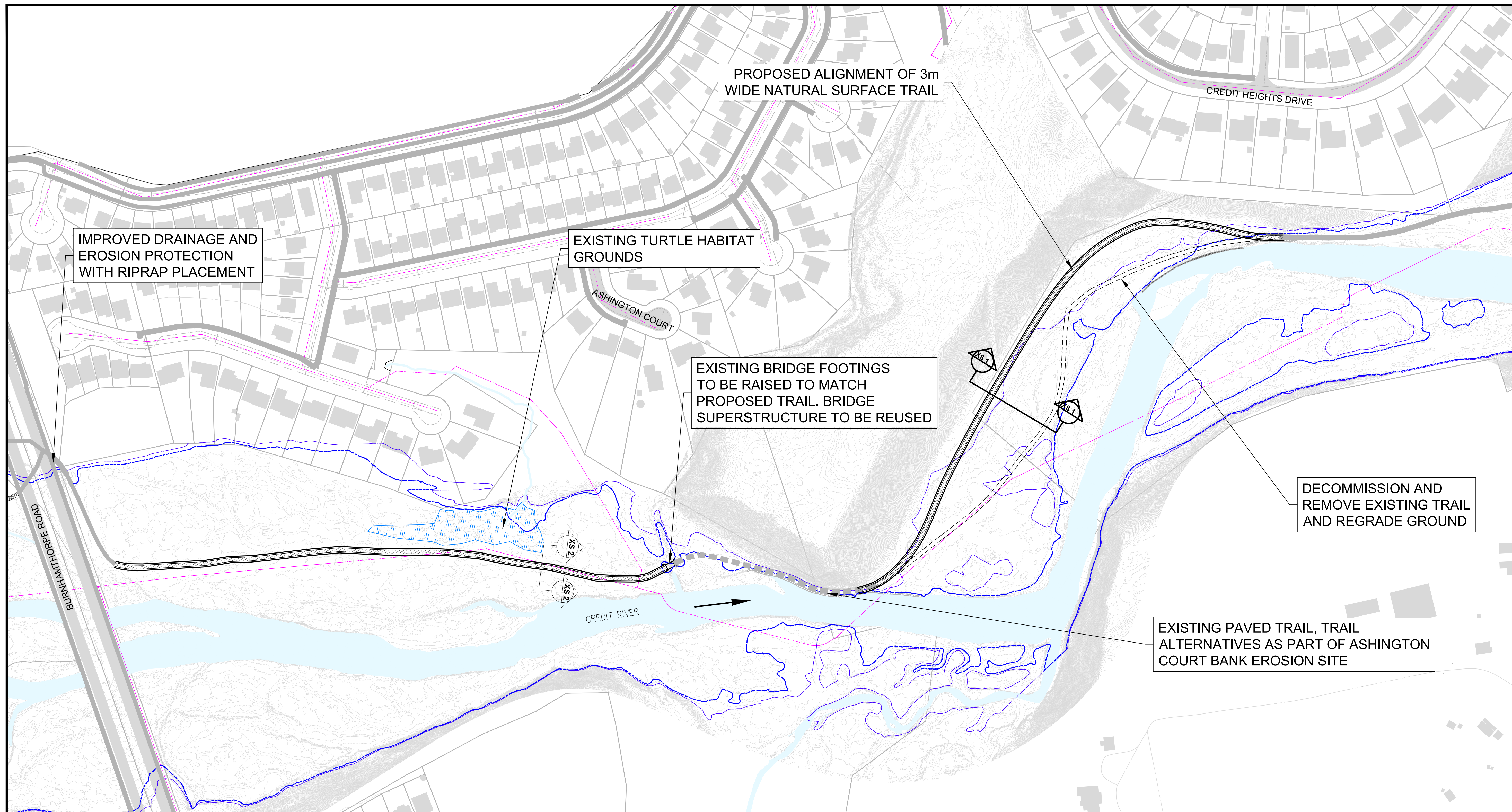

1	R.A.	12/04/2023	ISSUED FOR REVIEW	
NO.	BY	DDMMYY	REVISIONS	CHECKED

LEGEND

- PROPERTY/BUILDING LINE
- WATERCOURSE
- EXISTING TRAIL
- EXISTING CONTOUR
- SANITARY SEWER
- STORM SEWER
- WATERMAIN
- 2 YEAR FLOODLINE - EXISTING
- 5 YEAR FLOODLINE - EXISTING

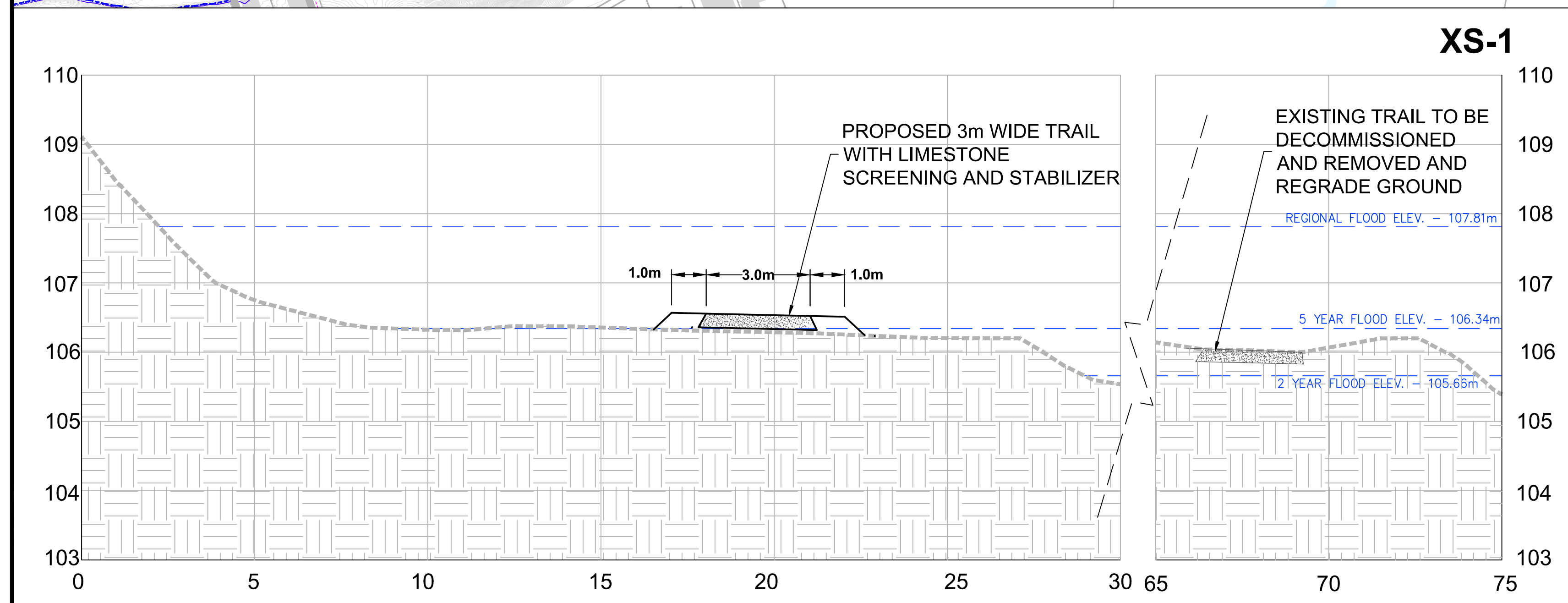
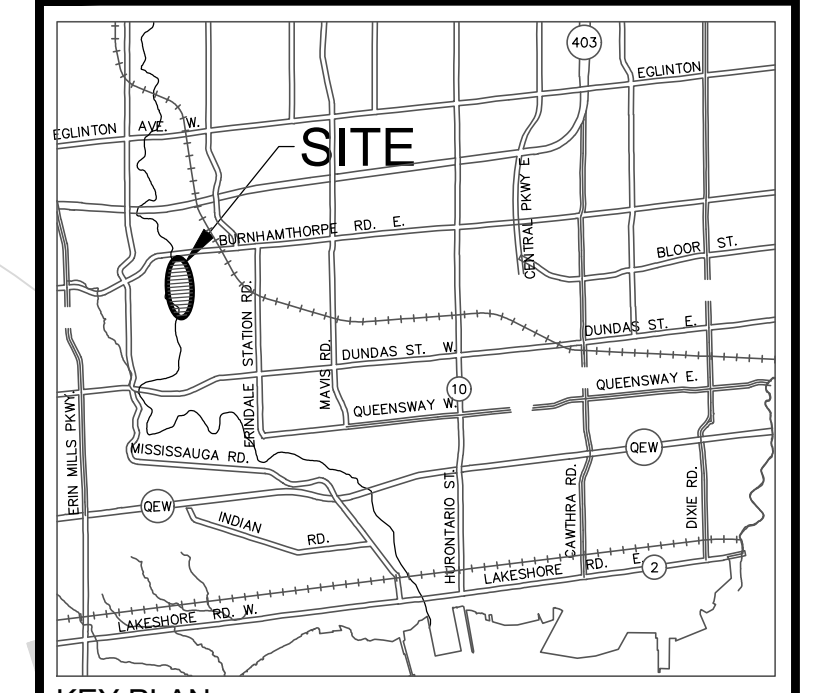

Aquafor Beech Limited

MISSISSAUGA

Project Name:
**Credit River Erosion Control
From Dundas Street West to Hwy 403**

Drawing Title:
**CULHAM TRAIL - MID TRAIL
ALTERNATIVE 4 - TRAIL REALIGNMENT**

DRAWN BY: O.C.	CHECKED BY: R.A.	PROJECT NO. XX XXX XXXX
DESIGNED BY: R.A.	CHECKED BY:	DWG. NO. GP-2
SCALE: 1:1500	DATE: APRIL 12, 2023	SHEET NO. 4 OF 4

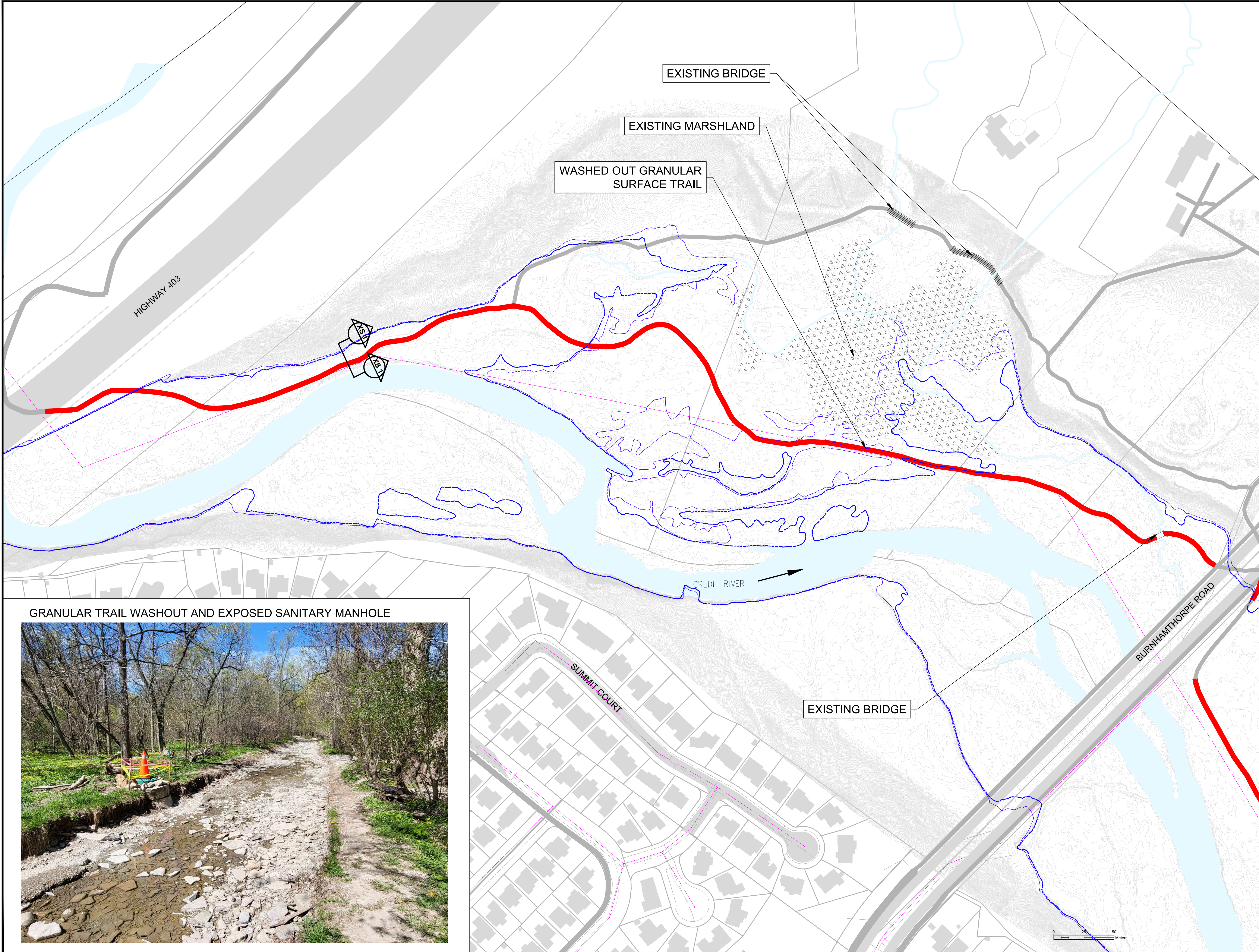

GRANULAR TRAIL WASHOUT AND EXPOSED SANITARY MANHOLE



NO.	BY	DATE	REVISIONS	CHECKED
1	R.A.	12/04/2023	ISSUED FOR REVIEW	

LEGEND

	PROPERTY/ BUILDING LINE
	WATERCOURSE
	EXISTING TRAIL
	EXISTING CONTOUR
	SANITARY SEWER
	STORM SEWER
	WATERMAIN
	2 YEAR FLOODLINE - EXISTING
	5 YEAR FLOODLINE - EXISTING

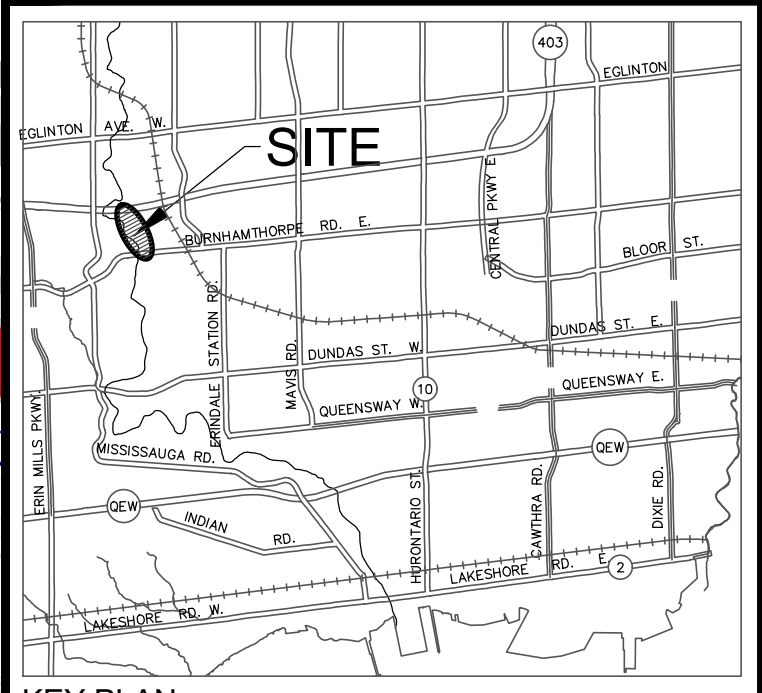

KEY PLAN
N.T.S.

Aquafor Beech Limited
 #6-203-2103 SKYHARVEY AVE.
 MISSISSAUGA, ONTARIO L4W 9S2
 PHONE: (905) 629-0099 FAX: (905) 629-0089

MISSISSAUGA

Project Name:
**Credit River Erosion Control
 From Dundas Street West to Hwy 403**

Drawing Title:
**CULHAM TRAIL UPSTREAM
 ALTERNATIVE 1 - DO NOTHING**

DRAWN BY:	O.C.	CHECKED BY:	R.A.	PROJECT NO.	XX XXX XXXX
DESIGNED BY:	R.A.	CHECKED BY:		DWG. NO.	GP-1
SCALE:	1:1300	DATE:	APRIL 12, 2023	SHEET NO.	1 OF 4

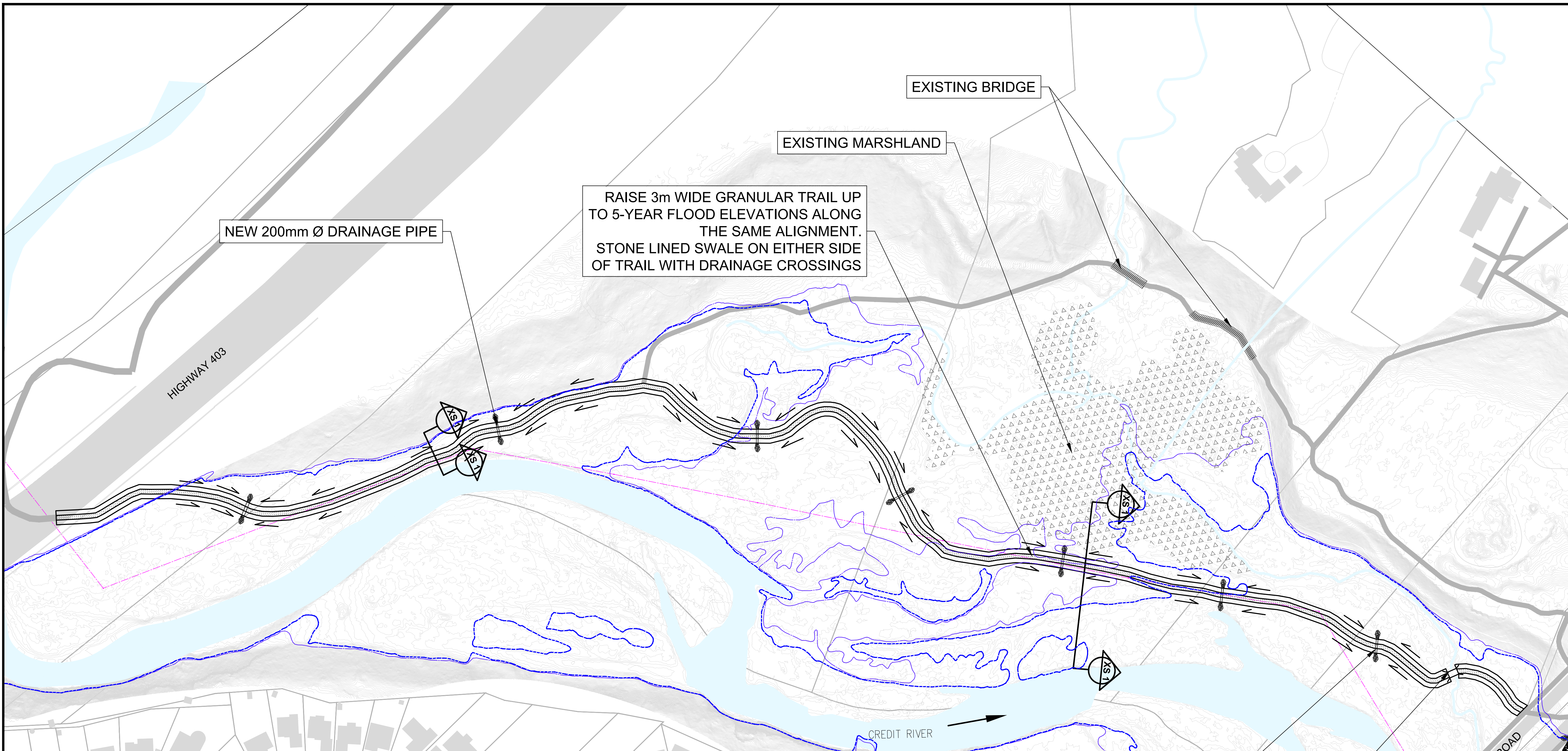

RAISE 3m WIDE GRANULAR TRAIL UP TO 5-YEAR FLOOD ELEVATIONS ALONG THE SAME ALIGNMENT. STONE LINED SWALE ON EITHER SIDE OF TRAIL WITH DRAINAGE CROSSINGS

NEW 200mm Ø DRAINAGE PIPE

EXISTING BRIDGE

EXISTING MARSHLAND

HIGHWAY 403

CREDIT RIVER

BURNHAMTHORPE ROAD

1	R.A.	12/04/2023	ISSUED FOR REVIEW	
NO.	BY	DDMMYY	REVISIONS	CHECKED

LEGEND

	PROPERTY/BUILDING LINE
	WATERCOURSE
	EXISTING TRAIL
	EXISTING CONTOUR
	SANITARY SEWER
	STORM SEWER
	WATERMAIN
	2 YEAR FLOODLINE - EXISTING
	5 YEAR FLOODLINE - EXISTING

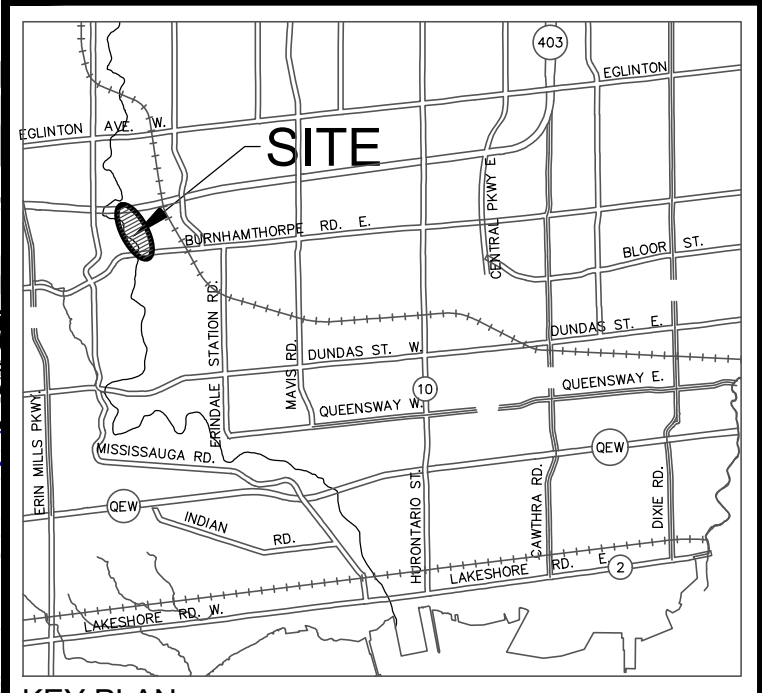

KEY PLAN
N.T.S.

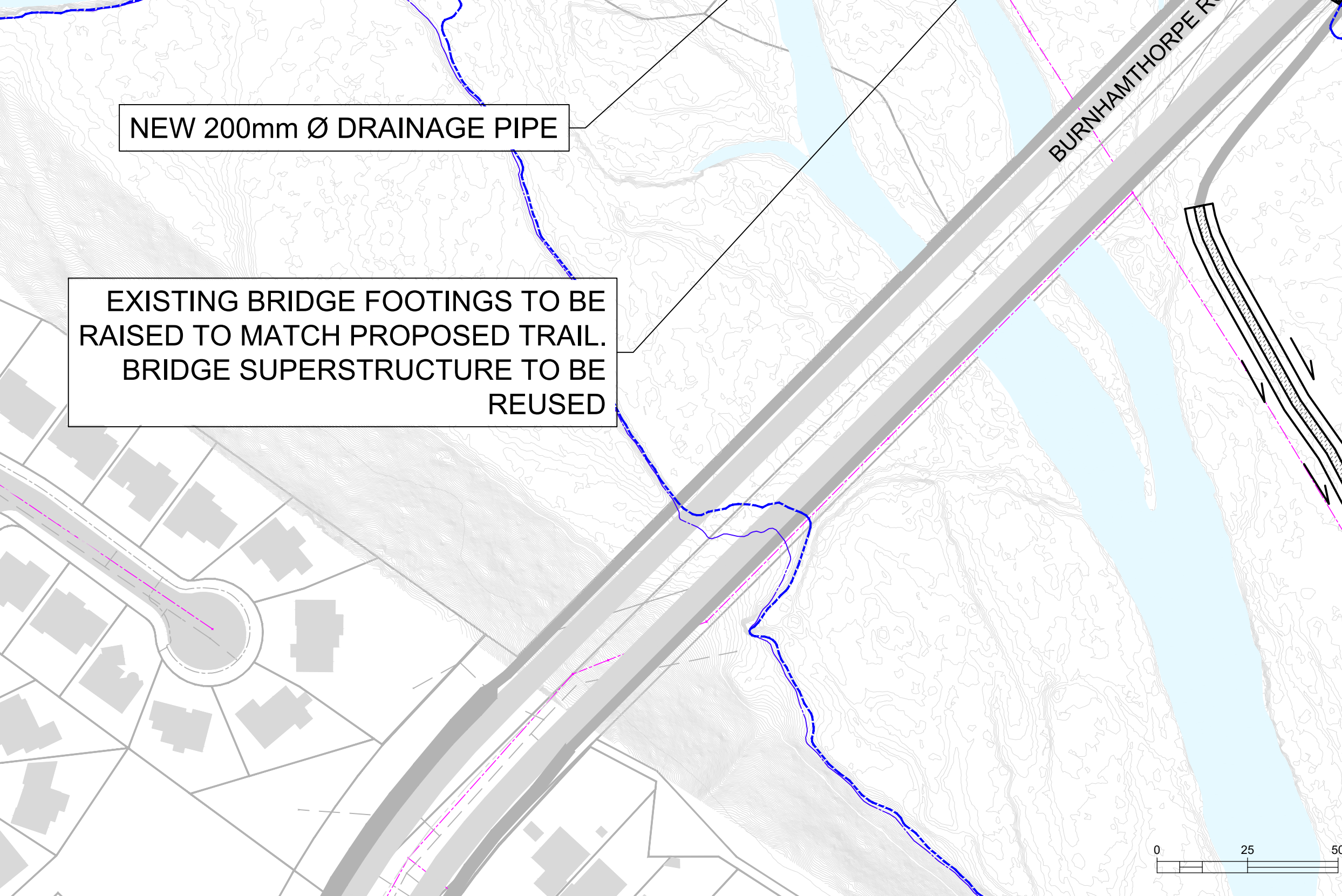
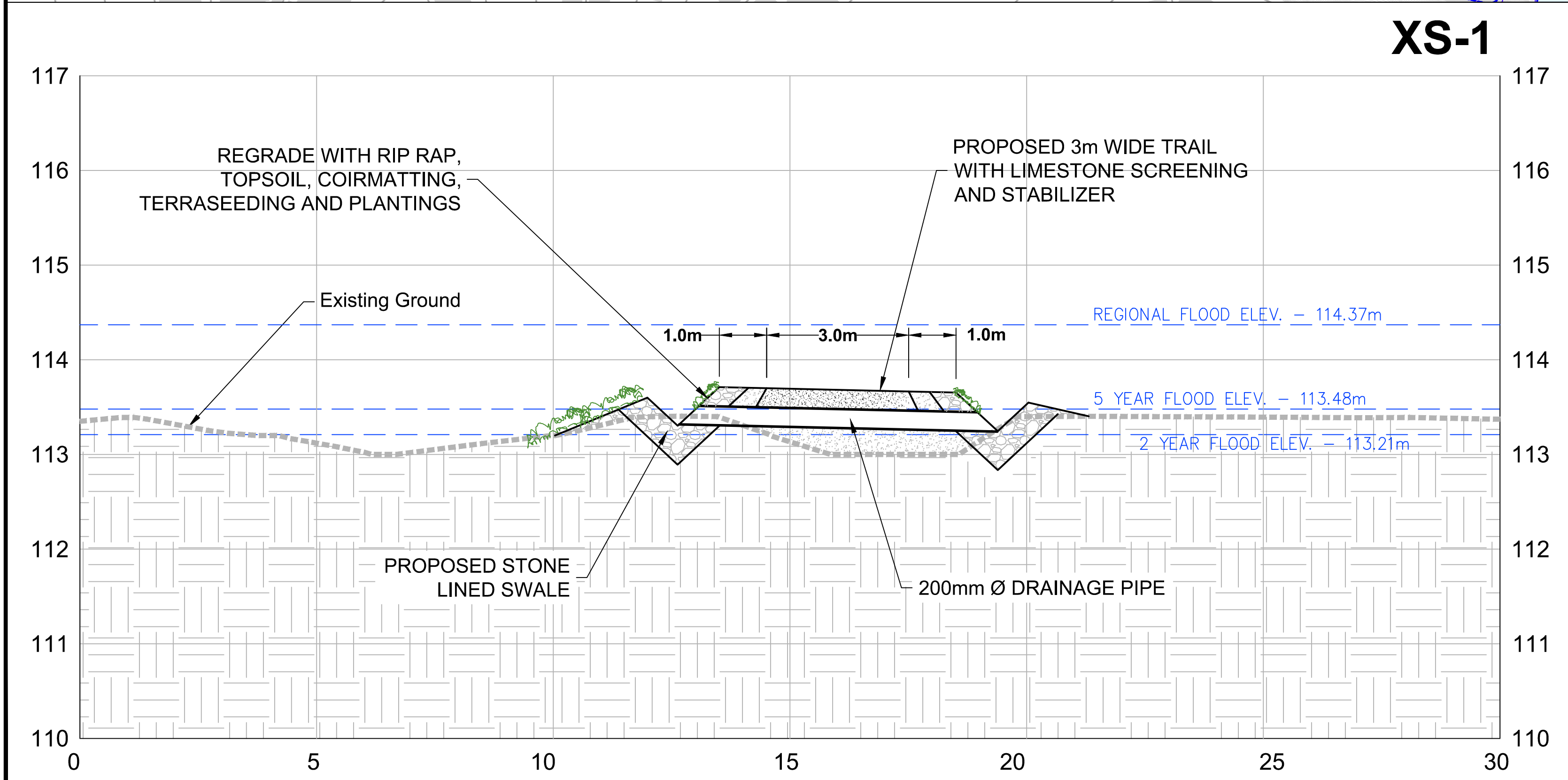

Aquafor Beech Limited

46-200-2400 SKYHARVEY AVE.
MISSISSAUGA, ONTARIO L4W 9S2
PHONE: (905) 629-0099 FAX: (905) 629-0089

MISSISSAUGA

Project Name:
**Credit River Erosion Control
From Dundas Street West to Hwy 403**

Drawing Title:
**CULHAM TRAIL UPSTREAM
ALTERNATIVE 2 - RAISED GRAVEL TRAIL**

DRAWN BY:	O.C.	CHECKED BY:	R.A.	PROJECT NO.	XX XXX XXXX
DESIGNED BY:	R.A.	CHECKED BY:		DWG. NO.	GP-1
SCALE:	1:1300	DATE:	APRIL 12, 2023	SHEET NO.	2 OF 4

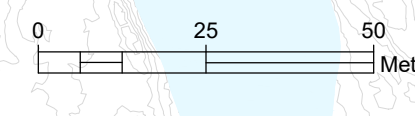

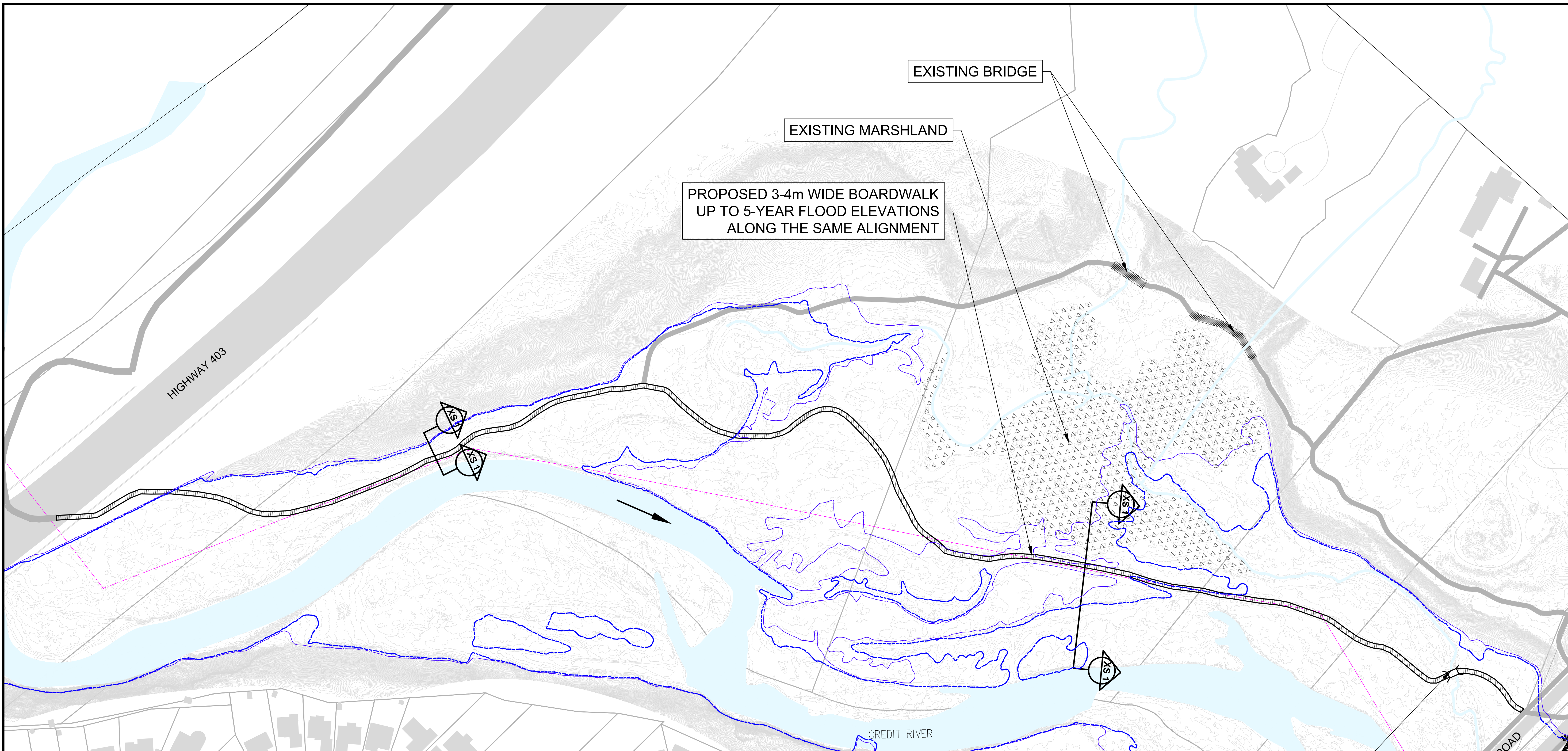

NO.	BY	DATE	REVISIONS	CHECKED
1	R.A.	12/04/2023	ISSUED FOR REVIEW	

LEGEND

- PROPERTY/BUILDING LINE
- WATERCOURSE
- EXISTING TRAIL
- EXISTING CONTOUR
- SANITARY SEWER
- STORM SEWER
- WATERMAIN
- 2 YEAR FLOODLINE - EXISTING
- 5 YEAR FLOODLINE - EXISTING

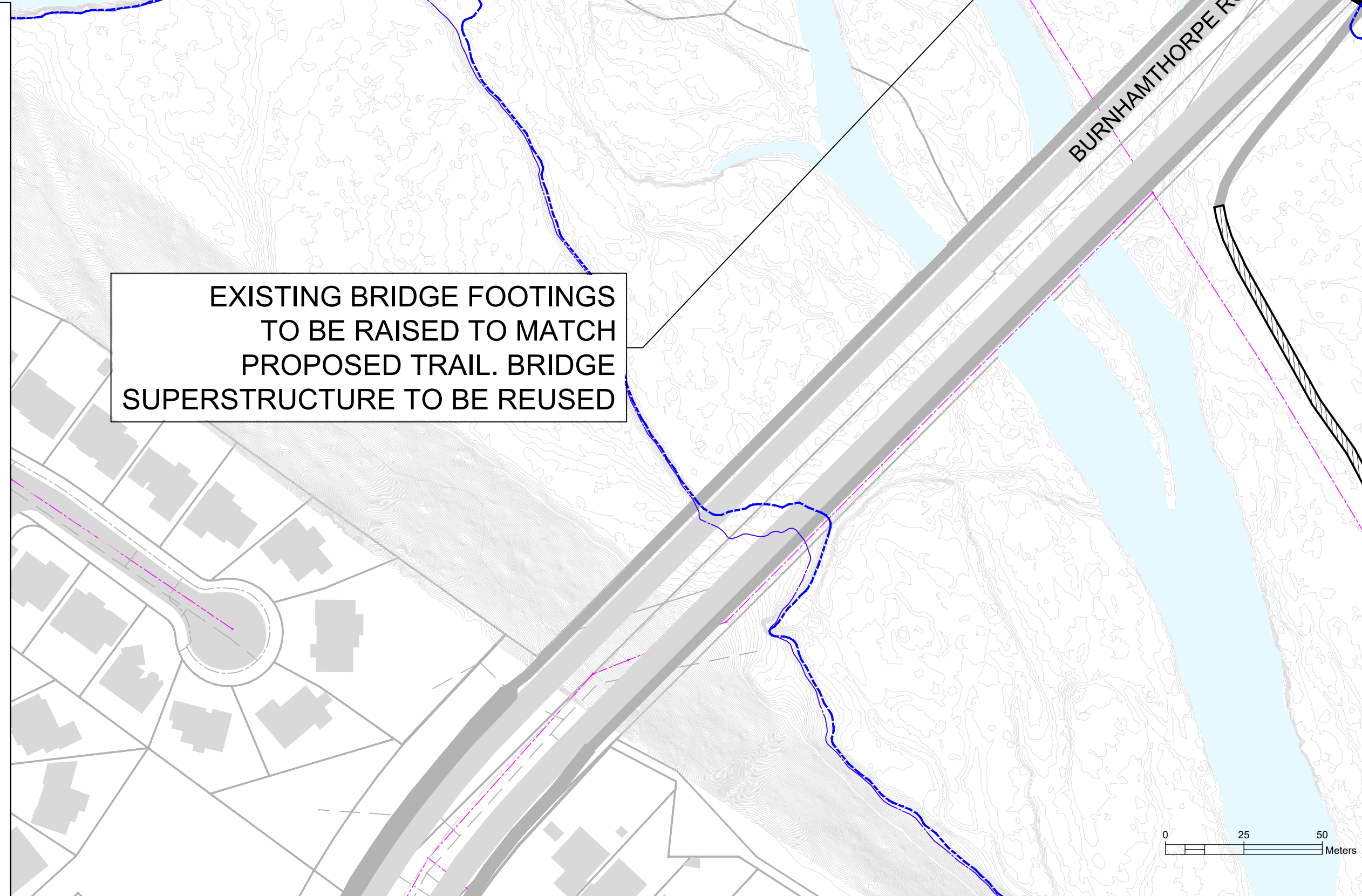
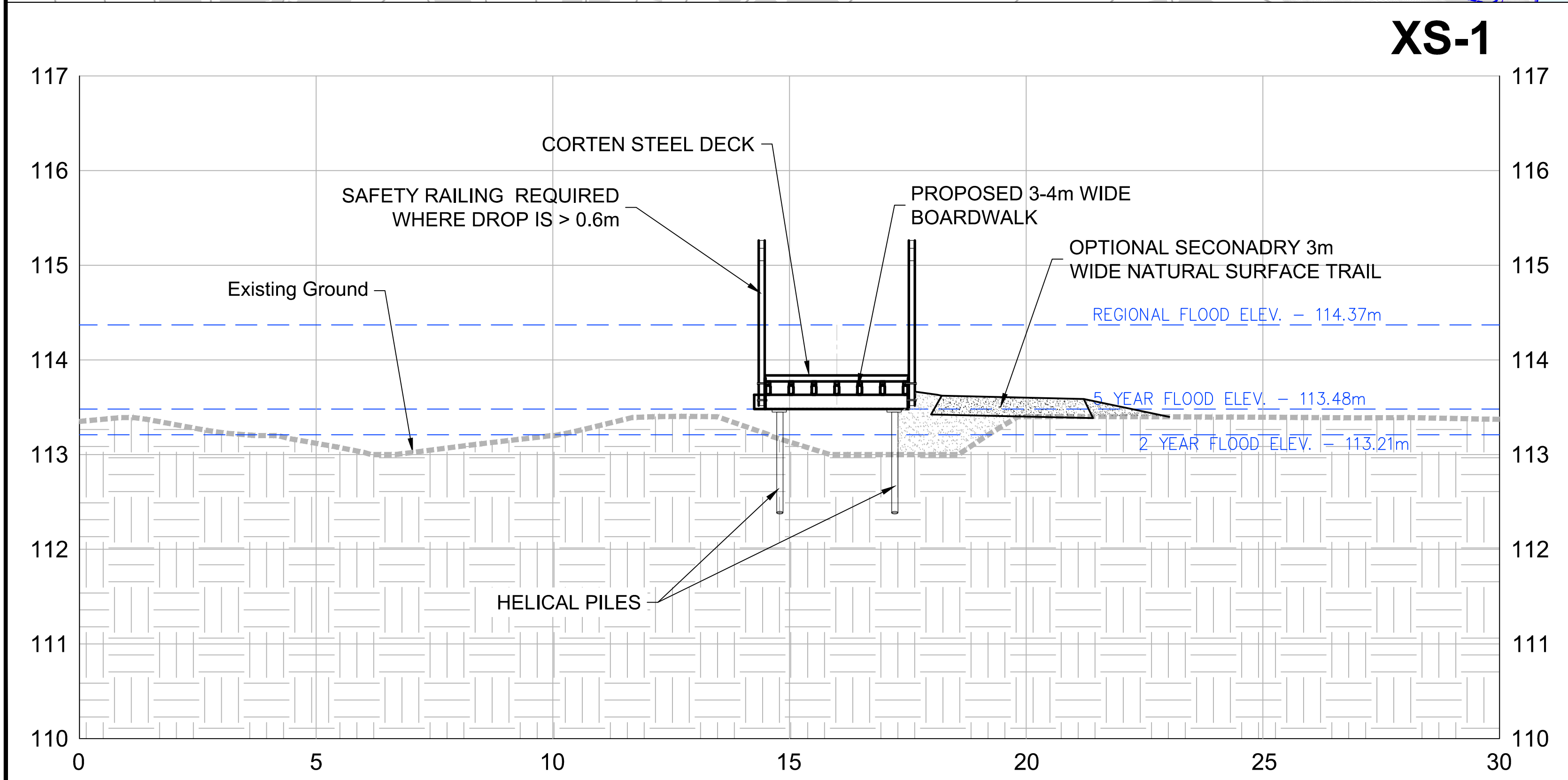
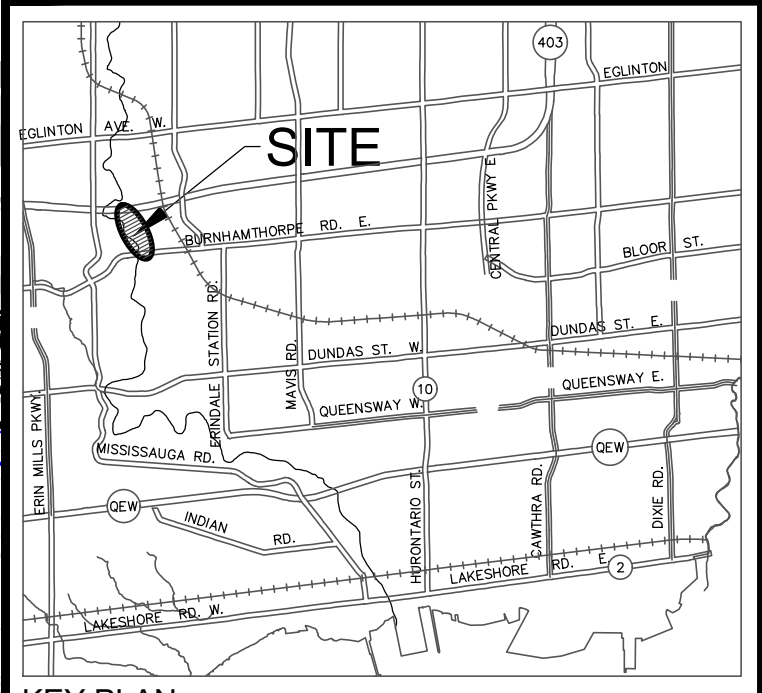

KEY PLAN
N.T.S.

Aquafor Beech Limited
46-200 2400 SKYWAY AVE.
MISSISSAUGA, ONTARIO L4W 9S2
PHONE: (905) 629-0099 FAX: (905) 629-0089

Project Name:
**Credit River Erosion Control
From Dundas Street West to Hwy 403**

Drawing Title:
**CULHAM TRAIL UPSTREAM
ALTERNATIVE 3 - BOARDWALK**

DRAWN BY:	O.C.	CHECKED BY:	R.A.	PROJECT NO.	XX XXX XXXX
DESIGNED BY:	R.A.	CHECKED BY:		DWG. NO.	GP-1
SCALE:	1:1300	DATE:	APRIL 12, 2023	SHEET NO.	3 OF 4

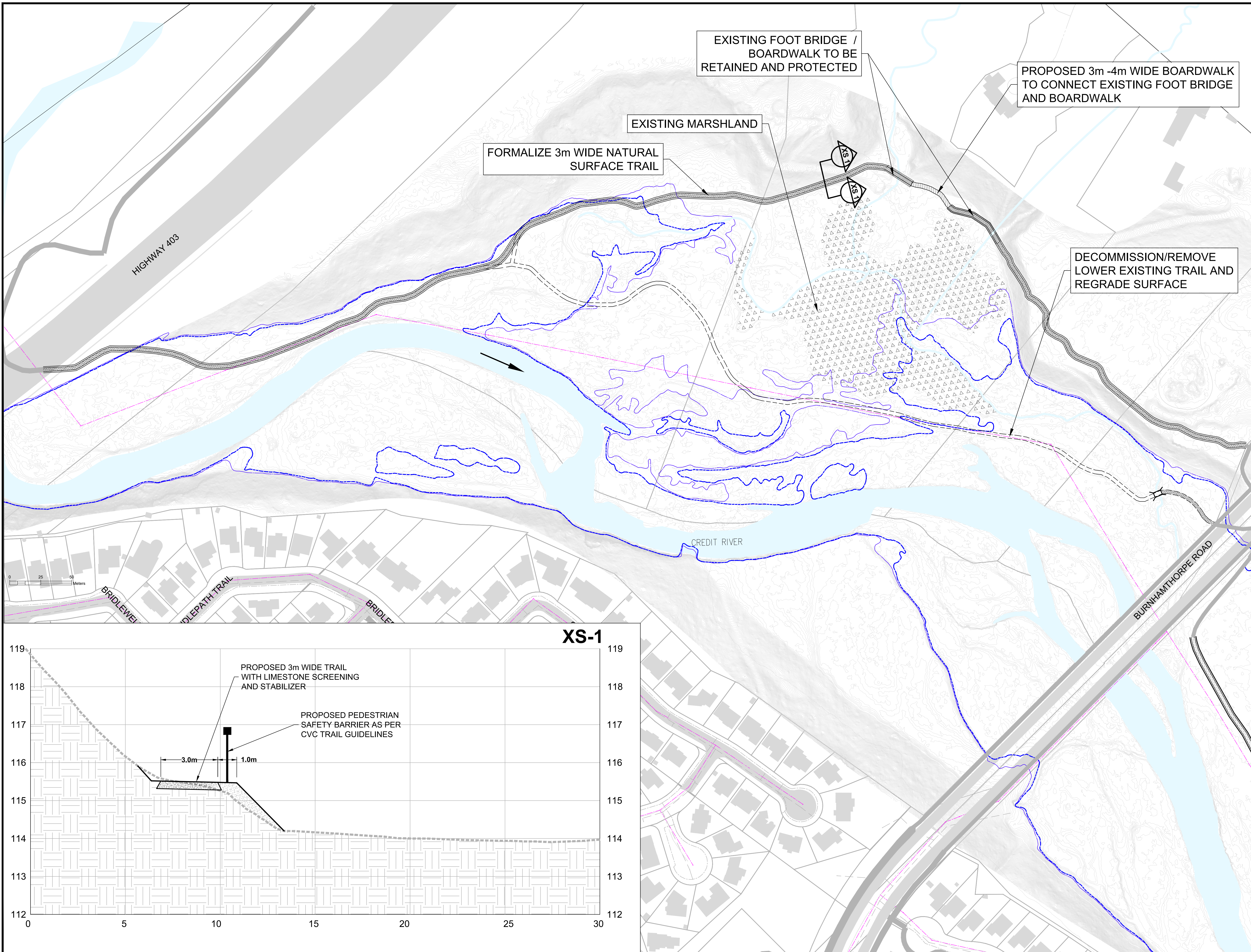

1	R.A.	12/04/2023	ISSUED FOR REVIEW
NO.	BY	DDMMYY	REVISIONS
			CHECKED

LEGEND

- PROPERTY/ BUILDING LINE
- WATERCOURSE
- EXISTING TRAIL
- EXISTING CONTOUR
- SANITARY SEWER
- STORM SEWER
- WATERMAIN
- 2 YEAR FLOODLINE - EXISTING
- 5 YEAR FLOODLINE - EXISTING

DECOMMISSION/REMOVE LOWER EXISTING TRAIL AND REGRADE SURFACE

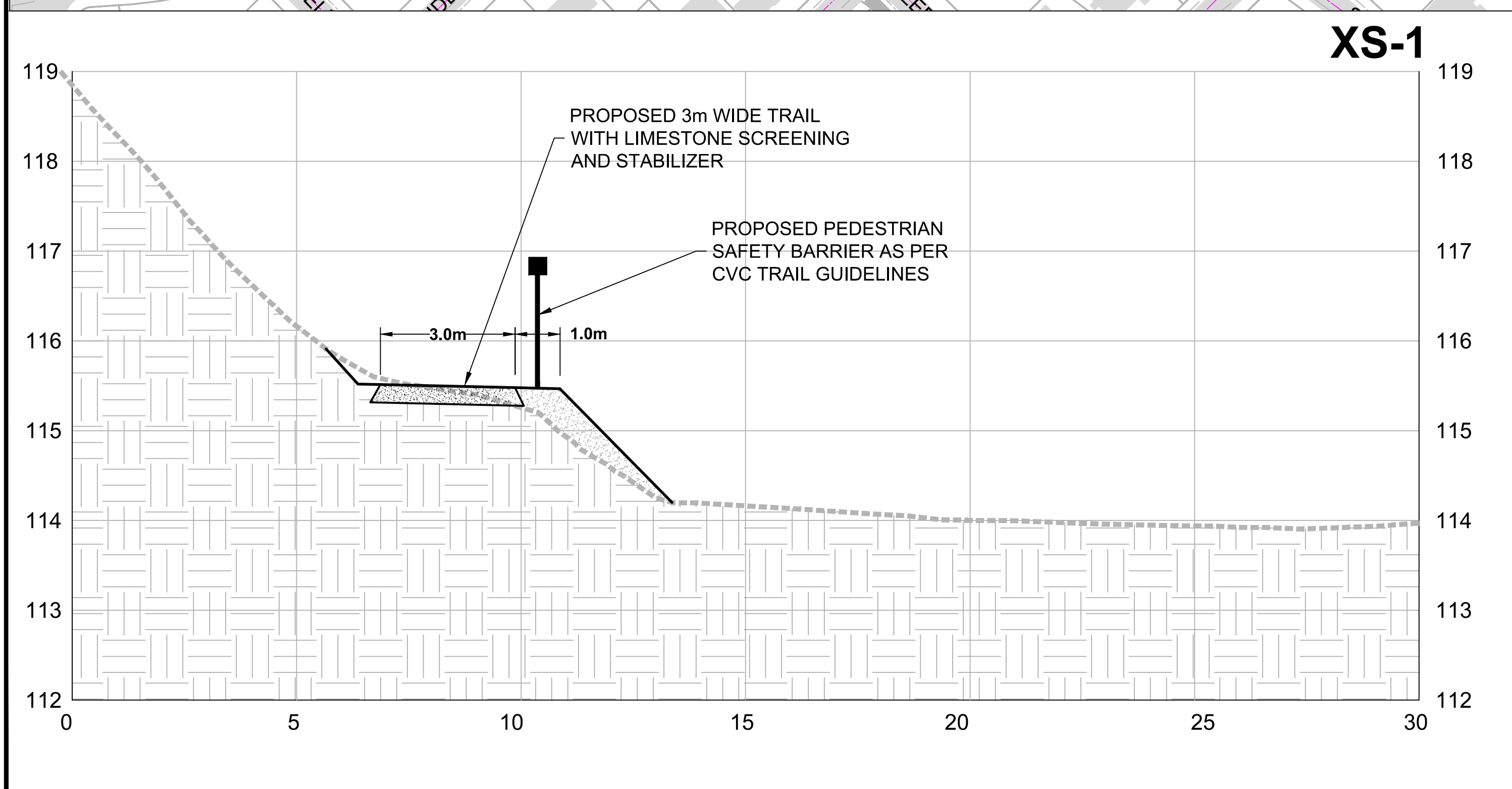
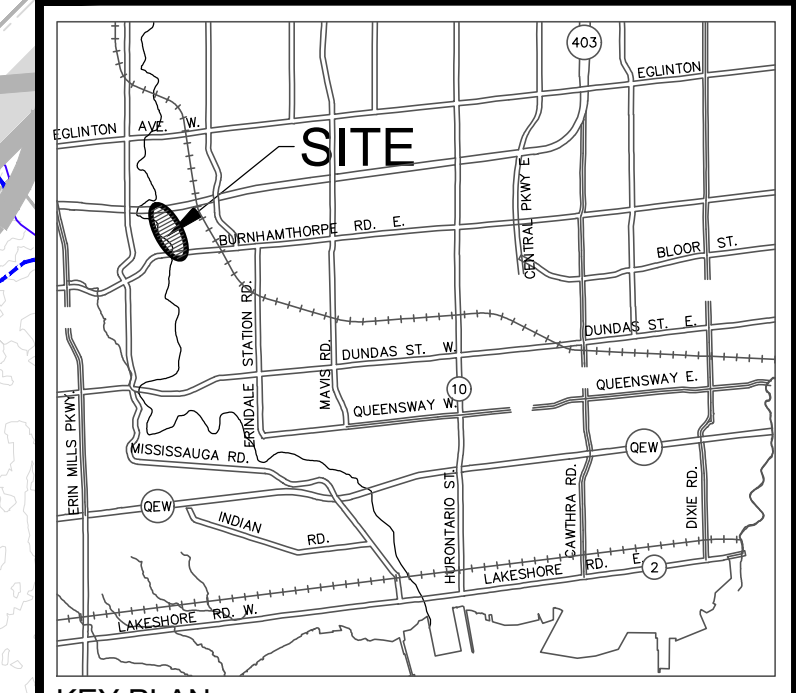

KEY PLAN
N.T.S.

Aquafor Beech Limited
45-200-2100 SKYWAY AVE.
MISSISSAUGA, ONTARIO L4W 9S2
PHONE: (905) 629-0099 FAX: (905) 629-0089

Project Name:
**Credit River Erosion Control
From Dundas Street West to Hwy 403**

Drawing Title:
**CULHAM TRAIL UPSTREAM
ALTERNATIVE 4 - TRAIL REALIGNMENT**

DRAWN BY:	O.C.	CHECKED BY:	R.A.	PROJECT NO.	XX XXX XXXX
DESIGNED BY:	R.A.	CHECKED BY:		DWG. NO.	GP-1
SCALE:	1:1300	DATE:	APRIL 12, 2023	SHEET NO.	4 OF 4

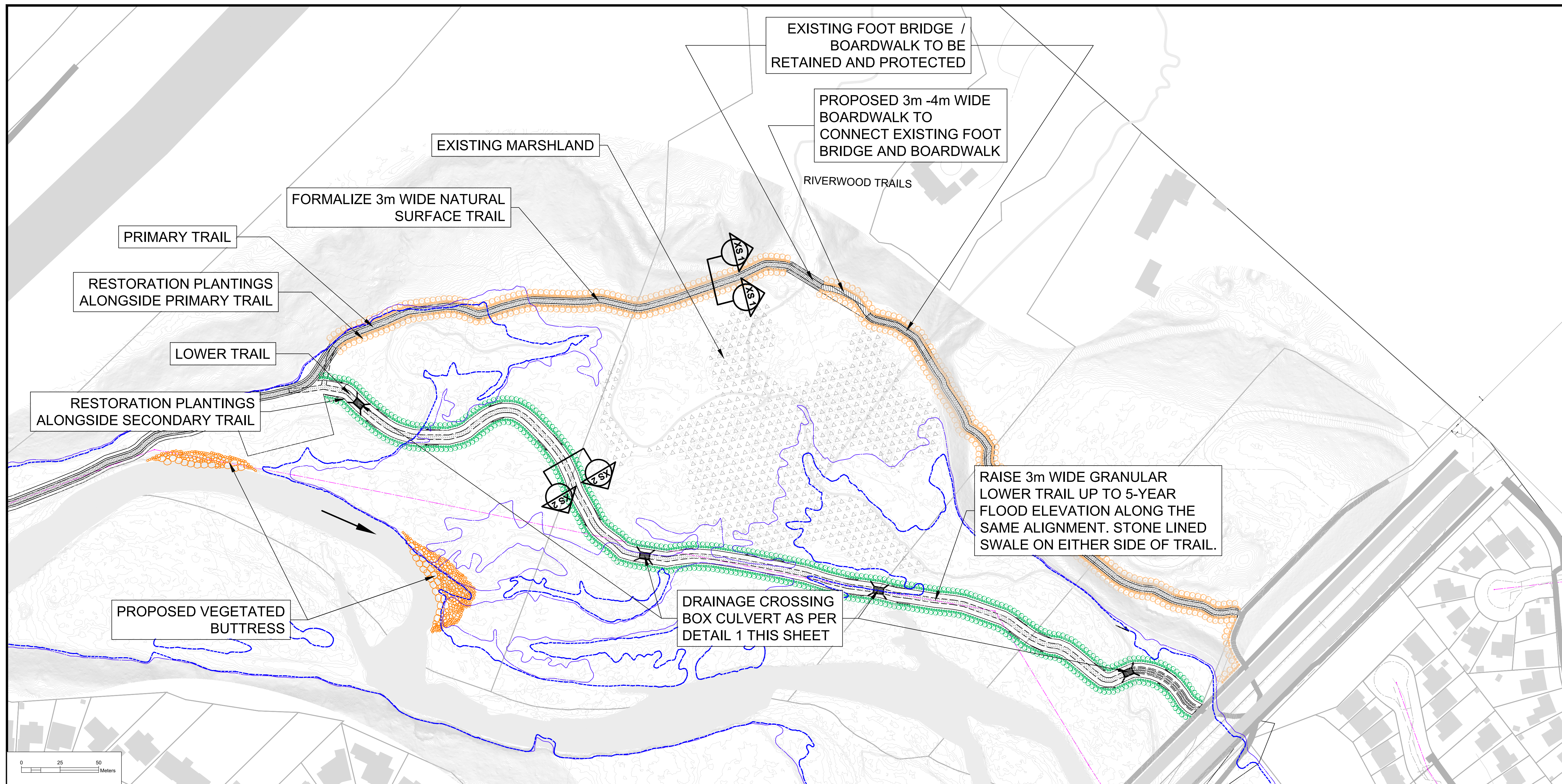

1	R.A.	12/04/2023	ISSUED FOR REVIEW	
NO.	BY	DDMMYY	REVISIONS	CHECKED

LEGEND

- PROPERTY/ BUILDING LINE
- WATERCOURSE
- EXISTING TRAIL
- EXISTING CONTOUR
- SANITARY SEWER
- STORM SEWER
- WATERMAIN
- 2 YEAR FLOODLINE - EXISTING
- 5 YEAR FLOODLINE - EXISTING
- PRIMARY TRAIL
- LOWER TRAIL
- NEW DRAINAGE CROSSING (BOX CULVERT)

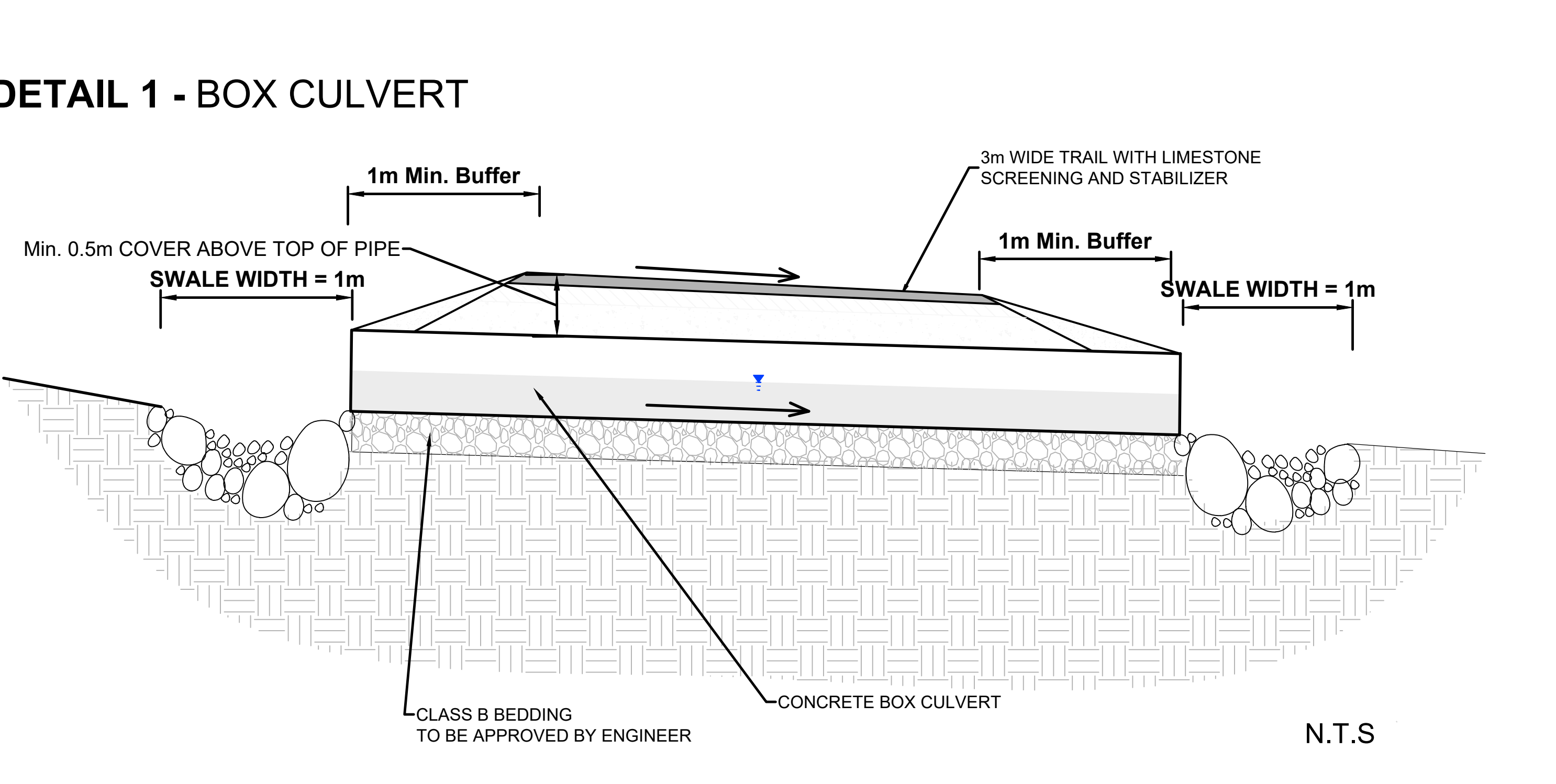
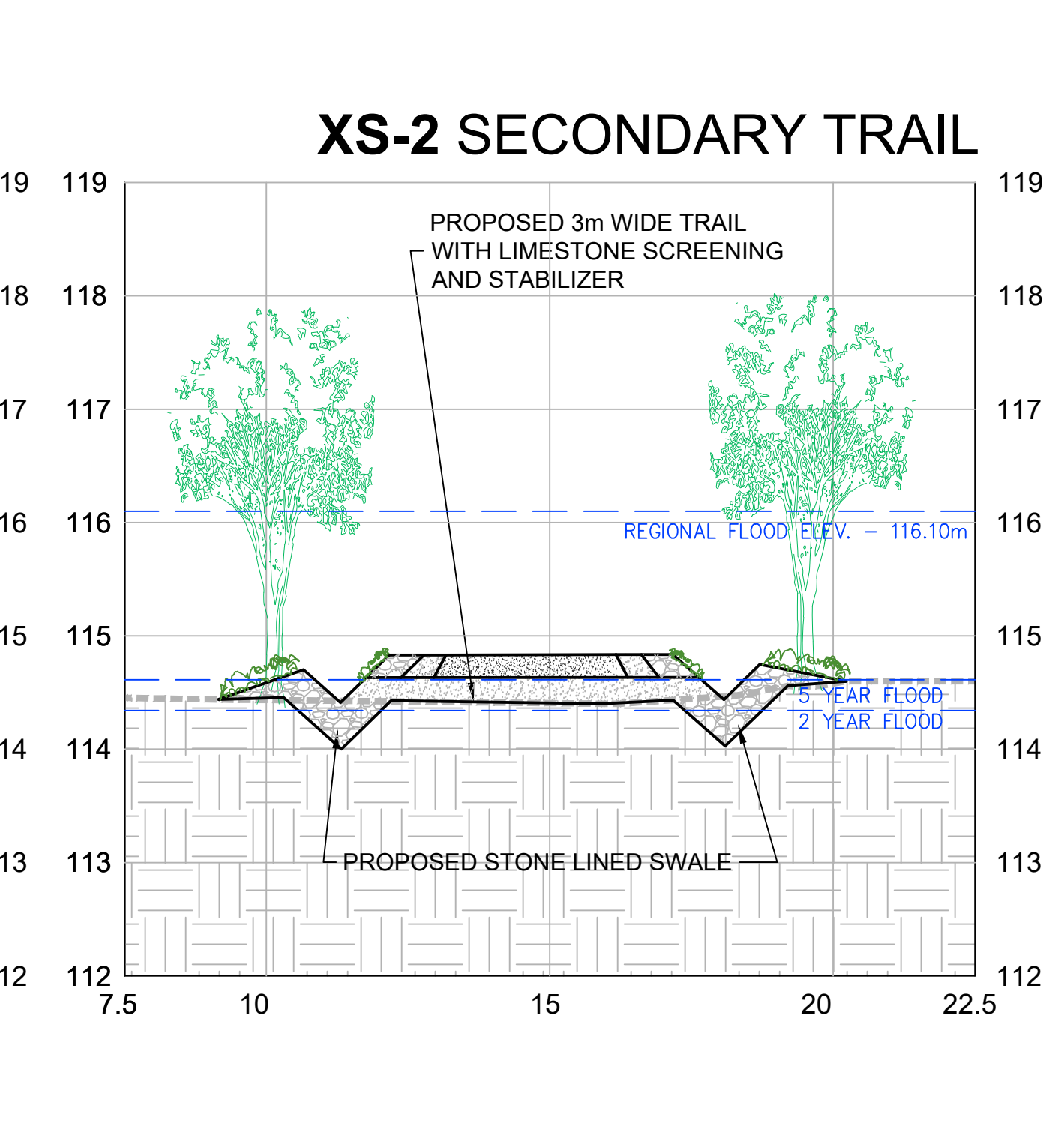
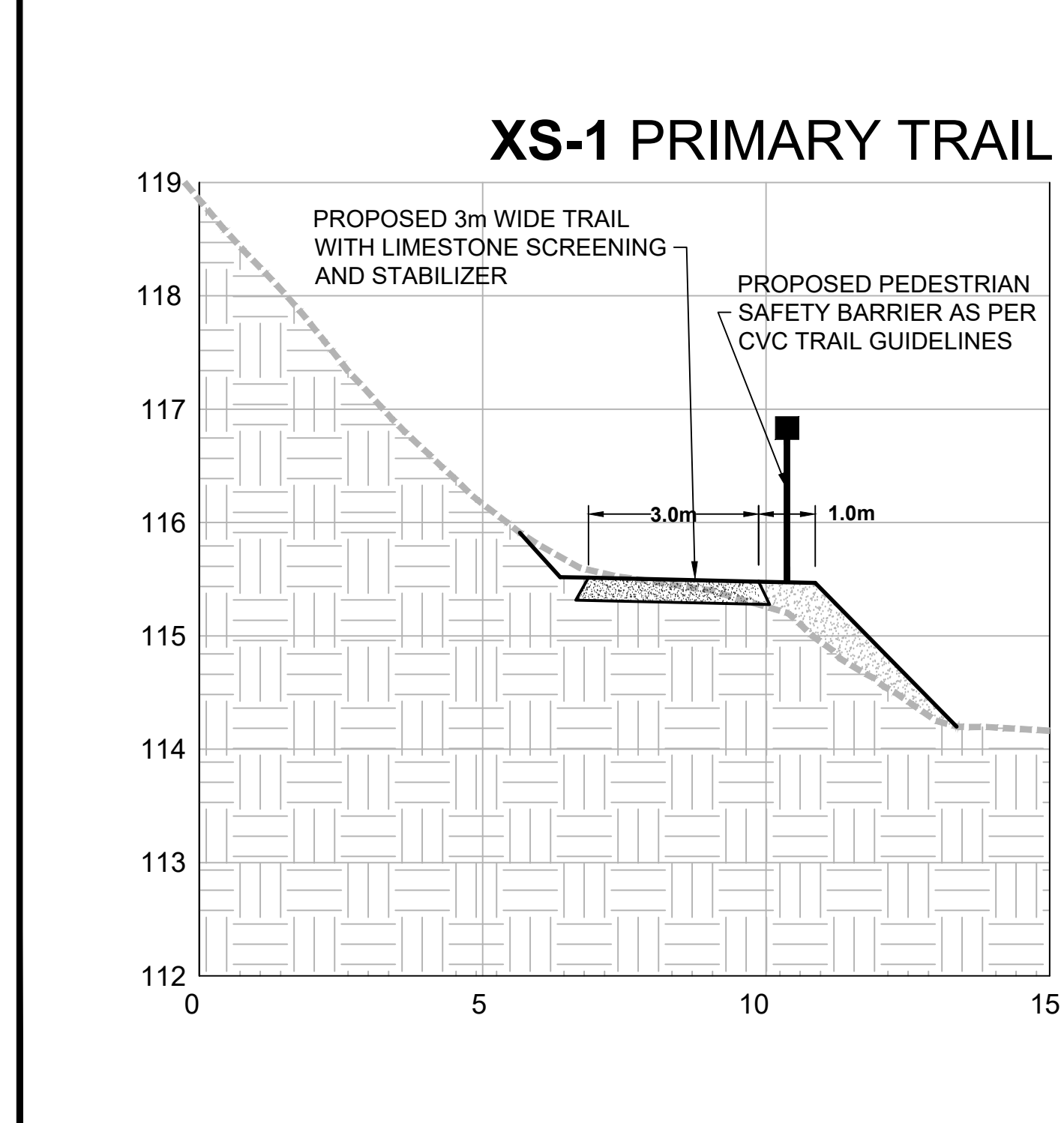
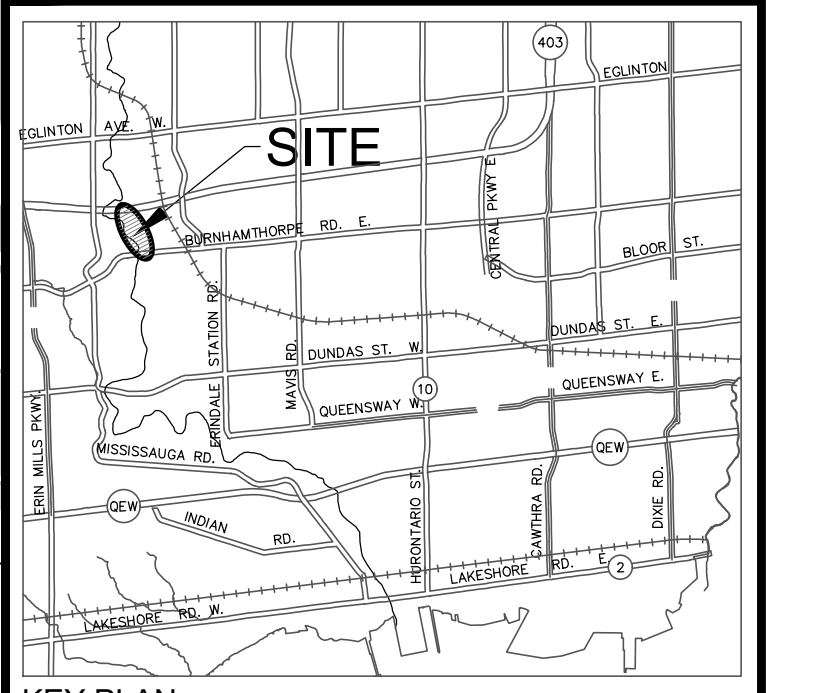

KEY PLAN
N.T.S.

MISSISSAUGA

Project Name:
**Credit River Erosion Control
From Dundas Street West to Hwy 403**

Drawing Title:
**CULHAM TRAIL UPSTREAM
ALTERNATIVE 5 - HYBRID TRAIL OPTION**

DRAWN BY:	O.C.	CHECKED BY:	R.A.	PROJECT NO.:	XX XXX XXXX
DESIGNED BY:	R.A.	CHECKED BY:		DWG. NO.:	GP-1
SCALE:	1:1300	DATE:	APRIL 12, 2023	SHEET NO.:	5 OF 5