

PLOT DATE: June 27, 2024 3:06:34 PM

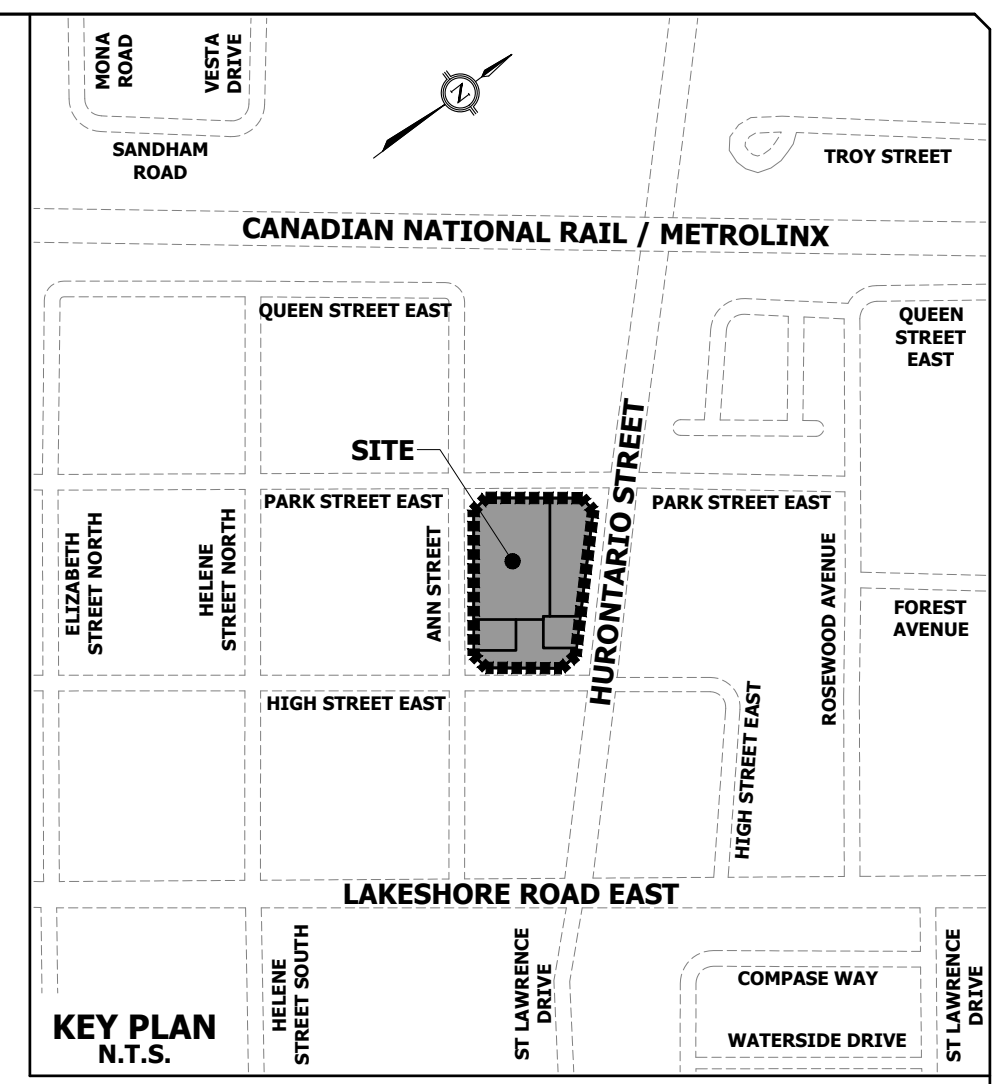
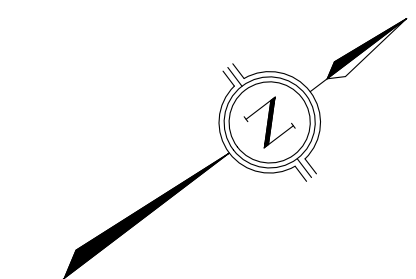
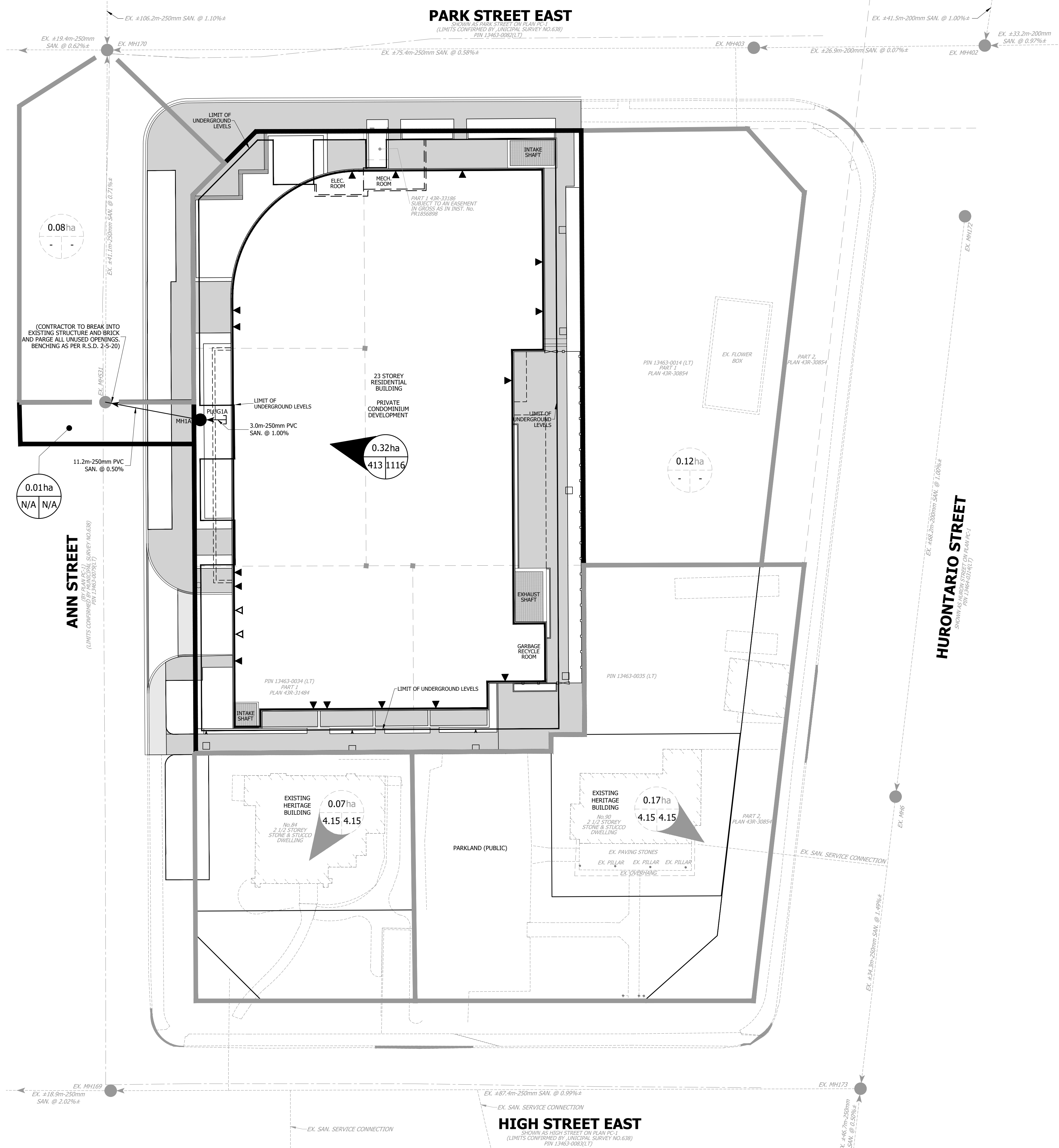

- LEGEND**
- SANITARY SEWER AND MANHOLE
  - EXISTING SANITARY SEWER AND MANHOLE
  - 0.32ha (ha)  
200 720 POPULATION
  - 0.03ha (ha)  
1 1 POPULATION
  - 0.03ha (ha)  
1 1 POPULATION PER UNIT
  - DRAINAGE AREA BOUNDARY
  - EXISTING DRAINAGE AREA BOUNDARY
  - LIMIT OF PROPERTY

**ELEVATION NOTE**  
ELEVATIONS SHOWN ON THIS PLAN ARE RELATED TO GEODETIC DATUM AND ARE DERIVED FROM THE CITY OF MISSISSAUGA BENCHMARKS:  
No. 72: ELEVATION=76.12m  
No. 73: ELEVATION=61.38m

**BENCHMARK NOTE**  
LB#1 SANITARY MANHOLE 0.696m FROM THE CENTER LINE OF THE ROAD AT THE INTERSECTION OF ANN STREET AND HIGH STREET.  
ELEVATION=86.36m  
LB#2 SANITARY MANHOLE 1.345m FROM THE CENTER LINE OF THE ROAD AT THE INTERSECTION OF PARK STREET AND HURONTARIO STREET.  
ELEVATION=82.51m

TOPOGRAPHIC SURVEY PREPARED BY J.D. BARNES LIMITED, JANUARY 28, 2020.

ISSUED FOR 3RD ROUND SUBMISSION DATE: APR. 19, 2023	ISSUED FOR OPA & REZONING SUBMISSION DATE: AUG. 02, 2023	REVISED GRADING DATE: JAN. 19, 2024	4TH ROUND OPA & REZONING DATE: JUN. 19, 2024
--	---	--	---



**Urbantech Consulting**  
A Division of Leighton-Zec West Ltd.  
2030 Bristol Circle, Suite 105  
Oakville, ON, L6H 0H2  
TEL: 905.829.8818 • urbantech.com

**10 WEST GO GP INC.**  
17 & 19 ANN STREET, 84 & 90 HIGH STREET  
OZ OPA 22-3

**Region of Peel**  
working with you

**MISSISSAUGA**

**SANITARY DRAINAGE PLAN**

REGION FILE No. XXX	CITY FILE No. XXX
SCALE: 1:250	AREA: Z-08-C5/D
DRAWN BY: A.G.	CHECKED BY: R.M./R.B.T.M
DATE: APRIL 2023	SHEET: OF
PROJECT No. 19-241	PLAN No. <b>301</b>

File: F:\PROJECTS\19-241 (ANN & HIGH STREET)\03 DRAWINGS\300 - DRAINAGE\301 - SANITARY DRAINAGE PLAN.DWG