

LEGEND:

R 4 -CUBIC YARD FRONT-END BIN - RECYCLABLES

G 4 -CUBIC YARD FRONT-END BIN - MIXED WASTE

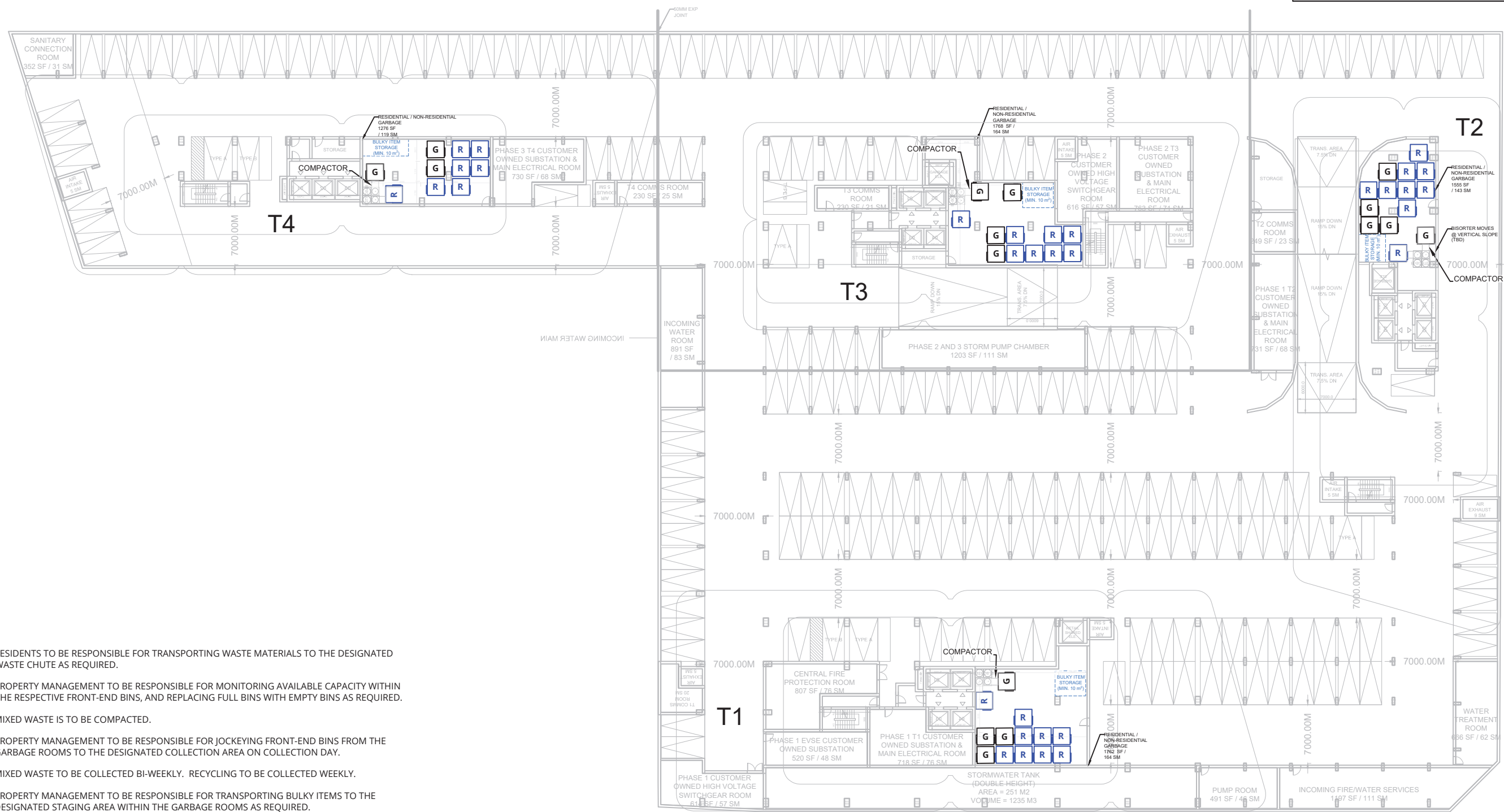

- NOTES:**
1. RESIDENTS TO BE RESPONSIBLE FOR TRANSPORTING WASTE MATERIALS TO THE DESIGNATED WASTE CHUTE AS REQUIRED.
 2. PROPERTY MANAGEMENT TO BE RESPONSIBLE FOR MONITORING AVAILABLE CAPACITY WITHIN THE RESPECTIVE FRONT-END BINS, AND REPLACING FULL BINS WITH EMPTY BINS AS REQUIRED.
 3. MIXED WASTE IS TO BE COMPACTED.
 4. PROPERTY MANAGEMENT TO BE RESPONSIBLE FOR JOCKEYING FRONT-END BINS FROM THE GARBAGE ROOMS TO THE DESIGNATED COLLECTION AREA ON COLLECTION DAY.
 5. MIXED WASTE TO BE COLLECTED BI-WEEKLY. RECYCLING TO BE COLLECTED WEEKLY.
 6. PROPERTY MANAGEMENT TO BE RESPONSIBLE FOR TRANSPORTING BULKY ITEMS TO THE DESIGNATED STAGING AREA WITHIN THE GARBAGE ROOMS AS REQUIRED.
 7. PROPERTY MANAGEMENT TO BE RESPONSIBLE FOR TRANSPORTING BULKY ITEMS FROM THE HOLDING AREA TO THE DESIGNATED COLLECTION AREA ON COLLECTION DAY.
 8. BULKY ITEMS TO BE COLLECTED ON THE SAME DAY AS GARBAGE-ONLY COLLECTION, SUCH THAT SUFFICIENT SPACE IS AVAILABLE WITHIN THE COLLECTION AREA.
 9. BASE PLAN PROVIDED BY 3XN GXN (2024).



Recyclables and Mixed Waste Storage Plan - P1 Level
 Solid Waste Management Plan, 3085 Hurontario St., Mississauga, ON

Mattamy Homes Canada



Drawn by: TFB	Figure: 1
Approx. Scale: 1:500	
Date Revised: Aug. 15, 2024	



Project #2409661

V:\gen\csl\01\vol\m\job-df\03\2024\2409661\WasteManagement\20240815_PWD\2409661_Waste P1_3085HurontarioStoragePlan.dwg, P01, 8/15/2024 12:21:59 PM