

**LEGEND**

- LIMIT OF PROPERTY
  - PROPOSED STORM SEWER
  - PROPOSED STORM SEWER (B.O.)
  - EXISTING STORM SEWER
  - PROPOSED SANITARY SEWER
  - PROPOSED SANITARY SEWER (B.O.)
  - PROPOSED EXTERNAL SANITARY SEWER
  - EXISTING SANITARY SEWER
  - PROPOSED WATERMAIN
  - EXISTING WATERMAIN
- 
- |            |                     |
|------------|---------------------|
| STM.MH2    | STORM MANHOLE ID    |
| TOP 90.70m | GROUND ELEVATION    |
| S 85.00m   | STORM SEWER INVERTS |
| E 85.00m   |                     |
| W 85.00m   |                     |
| N 85.00m   |                     |
- 
- |            |                        |
|------------|------------------------|
| SAN.MH5A   | SANITARY MANHOLE ID    |
| TOP 90.75m | GROUND ELEVATION       |
| S 85.00m   | SANITARY SEWER INVERTS |
| E 85.00m   |                        |
| W 85.00m   |                        |
| N 85.00m   |                        |

**BENCHMARK**  
 ELEVATIONS ARE GEODETIC AND ARE REFERRED TO CITY OF MISSISSAUGA VERTICAL BENCH MARK NUMBER 1001 HAVING AN ORTHOMETRIC ELEVATION OF 123.221 METRES. ELEVATIONS ARE REFERENCED TO THE CANADIAN GEODETIC VERTICAL DATUM OF 1928, PRE-1978 ADJUSTMENT (CGVD: 1928: PRE-78ADJ.).  
 TABLET SET HORIZONTALLY AT THE BASE OF A 750MM CONCRETE TRAFFIC POLE ON THE SOUTH SIDE OF HURONTARIO AVENUE, WEST OF CENTERLINE OF THE EASTERLY GO STATION ENTRANCE.

**URBANTECH® Consulting**  
 A Division of Leighton-Zec West Ltd.  
 2030 Bristol Circle, Suite 105  
 Oakville, ON, L6H 0H2  
 TEL 905.829.8818 • urbantech.com

**3085 HURONTARIO STREET**  
 CITY OF MISSISSAUGA

**SERVICING PLAN**

PROJECT No.	DATE	SCALE	DWG No.
20-653	SEPT. 2024	1:500	SER-1

F:\PROJECTS\20453\3085\_HURONTARIO-MISSISSAUGA-COONSVILLE\DRAWINGS\100 - CIVIL & GENERAL SERVICES.DWG

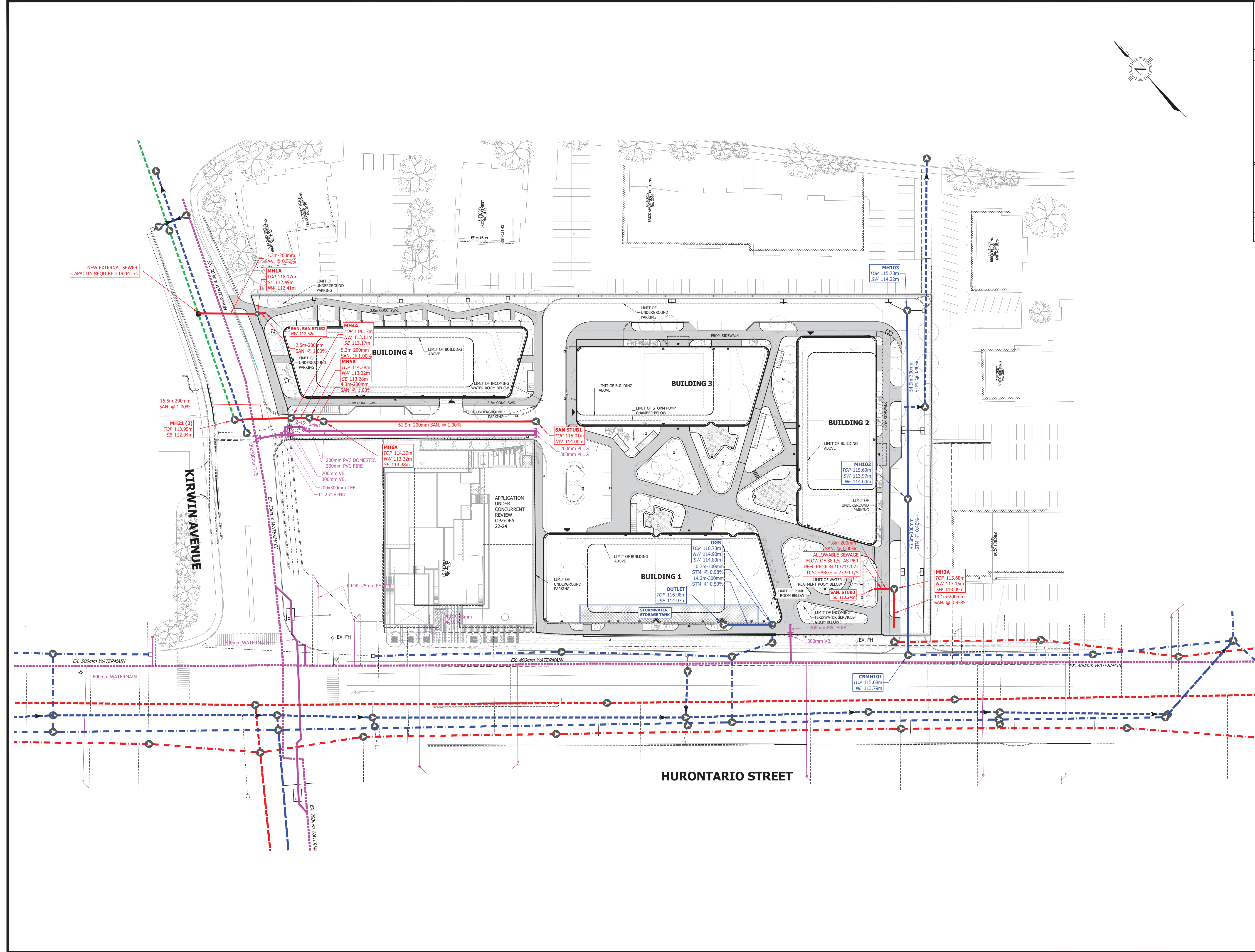

NEW EXTERNAL SEWER  
 CAPACITY REQUIRED 19.44 L/S

MH21 (2)  
 TOP 113.95m  
 SE 112.94m

MH1A  
 TOP 118.17m  
 SE 112.49m  
 NW 112.41m

SAN SAN STUB2  
 TOP 112.52m  
 NW 112.52m  
 SAN. @ 1.00%

MH4A  
 TOP 114.17m  
 NW 112.11m  
 SE 113.17m  
 SAN. @ 1.00%

MH5A  
 TOP 114.28m  
 NW 113.22m  
 SE 113.28m  
 SAN. @ 1.00%

MH6A  
 TOP 114.39m  
 NW 113.32m  
 SE 113.38m

SAN STUB1  
 TOP 115.01m  
 NW 114.00m  
 200mm PLUG  
 300mm PLUG

OGS  
 TOP 116.73m  
 NW 114.90m  
 SW 114.80m  
 0.7m-300mm  
 STM. @ 0.98%  
 14.2m-300mm  
 STM. @ 0.50%

ALLOWABLE SEWAGE  
 FLOW OF 38 L/S AS PER  
 PEEL REGION 10/21/2022  
 DISCHARGE = 23.94 L/S

MH3A  
 TOP 115.68m  
 NW 113.15m  
 SW 113.09m  
 10.1m-200mm  
 SAN. @ 0.95%

CBMH101  
 TOP 115.68m  
 NE 113.79m