

1. MEASUREMENTS IN METRES AND/OR MILLIMETRES UNLESS OTHERWISE SHOWN.  
 2. CONTRACTOR TO BE RESPONSIBLE FOR LOCATION OF ALL EXISTING UNDERGROUND & OVERHEAD UTILITIES. VARIOUS UTILITIES CONCERNED TO BE GIVEN REQUIRED ADVANCE NOTICE PRIOR TO ANY DIGGING, FOR STAKE OUT. THE CONSULTANT ASSUMES NO RESPONSIBILITY FOR THE ACCURACY OF THE LOCATION OF EXISTING UTILITIES AS INDICATED ON THIS DRAWING.  
 3. THE INFORMATION CONTAINED ON THIS PLAN PERTAINS TO THE INSTALLATION OF NEW MUNICIPAL SERVICING ONLY AND SHALL NOT BE RELIED UPON BY A THIRD PARTY FOR ANY OTHER DESIGN AND/OR CONSTRUCTION RELATED PURPOSES (INCLUDING PUBLIC & PRIVATE SERVICING/UTILITY LOCATES, SHORING DESIGN AND FIELD LAYOUT, UTILITY DESIGN AND CONSTRUCTION, AND ALL OTHER DESIGN AND CONSTRUCTION RELATED ACTIVITIES). ALL THIRD PARTIES ARE RESPONSIBLE FOR OBTAINING THEIR OWN LOCATES FOR ANY PUBLICLY OR PRIVATELY HELD INFRASTRUCTURE WITHIN OR ADJACENT TO THE SUBJECT DEVELOPMENT.

| No. | REVISIONS/ISSUED       | DATE       | BY   | CITY |
|-----|------------------------|------------|------|------|
| 2.  | ISSUED FOR OPA/DPOS #2 | 10/25/2023 | K.L. |      |
| 1.  | ISSUED FOR OPA/ZBA #1  | 07/29/2022 | K.L. |      |

**counterpoint ENGINEERING**

COUNTERPOINT ENGINEERING INC.  
 8395 Jane St., Suite 100, Vaughan, ON L4K 5Y2 Phone 905.326.1404 Fax 905.326.1405

**LICENSED PROFESSIONAL ENGINEER**  
 K.Ly  
 100190179  
 OCT 25, 2023  
 PROVINCE OF ONTARIO

APPLICANT:  
**HAZELVIEW INVESTMENTS**  
 1133 YONGE STREET, 4TH FLOOR  
 TORONTO, ON M4T 1W1  
 PHONE: 1-888-949-8439

CONTACT: DEREK WEI - dwei@hazelview.com

SITE LOCATION:  
**RESIDENTIAL/COMMERCIAL DEVELOPMENT**  
 DUNDAS & MATTAWA  
 1580-1590 & 1650 DUNDAS STREET EAST  
 MISSISSAUGA, ON  
 SITE PLAN FILE No.:

**POST-DEVELOPMENT DRAINAGE PLAN**

DESIGNED BY: K.L. CHECKED BY: D.L. DATE: OCTOBER 2023  
 DRAWING BY: K.L. CHECKED BY: D.L. PROJECT NO.: 20129  
 SWM BY: K.L. CHECKED BY: D.L.

SCALE: 1:500m 0m 5m 10m 20m 30m DRAWING NO. SWM2A

REGION FILE No.:

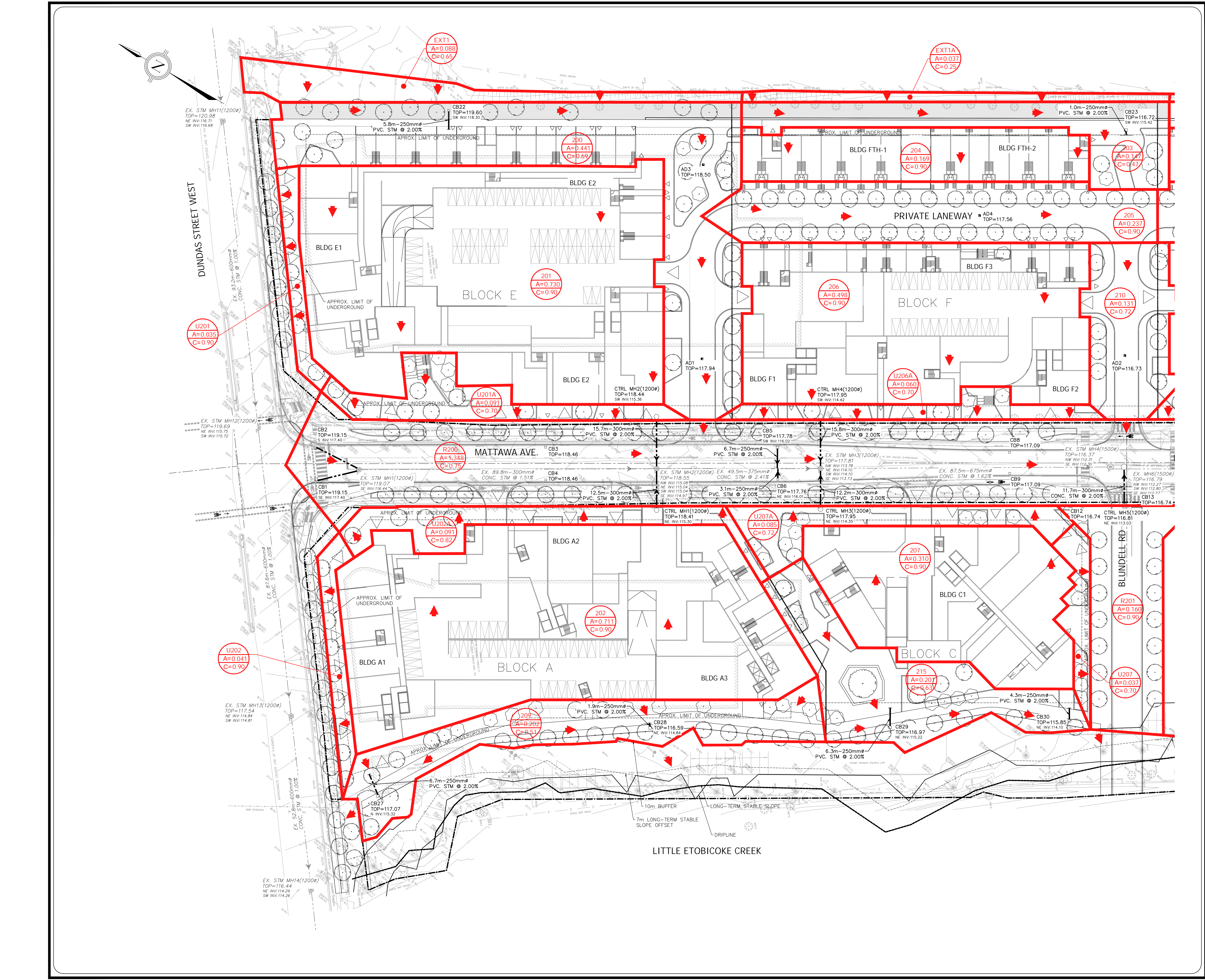

REGION FILE No.: