

FUTURE METROLINX LRT STATION

HuLRT PORT CREDIT STATION
NOT INCLUDED IN APPLICATION

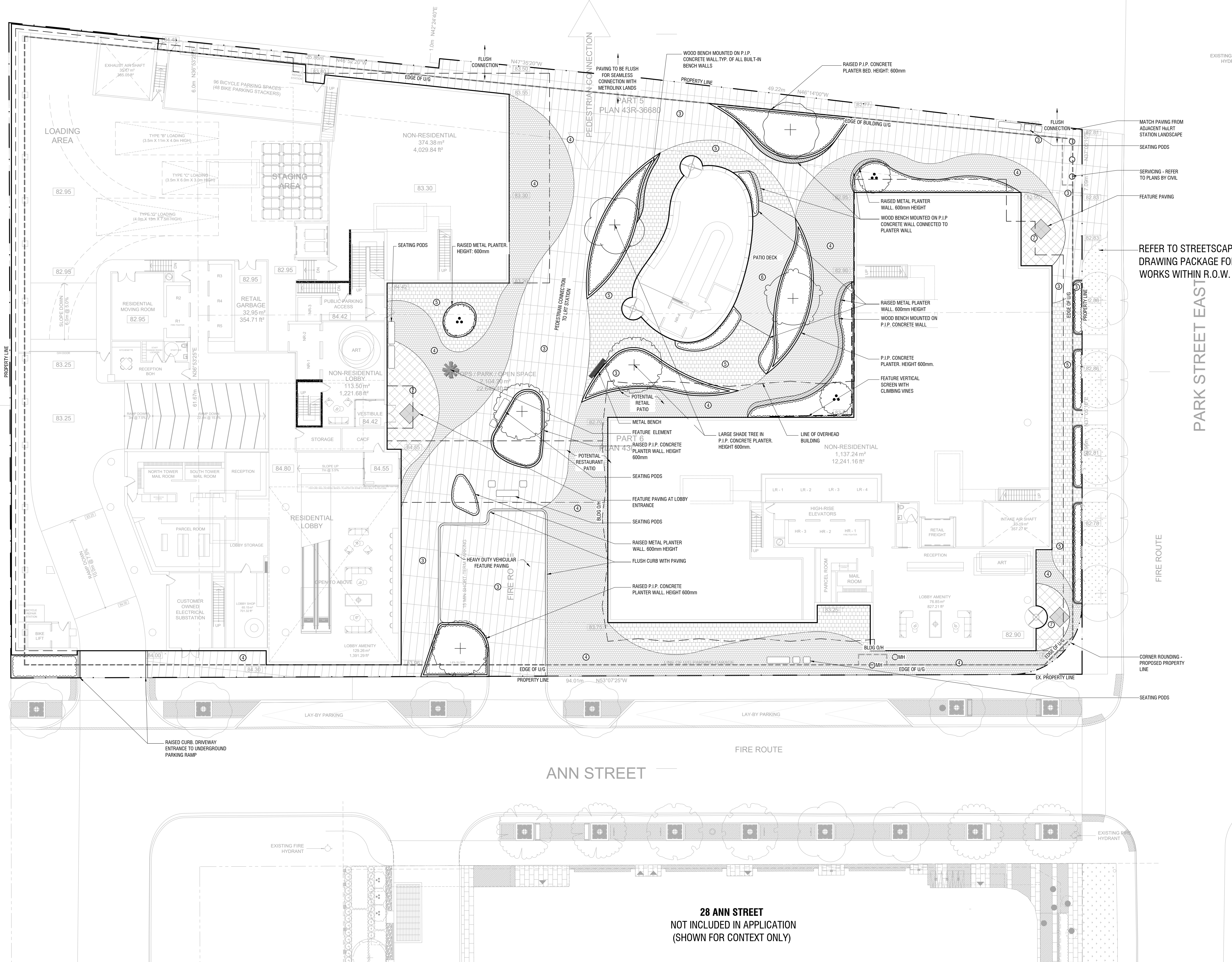

LEGEND - PAVING

	PIP Concrete Paving - Pedestrian Colour: Natural SR: >0.33	1 L-300
	PIP Concrete Paving - Heavy-Duty Colour: Natural SR: >0.33	2 L-300
	Feature Paving Match Metrolinx Landscape Paving	
	Pedestrian Strength Unit Paving Spec: T.B.D. Colour: T.B.D. SR: T.B.D.	5 L-300
	Pedestrian Strength Unit Paving Spec: T.B.D. Colour: T.B.D. SR: T.B.D.	5 L-300
	Wood Look Unit Paving Spec: T.B.D. Pattern: Running Bond as shown in plan SR: T.B.D.	5 L-300
	Pedestrian Strength Square Slab Unit Paving Spec: T.B.D. Pattern: Running Bond as shown in plan Colour: T.B.D. SR: T.B.D.	5 L-300



Owner: Edenshaw Queen Developments
 Owner's Address: 129 Lakeshore Rd E, Suite 201, 2nd Floor
 Mississauga, Ontario L4Z 1T5
 Fax Number: (905) 890-9501
 Tel. Number: (905) 990-3500
 Architect - CORE Architects
 Civil Eng - WSP
 Mech Eng & Elect Eng - MCW
 Interior -
 Wind - RWDI
 Structural - Entuitive
 Transportation - LEA
 Planning - Sajecki Planning

- GENERAL NOTES**
- All dimensions in millimetres (mm)
 - Verify all dimensions
 - Do not scale drawings
 - Check drawings against specifications
 - Use the latest revised drawings only
 - Report any discrepancies to the Landscape Architect before proceeding
 - Drawings and specifications are the property of the Landscape Architect, and must be returned upon completion of the work

2	JUN.16.2023	Iss. for OPA/ZBA	RH
1	FEB.04.2022	Iss. for OPA/ZBA	AAM
REV	DATE	DESCRIPTION	INITIAL

Ground Floor Landscape Plan

DRAWN BY: AAM
 CHECKED BY: JVV
 PRINT DATE: Jun.16.2023

L-100

88 Park St. East

Port Credit (Mississauga) ON
 Edenshaw Queen Developments Limited
 Site Plan Number: LAD-512
 DEC.08.2021

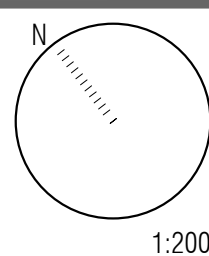

28 ANN STREET
NOT INCLUDED IN APPLICATION
(SHOWN FOR CONTEXT ONLY)

REFER TO STREETSCAPE
DRAWING PACKAGE FOR
WORKS WITHIN R.O.W.

PARK STREET EAST

FIRE ROUTE

ANN STREET

FIRE ROUTE

RAISED CURB DRIVEWAY
ENTRANCE TO UNDERGROUND
PARKING RAMP

EXISTING FIRE
HYDRANT

EXISTING FIRE
HYDRANT