

FUTURE METROLINX LRT STATION

HuLRT PORT CREDIT STATION
NOT INCLUDED IN APPLICATION

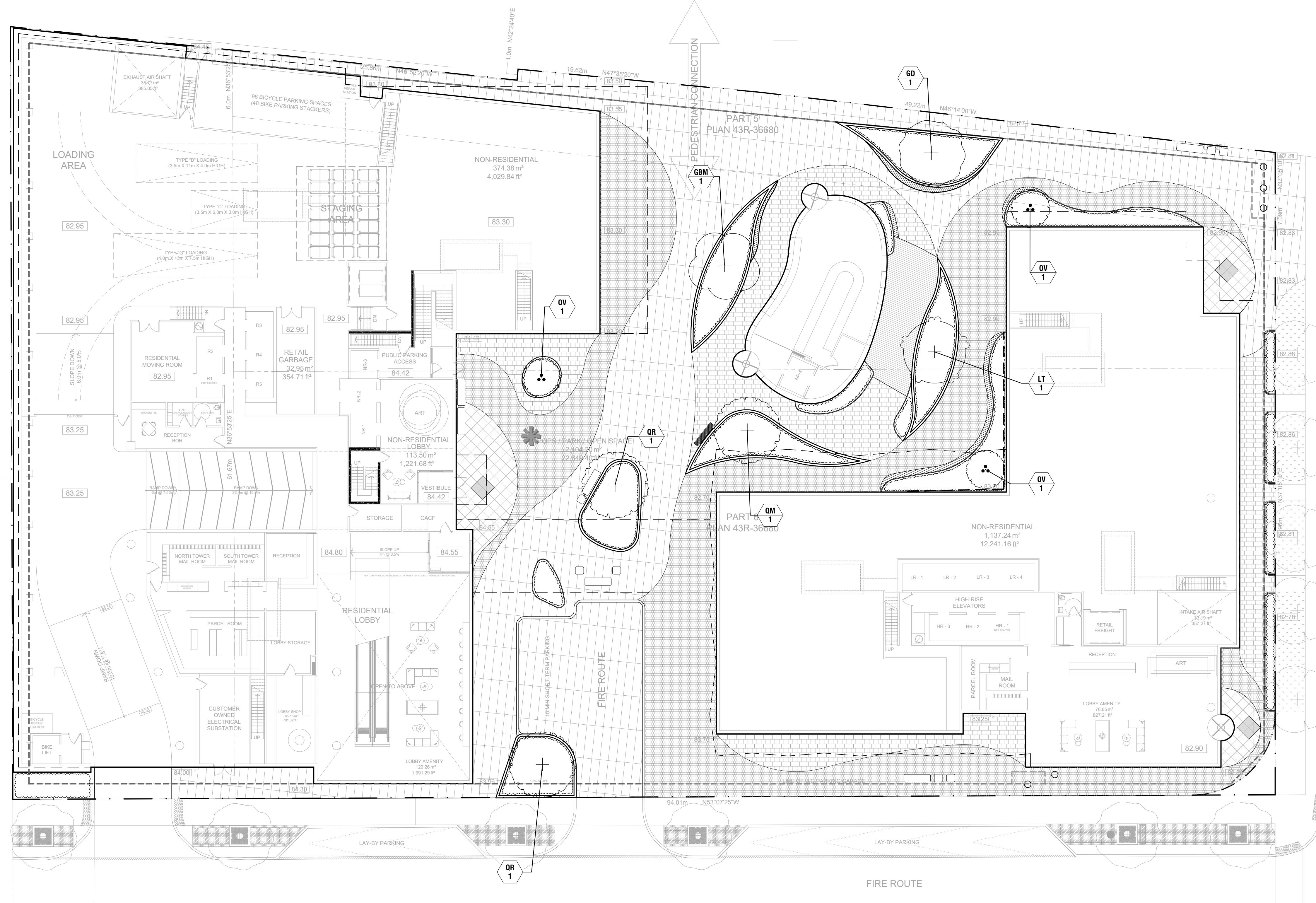

PARK STREET EAST

FIRE ROUTE

FIRE ROUTE

PLANT SCHEDULE

DECIDUOUS TREES	QTY	BOTANICAL NAME	COMMON NAME	CONT	CAL	NATIVE	REMARKS
GBM	1	Ginkgo biloba 'Magyar'	Magyar Maidenhair Tree	W.B.	70mm Cal.		
GD	1	Gymnocladus dioica	Kentucky Coffeetree	W.B.	70mm Cal.	Native	
LT	1	Liriodendron tulipifera	Tulip Tree	W.B.	70mm Cal.	Native	
QM	1	Quercus macrocarpa	Burr Oak	W.B.	70mm Cal.	Native	Spring-Dug Only
QR	2	Quercus rubra	Red Oak	W.B.	70mm Cal.	Native	Spring-Dug Only
ORNAMENTAL TREES	QTY	BOTANICAL NAME	COMMON NAME	CONT	CAL	NATIVE	REMARKS
OV	3	Ostrya virginiana	American Hophornbeam	W.B.	60mm Cal.	Native	Multistem

*DETAILED PLANTING PLAN INCLUDING UNDERSTORY PLANTING (SHRUBS, PERENNIALS, AND GRASSES) TO BE PROVIDED AT SPA

CITY OF MISSISSAUGA
SITE PLAN APPROVAL STAMP

LANDART DESIGN
landscape architects inc.

52 Mimico Avenue, Studio B
Toronto ON M8V 1R1
T: 416-840-0039
www.landartdesign.ca

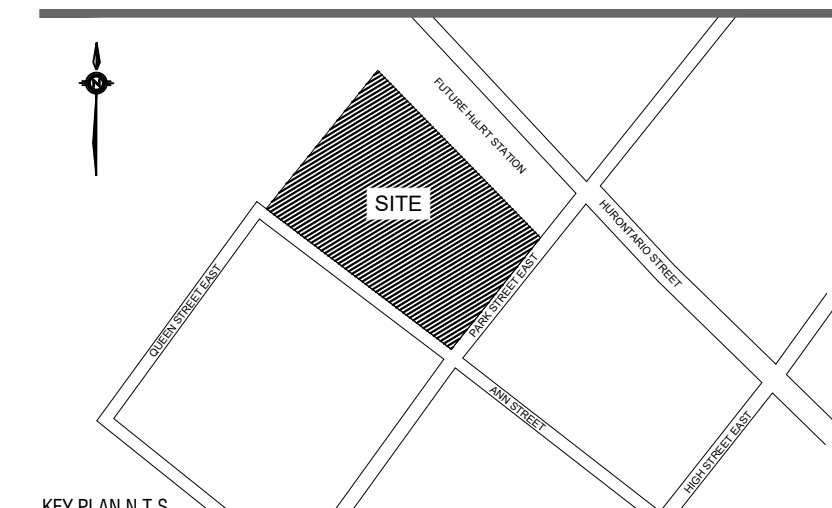

KEY PLAN N.T.S.

Owner: Edenshaw Queen Developments
Owner's Address: 129 Lakeshore Rd E, Suite 201, 2nd Floor
Mississauga, Ontario L4Z 1T5

Fax Number: (905) 890-9501
Tel. Number: (905) 990-3500
Architect - CORE Architects
Civil Eng - WSP
Mech Eng & Elect Eng - MCW
Interior -
Wind - RWDI
Structural - Entuitive
Transportation - LEA
Planning - Sajecki Planning

- GENERAL NOTES**
- All dimensions in millimetres (mm)
 - Verify all dimensions
 - Do not scale drawings
 - Check drawings against specifications
 - Use the latest revised drawings only
 - Report any discrepancies to the Landscape Architect before proceeding
 - Drawings and specifications are the property of the Landscape Architect, and must be returned upon completion of the work

REV	DATE	DESCRIPTION	INITIAL
2	JUN.16.2023	Iss. for OPA/ZBA	RH
1	FEB.04.2022	Iss. for OPA/ZBA	AAM

Ground Floor Planting Plan

DRAWN BY: AAM
CHECKED BY: JWV
PRINT DATE: Jun.16.2023

L-101

88 Park St. East
Port Credit (Mississauga) ON
Edenshaw Queen Developments Limited
Site Plan Number: LAD-512
DEC.08.2021

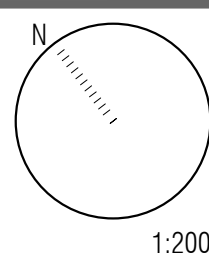

1:200