

STORM SEWER STRUCTURE SUMMARY TABLE				
STM MH	MH SIZE (CIRCULAR)	TOP EL.	IN INV.	OUT INV.
MH101	1200mm (OPSD 701.010)	112.91	111.650	
MH102	1200mm (OPSD 701.010)	113.21	111.734	111.684
MH103	1200mm (OPSD 701.010)	114.49	111.836	111.786
MH104	1200mm (OPSD 701.010)	115.47	112.263	112.213
MH105	1200mm (OPSD 701.010)	116.24	112.937	112.857
MH106	1200mm (OPSD 701.010)	116.23	113.039	112.989
MH107	1200mm (OPSD 701.010)	116.28	113.124	113.074
MH108	1500mm (OPSD 701.011)	116.52	113.668	113.443
MH109	1200mm (OPSD 701.010)	116.33	114.109	113.834
MH110	1200mm (OPSD 701.010)	116.06	114.332	114.207
MH111	1200mm (OPSD 701.010)	116.02	114.414	114.364
MH112	1200mm (OPSD 701.010)	116.14		114.464
MH113	1200mm (OPSD 701.010)	116.45	113.837	113.787
MH114	1200mm (OPSD 701.010)	116.37	113.922	113.872
MH115	1200mm (OPSD 701.010)	116.25	114.035	113.985
MH116	1200mm (OPSD 701.010)	116.06		114.179
MH117	1200mm (OPSD 701.010)	116.27		114.229
OGS 1	EFO10 (OR APPROVED EQUIV.)	116.45	112.767	112.687

SANITARY SEWER STRUCTURE SUMMARY TABLE				
SAN MH	MH SIZE	TOP EL.	IN INV.	OUT INV.
Ex. SAN PLUG	250mm PLUG	112.91	111.840	
MH101A	1200mm (OPSD 701.010)	116.65	112.147	112.097
MH102A	1200mm (OPSD 701.010)	116.32	112.559	112.469
MH103A	1200mm (OPSD 701.010)	116.08	112.918	112.858
MH104A	1200mm (OPSD 701.010)	116.06	113.022	112.962
MH105A	1200mm (OPSD 701.010)	116.13	113.112	113.162
MH106A	1200mm (OPSD 701.010)	116.23	112.835	112.775
MH107A	1200mm (OPSD 701.010)	116.06	113.071	113.011
MH108A	1200mm (OPSD 701.010)	116.25	113.561	113.561
MH109A	1200mm (OPSD 701.010)	116.51	112.402	112.372
MH110A	1200mm (OPSD 701.010)	116.27	112.674	112.644
MH111A	1200mm (OPSD 701.010)	116.32	113.099	112.949
MH112A	1200mm (OPSD 701.010)	116.27	113.119	113.059
MH113A	1200mm (OPSD 701.010)	116.23	113.270	113.270
MH114A	1200mm (OPSD 701.010)	116.48	113.254	113.254

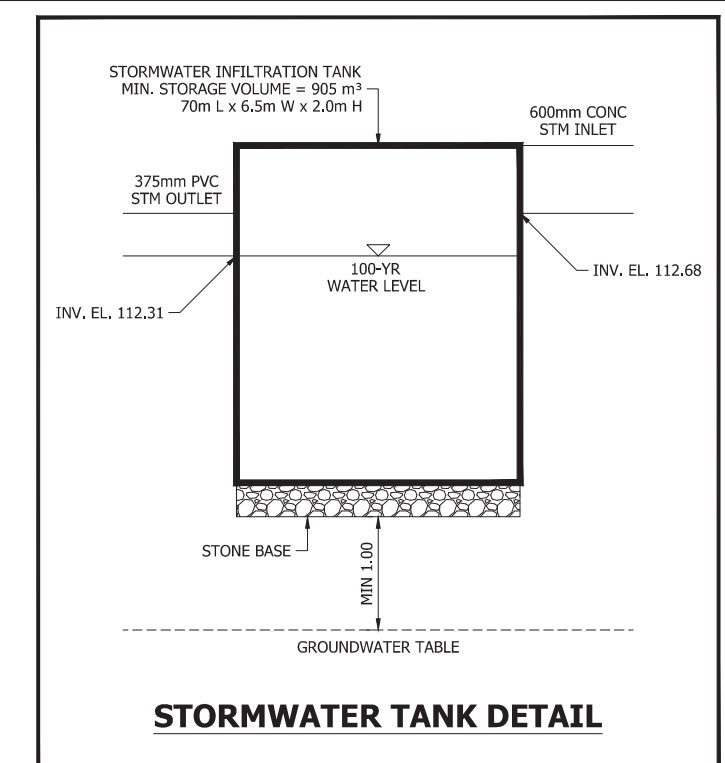

**SWM DESIGN SUMMARY**  
 QUANTITY CONTROL  
 MINIMUM REQUIRED STORAGE VOLUME = 90 m³  
 QUALITY CONTROL  
 OGS 1 (EFO10 OR APPROVED EQUIVALENT)

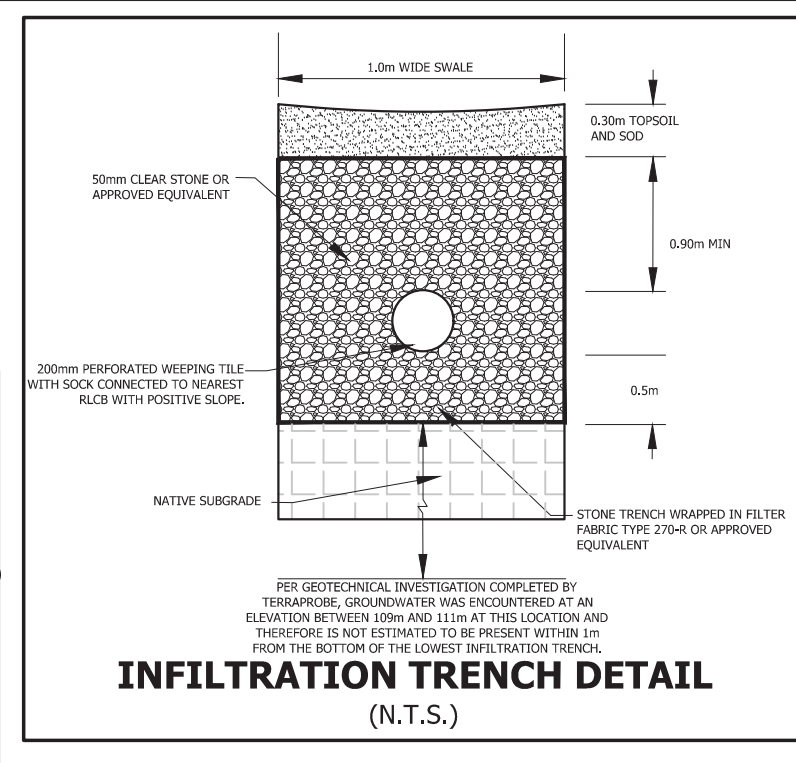
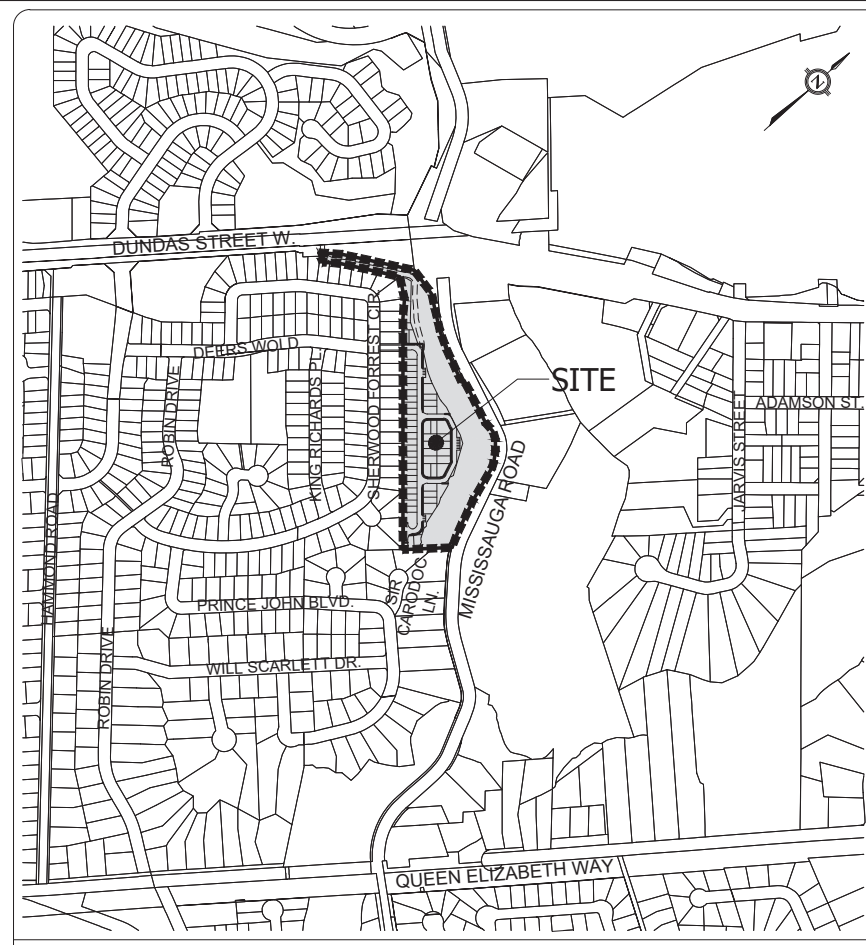

**LEGEND**  
 1:10,000

- PROPERTY BOUNDARY
- EXISTING WOODLOT
- 10m WIDE NHS BUFFER
- ROAD WIDENING
- NATURAL FEATURE STAKE BY CVC AND CITY (AUGUST 3, 2018)
- TOP OF BANK STAKED BY CVC AND CITY (AUGUST 3, 2018)
- TOP OF BANK FROM R-PE TOPOGRAPHIC SURVEY
- LONG TERM STABLE SLOPE LINE BY CONSULTANTS (JULY 2023)
- DEVELOPMENT LIMIT
- STORM SEWER AND MANHOLE
- SANITARY SEWER AND MANHOLE
- WATERMAIN
- EXISTING STORM SEWER AND MANHOLE
- EXISTING SANITARY SEWER AND MANHOLE
- EXISTING WATERMAIN
- DOUBLE SANITARY/STORM SERVICE CONNECTION
- SINGLE SANITARY/STORM SERVICE CONNECTION
- WATER CONNECTION
- CATCHBASIN / DOUBLE CATCHBASIN / AREA DRAIN
- INFILTRATION TRENCH
- HYDRANT AND VALVE
- VALVE AND BOX
- TRANSFORMER
- STREET LIGHT
- PEDESTAL

**BENCHMARK:**  
 ELEVATIONS ARE REFERRED TO CANADIAN GEODETIC VERTICAL DATUM-1928, AND WERE DERIVED FROM CITY OF MISSISSAUGA BENCHMARK No. 58, HAVING A PUBLISHED ELEVATION OF 108.293 METRES.

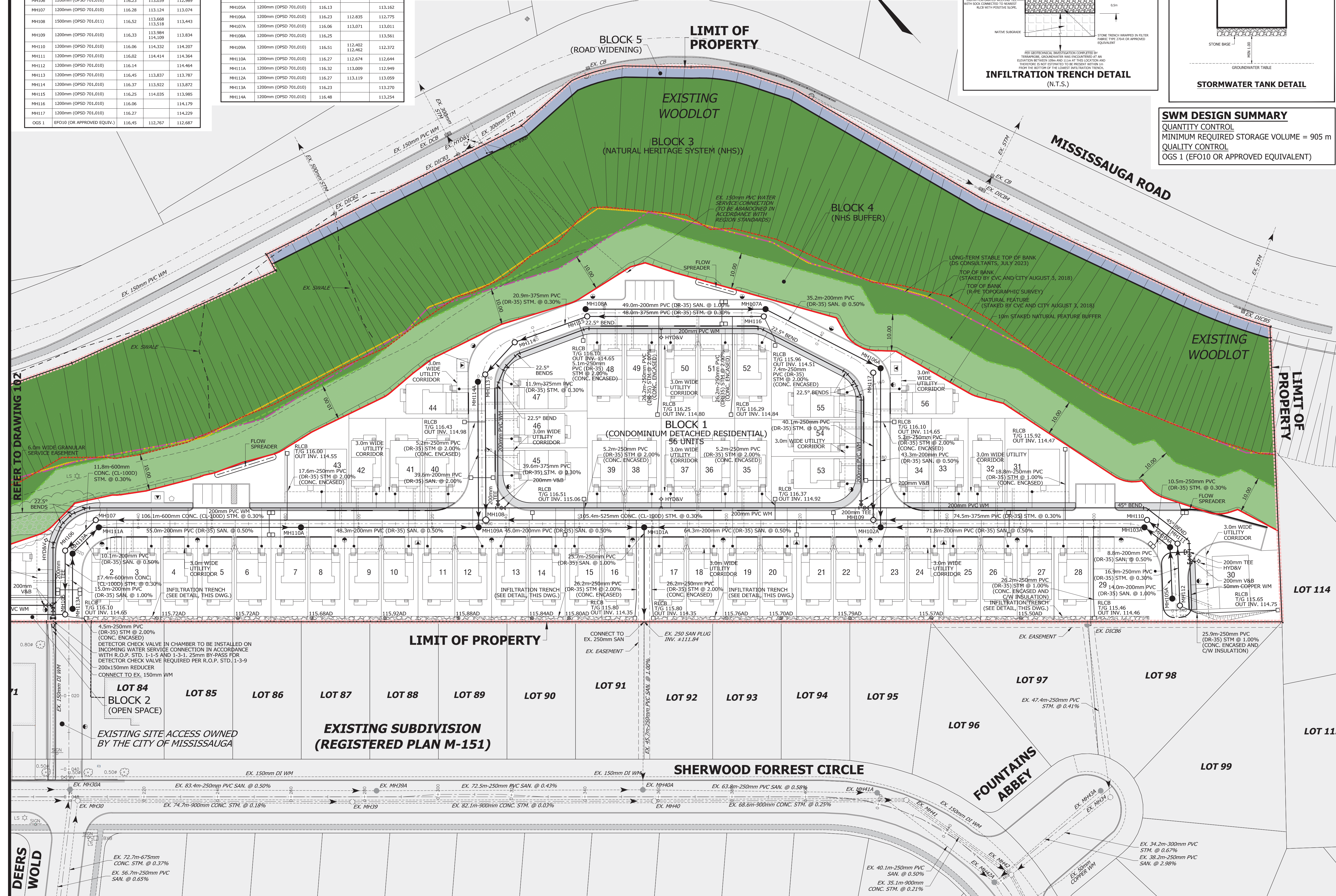

No.	REVISION	DATE	BY
3	THIRD SUBMISSION	MAY 24/24	J.S.
2	SECOND SUBMISSION	NOV. 11/23	J.S.
1	FIRST SUBMISSION	OCT. 2/23	J.S.

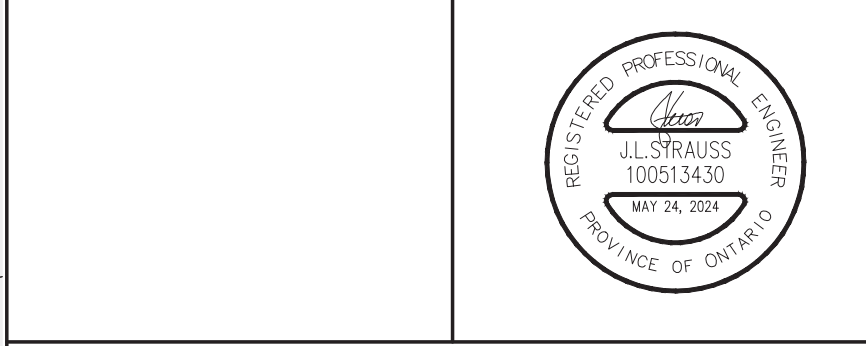

**URBANTECH® Consulting**  
 A Division of Leighton-Zec Ltd.  
 3760 14th Avenue, Suite 301,  
 Markham, ON, L3R 3T7  
 TEL. 905.946.9461 • urbantech.com

**1720 SHERWOOD FORREST CIRCLE**  
 CONDOMINIUM DETACHED RESIDENTIAL BLOCK  
 SHERWOOD FORREST LIMITED PARTNERSHIP  
 4900 PALLADIUM WAY, UNIT 105  
 BURLINGTON, ON, L7M 0W7  
 (905) 336-5545



**SERVICING PLAN (PART 1)**

PROJECT #:	23-747	DRAWING:	
SITE PLAN FILE No.:		SUBDIVISION FILE No.:	<b>C101</b>
CITY FILE No.:		REGION CONNECTION FILE No.:	
DESIGNED:	J.S.	CHECKED:	D.Z.
DRAWN:	J.S.	DATE:	AUGUST 2023
SCALE:	1:500		