

NOTE:
EXISTING PIPES (EAST ONLY)
TO BE PLUGGED AT MANHOLES
AND ABANDONED SEWERS TO
BE REMOVED

VENTURON DEVELOPMENT
CORPORATION
21T-87053-M

ROAD BASE
HL3 - 40mm
HL8 - 70mm
20mm C.R. LIMESTONE - 150mm
50mm C.R. LIMESTONE - 450mm
70mm

FILL NOTES
NOTES FOR SEWERS AND WATERMANS IN FILL AREAS
1. PIPES ARE NOT TO BE LAID ON FILL UNLESS THE FIELD
DENSITY TEST REPORTS HAVE BEEN SUBMITTED TO AND
APPROVED BY THE ENGINEER.
2. FILL TO BE PLACED TO A MINIMUM OF 800 mm ABOVE
THE SEWERS AND WATERMANS GRADES AND TO 3.0 m MINIMUM
ON EACH SIDE COMPACTED TO A MINIMUM OF 100% STANDARD
PROCTOR DENSITY IN 300 mm LIFTS.
3. TESTS SHALL BE TAKEN ALONG CENTRE LINE OF SEWER
OR WATERMAN AND ON INTERVALS OF 30.0 m ON EITHER SIDE
TO BE TAKEN AT EACH 300 mm LIFT.
NOTES FOR WATERMANS ONLY IN FILL AREAS
4. ALL HYDRANTS, TEE, BRANCH VALVES AND HORIZONTAL AND
VERTICAL SEWERS ARE TO BE SET WITH THE ROADS IN
ADDITION TO CONCRETE BLOCKING.
5. CONCRETE BLOCKING TO BE AS PER REGION OF P.E.I.
STANDARDS 11-3-3, 11-3-4, 11-3-5, 11-3-6 AND 11-3-7.
6. PIPE JOINT DEFLECTIONS ARE NOT ALLOWED IN FILL AREAS.

NOTE:
BEDDING FOR STORM &
F.D.C. SEWERS TO BE
CLASS 12 AS PER
CITY OF MISSISSAUGA
STD. 2-1-31.

NOTE:
WATER SERVICE CONNECTIONS FOR
LOTS 351 TO 363 (INCLUSIVE) TO BE
INSTALLED UNDER STORM SEWER.
SEE DETAIL ON DWG. 8814-A-47

BLOCK 366
SECONDARY SCHOOL

LISGAR DRIVE

INDIGO
CRESCENT

SERVICE DATA					
SERVICE	DATE	INIT.	SERVICE	DATE	INIT.
SAN SEWERS			GAS MAINS		
STORM SEWERS			BELL U/G CABLES		
WATERMANS			HYDRO U/G CABLES		

REVISIONS		
DATE	DETAILS	INIT.
93-12-22	AS CONSTRUCTED	KS

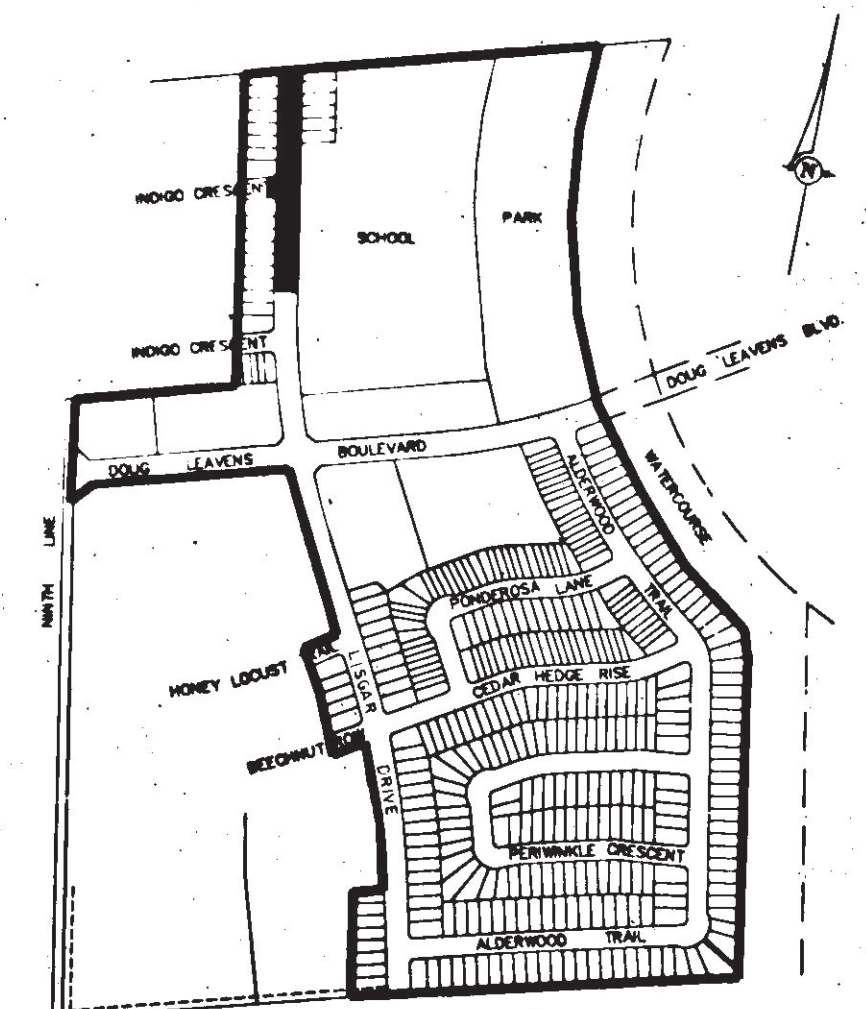

KEY PLAN
1:7500

▽ DOUBLE SERVICE CONNECTIONS
▽ SINGLE SERVICE CONNECTIONS SEE DETAIL ON DWG. 8814-A-47

FOR GENERAL NOTES SEE DWG. 8814-A-43

GENERAL NOTES

- ALL DRIVEWAYS ASPHALT UNLESS OTHERWISE NOTED.
- ALL SERVICE LOCATIONS ARE APPROXIMATE AND MUST BE LOCATED ACCURATELY IN FIELD.
- DENOTES BUILDING - NOT LOCATED
- DENOTES BUILDING - LOCATED
- T.T.B.M. No. 630 ELEV. 190.653m
- TEMP. BENCH MARK ELEV.
- DESCRIPTION. ON THE W. FACE AT THE S. END OF THE S.E. CONCRETE END POST OF A BRIDGE ON NINTH LINE, 228.6m N. OF BRITANNIA RD. W.

AS CONSTRUCTED 21 T-87071

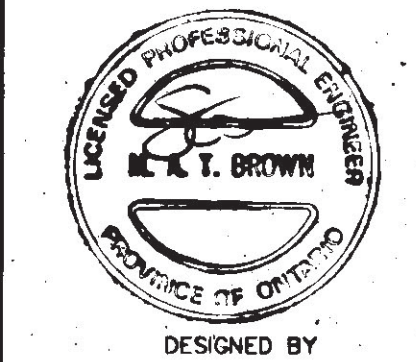

DESIGNED BY
APPROVED BY

SECOND TERRAGAR HOLDINGS LIMITED
PHASE I

paul theil associates limited
consulting engineers
21 Coventry Road, Brompton, Ontario L6T 4V7

MISSISSAUGA Public Works Department

LISGAR DRIVE

STN. 0+000 TO STA. 0+220

SCALE	HORIZ. 1:500	AREA	PROJECT No.
DRAWN BY	M. Rose	CHECKED BY	PLAN No. 8814-A-7
DATE	SEPT. 1991	SHEET	OF 21690-D

21690-D

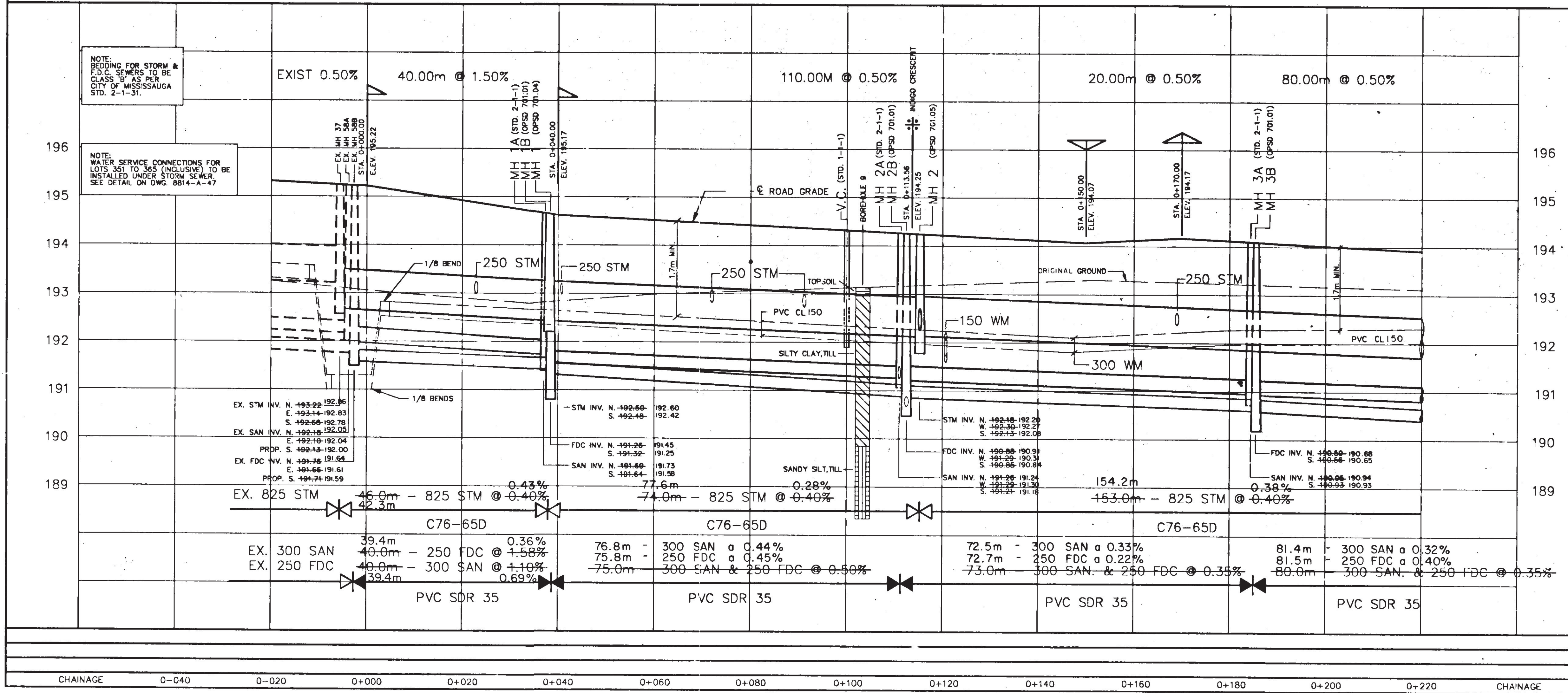

CHAINAGE	0-040	0-020	0+000	0+020	0+040	0+060	0+080	0+100	0+120	0+140	0+160	0+180	0+200	0+220	CHAINAGE
----------	-------	-------	-------	-------	-------	-------	-------	-------	-------	-------	-------	-------	-------	-------	----------