

- LEGEND**
- DRAFT PLAN LIMITS
  - SANITARY SEWER AND MANHOLE
  - STORM SEWER AND MANHOLE
  - EXISTING SANITARY SEWER AND MANHOLE
  - EXISTING STORM SEWER AND MANHOLE
  - EXISTING FDC SEWER AND MANHOLE
  - PROPOSED WATERMAIN
  - EXISTING WATERMAIN
  - REAR-LOT CATCHBASIN/ CATCHBASIN
  - HYDRANT & VALVE
  - EXISTING SERVICING EASEMENT (TO BE ABANDONED & LIFTED)
  - PROPOSED PARK / PVIOUS AREA

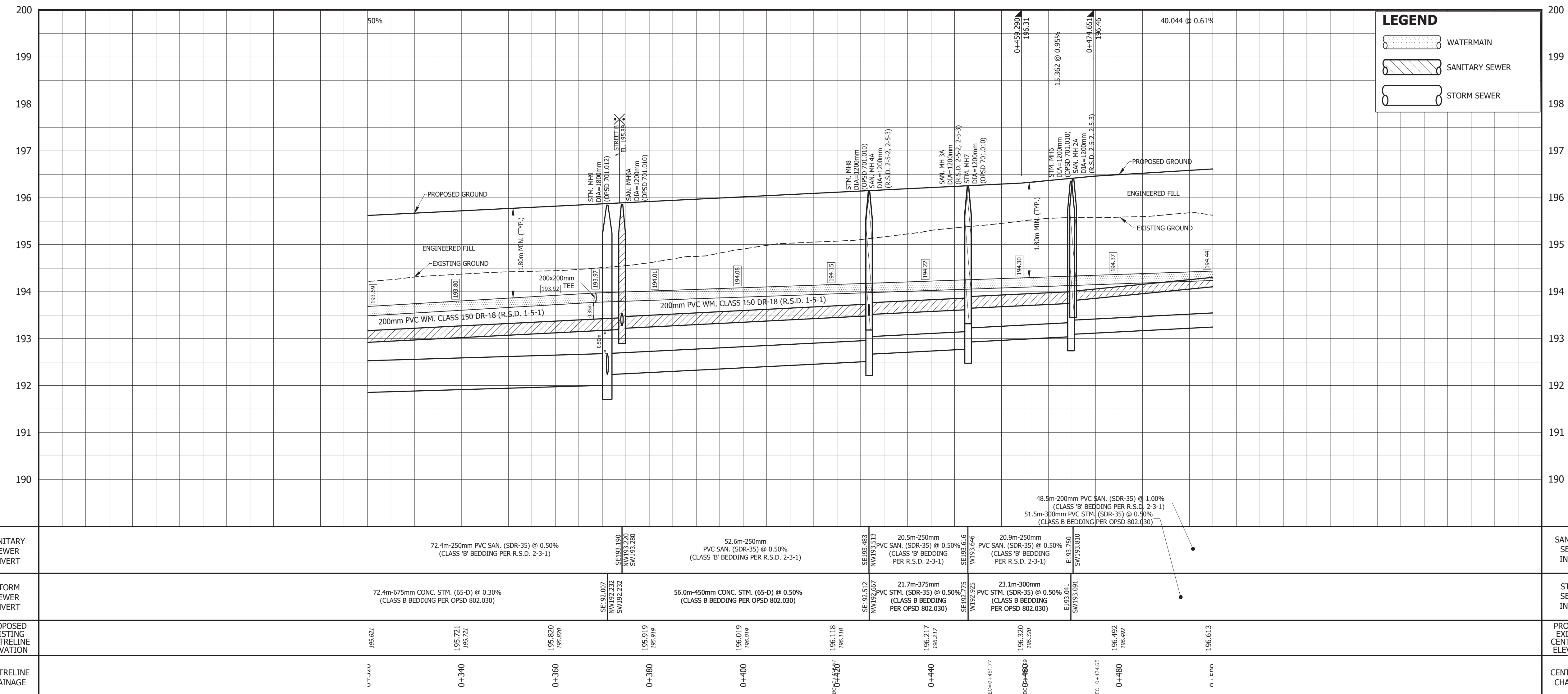

**NOTE**  
 \* DIMENSIONS ON THIS PLAN ARE MEASURED TO FACE OF THE CURB. FOR EDGE OF PAVEMENT DIMENSIONS PLEASE REFER TO CROSS SECTIONS ON DWG. 8

**BENCHMARK NOTE**  
 ELEVATIONS SHOWN ON THIS PLAN ARE RELATED TO GEOCIDIC DATUM AND ARE DERIVED FROM THE CITY OF MISSISSAUGA CONTROL MONUMENTS:  
 No. 075033003, ELEVATION=193.381m  
 No. 075033004, ELEVATION=193.755m  
 No. 075033009, ELEVATION=196.906m

No.	REVISION	DATE	BY	APPD
4				
3				
2	DARC RESUBMISSION	MAR. 2024	Y.P.	S.R.
1	1st FSR SUBMISSION	OCT. 2023	Y.P.	S.R.

**AVENIA CONSTRUCTION INC.**

Region of Peel  
working with you

**MISSISSAUGA**

CITY FILE No.	REGION FILE No.
---------------	-----------------

**URBANTECH**  
 Urbantech Consulting  
 A Division of Leighton-Zec Ltd.  
 3760 14th Avenue, Suite 301,  
 Markham, ON L3R 3T7  
 TEL 905.946.9461 • urbantech.com

**PLAN & PROFILE**  
**STREET B**  
 (STA. 0+320 TO STA. 0+500)

DESIGNED: Y.P.	CHECKED: S.R.	PROJECT No.: 23-748
DRAWN: Y.P.	DATE: OCTOBER 2023	SHEET No.:
SCALE: H 1:500 V 1:50		DRAWING No.: <b>PP-3</b>