

- LEGEND**
- DRAFT PLAN LIMITS
 -
 -
 -
 -
 -
 -
 -
 -
 -
 -
 -

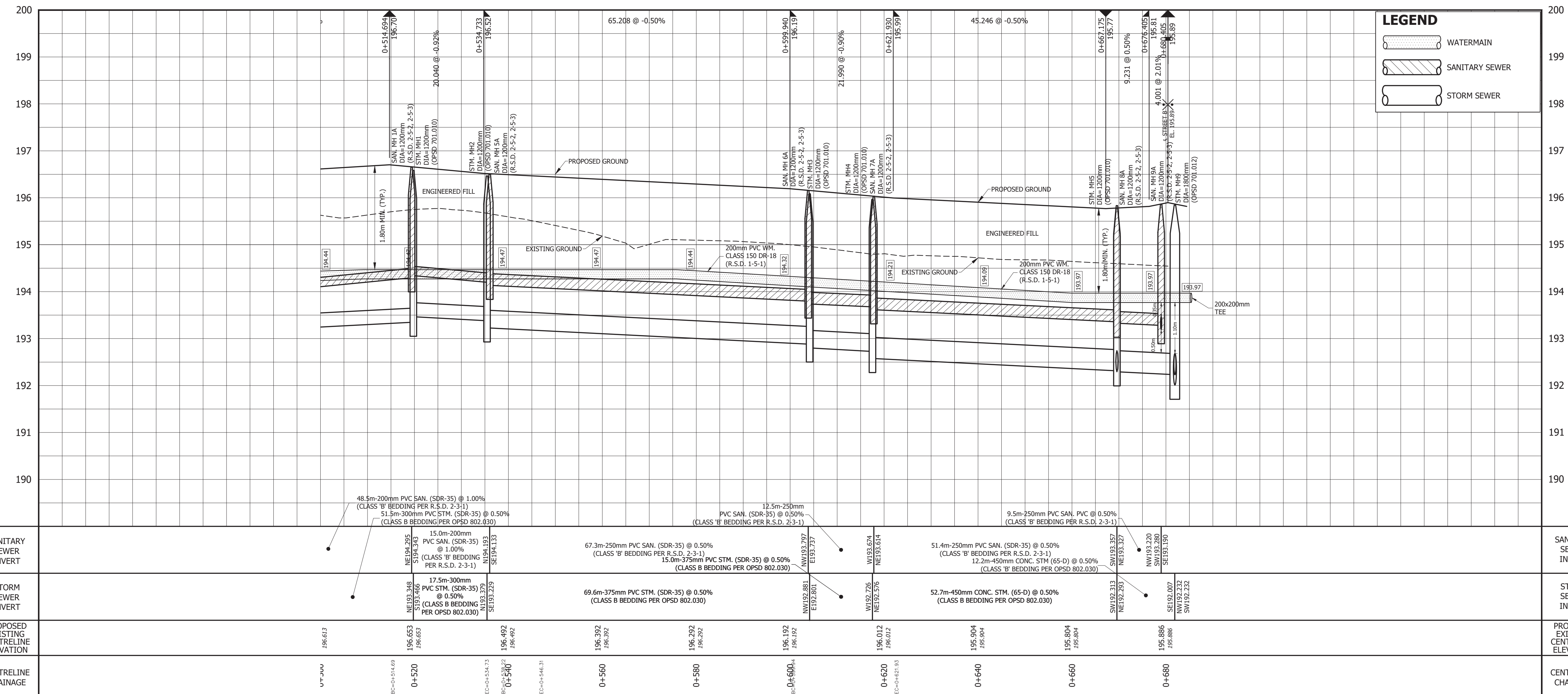

NOTE
 * DIMENSIONS ON THIS PLAN ARE MEASURED TO FACE OF THE CURB. FOR EDGE OF PAVEMENT DIMENSIONS PLEASE REFER TO CROSS SECTIONS ON DWG. 8

BENCHMARK NOTE
 ELEVATIONS SHOWN ON THIS PLAN ARE RELATED TO GEOCIDIC DATUM AND ARE DERIVED FROM THE CITY OF MISSISSAUGA CONTROL MONUMENTS:
 No. 075033003, ELEVATION=193.381m
 No. 075033004, ELEVATION=193.755m
 No. 075033009, ELEVATION=196.956m

No.	REVISION	DATE	BY	APPD
4				
3				
2	DARC RESUBMISSION	MAR. 2024	Y.P.	S.R.
1	1st FSR SUBMISSION	OCT. 2023	Y.P.	S.R.

AVENIA CONSTRUCTION INC.

Region of Peel
working with you

MISSISSAUGA

CITY FILE No.	REGION FILE No.

URBANTECH **URBANTECH** Consulting
 A Division of Leighton-Zec Ltd.
 3760 14th Avenue, Suite 301,
 Markham, ON L3R 3T7
 TEL. 905.946.9461 • urbantech.com

PLAN & PROFILE
STREET B
 (STA. 0+500 TO STA. 0+680)

DESIGNED:	Y.P.	CHECKED:	S.R.	PROJECT No.:	23-748
DRAWN:	Y.P.	DATE:	OCTOBER 2023	SHEET No.:	
SCALE:	H 1:500 V 1:50			DRAWING No.:	PP-2