

- THIS PLAN MUST BE READ IN CONJUNCTION WITH THE MOST RECENT ARBORIST REPORT PREPARED BY URBAN FOREST INNOVATIONS INC (UFI).
- REFER TO UFI ARBORIST REPORT FOR A FULL INVENTORY OF TREE SPECIES AND REMOVAL REQUIREMENTS.
- NO GROUNDBREAKING ACTIVITIES OR DEMOLITION SHOULD OCCUR UNTIL ALL TREE PRESERVATION REQUIREMENTS HAVE BEEN MET. OF PRIMARY CONCERN IS THE ESTABLISHMENT OF PROPER HOARDING AT TREE PROTECTION ZONES (TPZ).
- A UFI CONSULTING ARBORIST SHOULD BE CONSULTED FOR ALL WORK THAT IMPACTS THE TREE PROTECTION ZONE.
- THE LOCATION OF THE TREE PROTECTION ZONES HAVE BEEN CLEARLY INDICATED ON THE SITE PLAN. FENCING SHALL REMAIN IN PLACE UNTIL ALL SITE WORK HAS BEEN COMPLETED, AND MAY NOT BE REMOVED, RELOCATED, OR OTHERWISE ALTERED WITHOUT THE WRITTEN PERMISSION OF THE CONSULTING ARBORIST.
- A QUALIFIED ARBORIST WILL UNDERTAKE PROPER ROOT PRUNING WHEN AND IF ROOTS OF RETAINED TREES ARE TO BE EXPOSED, DAMAGED OR SEVERED BY CONSTRUCTION ACTIVITIES. EXPOSED ROOTS WILL BE COVERED WITH SOIL OR MULCH AS SOON AS POSSIBLE TO PREVENT FURTHER DAMAGE AND DESICCATION. ROOT PRUNING PRIOR TO EXCAVATION WILL HELP PREVENT UNNECESSARY DAMAGE TO TREE ROOTS.
- THE TREE PROTECTION ZONE SHOULD BE POSTED WITH SIGNS. WITHIN THE TREE PROTECTION ZONE THERE WILL BE NO:
 - GRADE CHANGES
 - DUMPING OR STORAGE OF ANY MATERIALS
 - USE OF ANY MACHINERY WITHOUT PRIOR APPROVAL
 - LANDSCAPING WITH HEAVY MACHINERY
 - ACTIVITY OF ANY KIND WITHOUT PERMISSION OF THE CONSULTING ARBORIST
- EFFORTS SHOULD BE MADE TO ROUTE ALL UNDERGROUND UTILITIES AROUND THE TREE PROTECTION ZONES. IF THIS IS NOT POSSIBLE, THEY SHOULD BE BORED OR TUNNELED UNDER THE ROOT ZONE OF THE TREES (MINIMUM 1.6 M). USING TRADITIONAL TRENCHING METHODS, THERE WILL BE SIGNIFICANT ROOT DAMAGE TO THE TREES THAT ARE BEING PRESERVED. WHERE POSSIBLE IT IS STRONGLY RECOMMENDED THAT ANY INSTALLATION OF UNDERGROUND UTILITIES (WATER, SEWAGE OR HYDRO) SHOULD UTILIZE A NON-DESTRUCTIVE METHODOLOGY SUCH AS DIRECTIONAL BORING, AIRSPADE TECHNOLOGY OR HYDROVAC REMOVAL OF SOIL.
- IF INJURY SHOULD OCCUR TO RETAINED TREES DURING CONSTRUCTION, THE CONSULTING ARBORIST SHOULD EVALUATE THEM SO THAT APPROPRIATE TREATMENTS CAN BE RECOMMENDED AND PERFORMED.
- ALL CONTRACTORS SHOULD BE INFORMED OF THE TREE PROTECTION MEASURES AND GUIDELINES AT A PRE-CONSTRUCTION MEETING.
- MONITORING OF THE TREES AND THE TREE PROTECTION ZONE SHOULD BE CONDUCTED BY THE CONSULTING ARBORIST THROUGHOUT THE DURATION OF THE PROJECT.

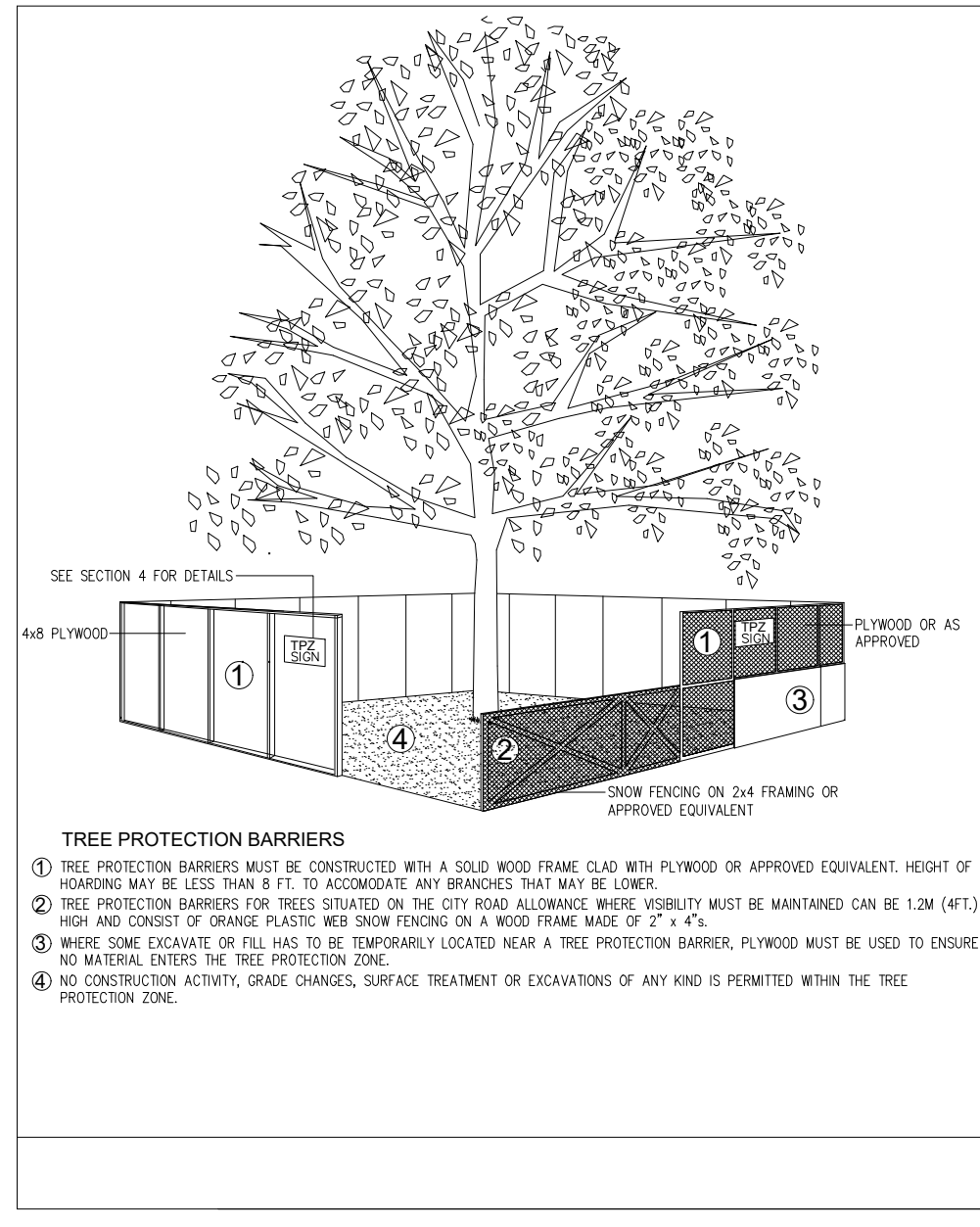

TREE PROTECTION FENCING DETAIL

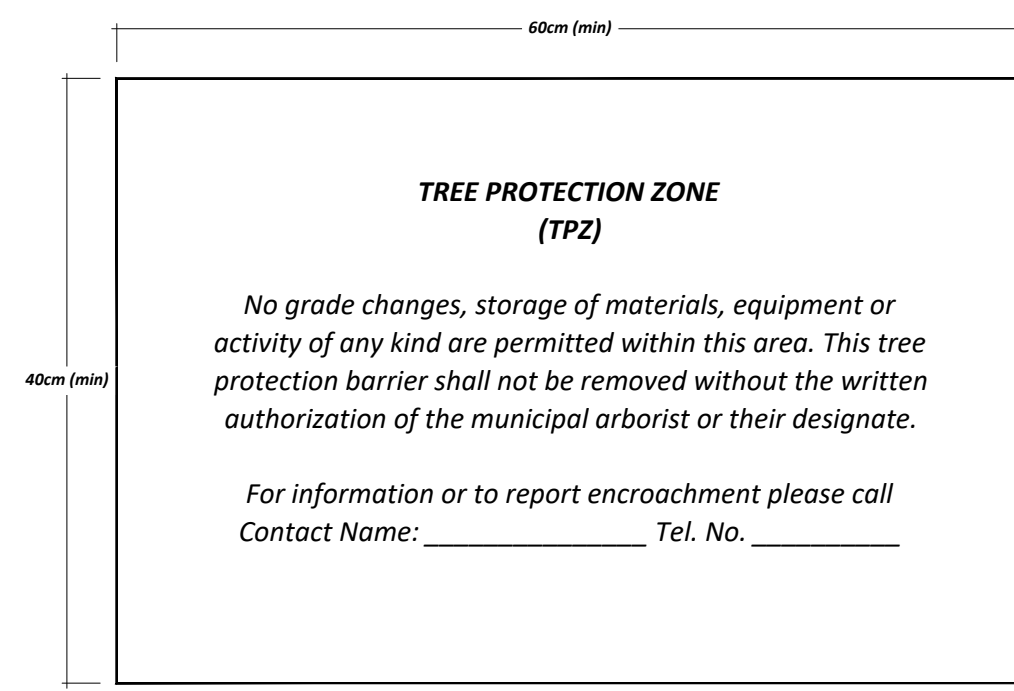

TREE PROTECTION SIGNAGE DETAIL

TREE PROTECTION NOTES

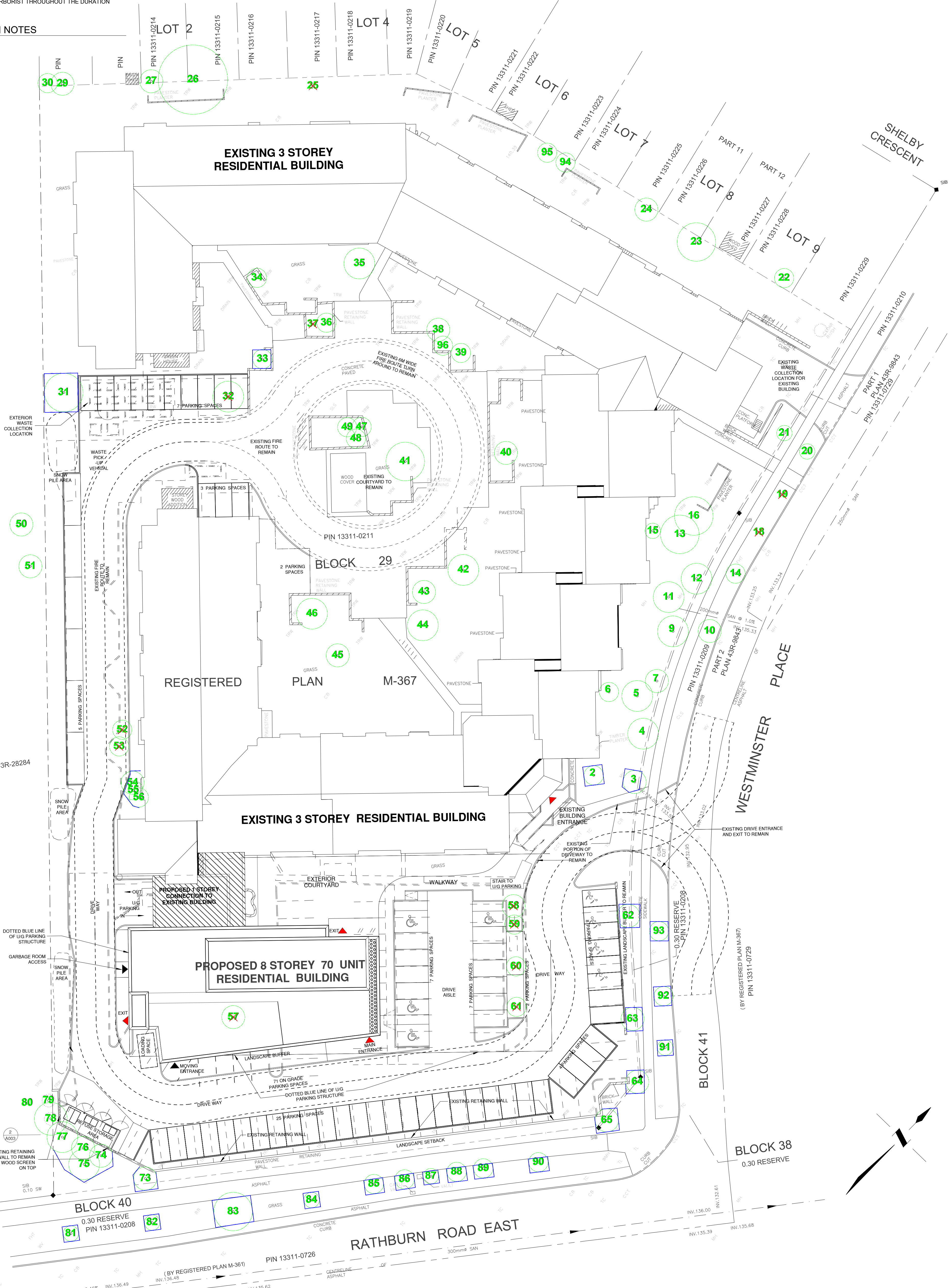

- LEGEND
- TREE TO BE RETAINED
 - TREE TO BE REMOVED
 - TREE PROTECTION ZONE (TPZ)
 - TREE HOARDING/FENCING

URBAN FOREST INNOVATIONS INC.
 1331 Northaven Drive
 Mississauga, Ontario L5G 4E8
 T: 905-274-1022
 F: 905-274-2170

TREE PROTECTION PLAN
 4150 WESTMINSTER PLACE, MISSISSAUGA

SCALE 1:300
 DATE 13/11/2023
 FIGURE TP-1