

CLIENT
DUNPAR DEVELOPMENTS INC.
105 SIX POINT RD
ETOBICOKE ON. M8Z 2X3
PHONE: (416) 236-9080

COPYRIGHT
This drawing has been prepared solely for the intended use. Any reproduction or distribution for any purpose other than authorized by ARCADIS is prohibited. Written dimensions shall have precedence over scaled dimensions. Contractors shall verify and be responsible for all dimensions and conditions shown on the drawing. Shop drawings shall be submitted to ARCADIS for general conformance before proceeding with fabrication.

ARCADIS PROFESSIONAL SERVICES (CANADA) INC.
is a member of ARCADIS Group of companies.

ISSUES

No.	DESCRIPTION	DATE
1.	ISSUE FOR OPA/ZBA SUBMISSION	DEC. 22, 2023

- LEGEND**
- PROPERTY LINE
 - OUTLINE OF BUILDING AT GROUND LEVEL
 - PROP. MAIN ENTRANCE / DOOR / OH DOOR
 - PROP. OVERLAND FLOW ROUTE
 - EX. OVERLAND FLOW ROUTE
 - PROP. SWALE
 - PROP. STORM MANHOLE
 - PROP. SANITARY MANHOLE
 - PROP. CATCH BASIN
 - EX. STORM MANHOLE
 - EX. SANITARY MANHOLE
 - PROP. WATER CHAMBER
 - PROP. RETAINING WALL
 - PROP. FIRE HYDRANT
 - PROP. STORM SEWER
 - PROP. SANITARY SEWER
 - PROP. WATERMAIN

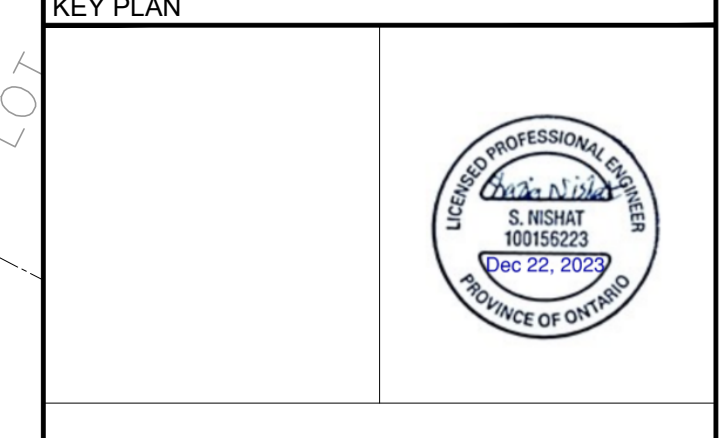
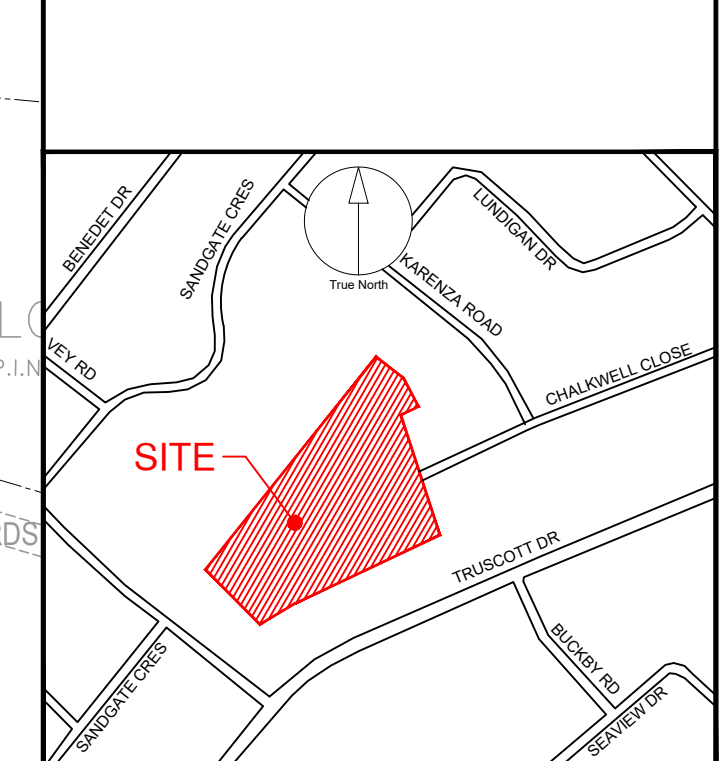

PROJECT
2620 CHALKWELL CLOSE
CITY OF MISSISSAUGA

PROJECT NO: 145258
DRAWN BY: AB
PROJECT MGR: NG
CHECKED BY: NG
APPROVED BY: SN

SHEET TITLE
SITE SERVICING PLAN

SHEET NUMBER SS-01 **ISSUE** 01

IT IS THE RESPONSIBILITY OF THE APPLICANT TO ENSURE COMPLIANCE WITH ALL APPLICABLE PROVINCIAL STANDARDS AND TO OBTAIN ALL PROVINCIAL APPROVALS, INCLUDING BUT NOT LIMITED TO ENVIRONMENTAL COMPLIANCE APPROVALS.

LIST OF DRAWINGS

- SG-01 (SITE GRADING PLAN)
- SS-01 (SITE SERVICING PLAN)
- EC-01 (EROSION & SEDIMENT CONTROL PLAN)
- XS-01 (CROSS SECTIONS)
- DD-01 (GENERAL NOTES AND DETAILS)

SITE PLAN INFORMATION

DUNPAR DEVELOPMENTS INC.
105 SIX POINT RD
ETOBICOKE, ONTARIO
PHONE: (416) 236-9080
WEBSITE: DUNPARHOMES.COM

SURVEY INFORMATION

R. AVIS SURVEYING INC.
235 YORKLAND BLVD. SUITE 203
TORONTO, ONTARIO
PHONE: (416) 490-8352
WEBSITE: RAVISURVEYING.COM

BENCHMARK INFORMATION:
ELEVATIONS ARE GEODETIC AND ARE DERIVED FROM CITY OF MISSISSAUGA BENCHMARK NO. 473 HAVING AN ELEVATION = 121.237 METRES.

SCALE: 1:300

File Location: \\1146268_2620Chalkwell\0_Production\03_Design\04_Civil\Sheet\145258_SHT - SERV.dwg Last Saved: December 21, 2023, 8:05:08 PM by Anish Bhatt