

**LEGEND**

- NATURAL FEATURE STAKE BY CIVC AND CITY (AUGUST 3, 2018)
- TOP OF BANK STAKED BY CIVC AND CITY (AUGUST 3, 2018)
- TOP OF BANK FROM R-PE TOPOGRAPHIC SURVEY
- LONG TERM STABLE SLOPE LINE BY DS CONSULTANTS (JULY 2023)

**BENCHMARK:**  
ELEVATIONS ARE REFERRED TO CANADIAN GEODETIC VERTICAL DATUM-1928, AND WERE DERIVED FROM CITY OF MISSISSAUGA BENCHMARK No. 58, HAVING A PUBLISHED ELEVATION OF 108.283 METRES.

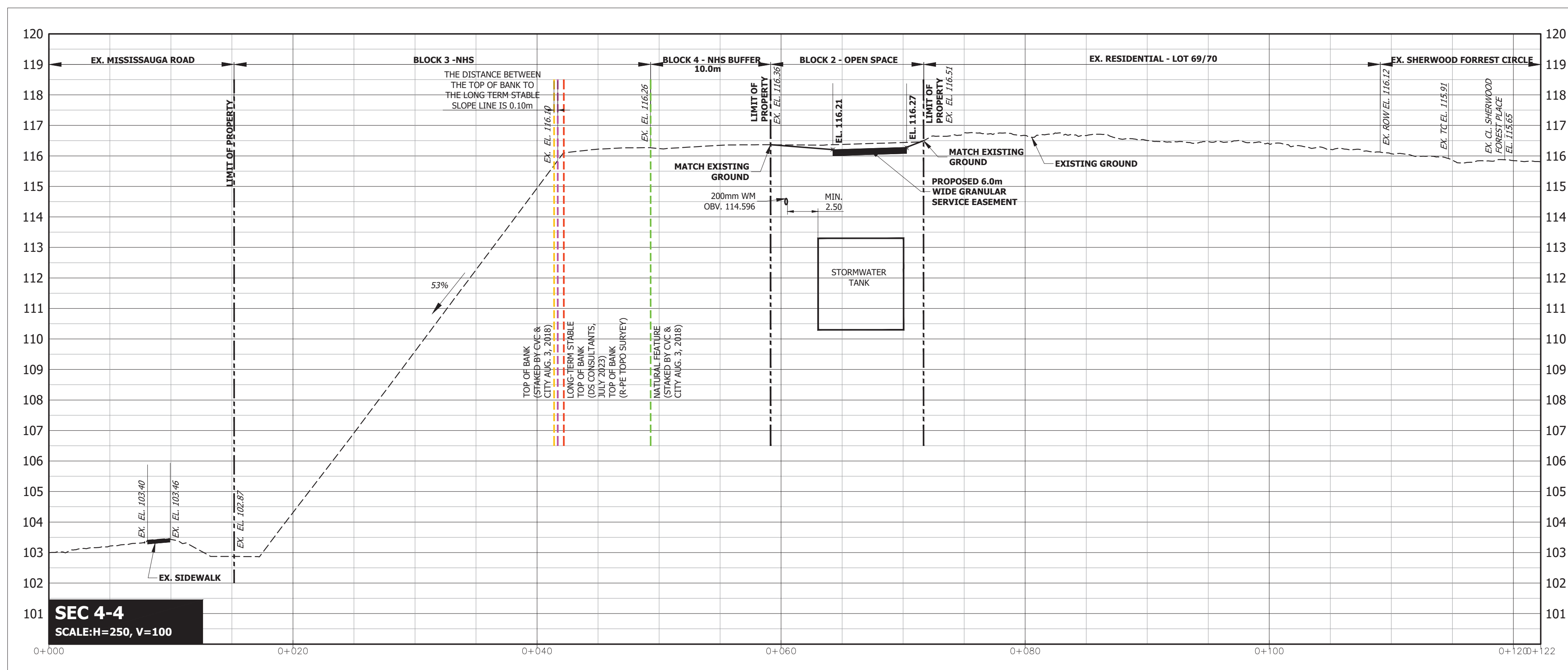

No.	REVISION	DATE	BY
4	FOURTH SUBMISSION	OCT. 7/24	J.S.
3	THIRD SUBMISSION	MAY 24/24	J.S.
2	SECOND SUBMISSION	NOV. 11/23	J.S.
1	FIRST SUBMISSION	OCT. 2/23	J.S.



**URBANTECH® Consulting**  
A Division of Leighton-Zec Ltd.  
3760 14th Avenue, Suite 301,  
Markham, ON, L3R 3T7  
TEL. 905.946.9461 • urbantech.com

**1720 SHERWOOD FORREST CIRCLE**  
CONDOMINIUM DETACHED RESIDENTIAL BLOCK  
SHERWOOD FORREST LIMITED PARTNERSHIP  
4900 PALLADIUM WAY, UNIT 105  
BURLINGTON, ON, L7M 0W7  
(905)336-5545



**GRADING SECTIONS (PART 1)**

PROJECT #:	23-747	DRAWING:	
SITE PLAN FILE No.:			
SUBDIVISION FILE No.:			
CITY FILE No.:			
REGION FILE No.:			
REGION CONNECTION FILE No.:			
DESIGNED:	J.S.	CHECKED:	D.Z.
DRAWN:	J.S.	DATE:	AUGUST 2023
SCALE:	1:250 H 1:100 V		

