

LEGEND

Tree Inventory

Refer to Table 1 of report dated 10 September 2024, revised 27 September 2024. Trees of all sizes on and within six metres of the subject property were included in the inventory.

Tree Removals

The removal of 41 trees is required to accommodate the proposed development as indicated with RED Labels. The removal of additional 2 dead trees is recommended as indicated with ORANGE labels. The removal of three trees is proposed by Urban Forestry as indicated with YELLOW labels.

Tree Preservation

Preservation of the remaining 23 trees will be possible with appropriate tree protection measures. Trees identified for preservation are indicated with GREEN labels. Tree protection measures will have to be implemented prior to the construction phase (earth works). Minimum tree preservation zones and required tree preservation fencing is indicated in MAGENTA. Refer to Tree Protection Plan Notes for preservation details.

- Tree Label (RED), removal required for development 123
- Tree Label (ORANGE), removal recommended 123
- Tree Label (YELLOW), removal proposed by City 123
- Tree Label (GREEN), preservation recommended 123
- Surveyed Tree Location ○
- Minimum Tree Protection Zone (mTPZ) ○
- Required Tree Protection Fencing —
- Extent of Block 1 —
- Tree has been removed ✕

Tree Protection Notes:

1. All existing trees, which are to remain, shall be fully protected with hoarding to City standards, erected beyond their "drip line" prior to the issuance of the Erosion and Sediment Control Permit, to the satisfaction of the Community Services Department. Groups of trees and other existing plantings to be protected, shall be treated in a like manner with hoarding around the entire clump(s). Areas within the protective fencing shall remain undisturbed and shall not be used for the storage of building materials or equipment.
2. No rigging cables shall be wrapped around or installed in trees. Surplus soil, equipment, debris or materials shall not be placed over root systems of the trees within the protective fencing. No contaminants will be dumped or flushed where feeder roots of trees exist.
3. The developer or his/her agents shall take every precaution necessary to prevent damage to trees or shrubs to be retained.
4. Where limbs or portions of trees are removed to accommodate construction work, they will be removed carefully in accordance with accepted arboricultural practices.
5. Where root systems of trees are exposed directly adjacent to or damaged by construction work, they shall be trimmed neatly and the area backfilled with appropriate material to prevent desiccation.
6. Where necessary, the trees will be given an overall pruning to restore the balance between roots and top growth or to restore the appearance of the trees.
7. Trees that have died or have been damaged beyond repair, shall be removed and replaced by the owner at the developer's own expense with trees of a size and species as approved by the Community Services Department.
8. If grades around trees to be protected are likely to change, the owner shall be required to take such precautions as dry welling, retaining walls and root feeding, to the satisfaction of the Community Services Department.

No.	Issue/Revisions	Date	By
1	Report Submission	10 Sep. '24	KH
2	Report Revision	27 Sep. '24	IB

Base Data: Studio tla (topo; site plan)

KUNTZ FORESTRY CONSULTING Inc.

PO Box 1267 Lakeshore W PO
146 Lakeshore Road West
Oakville ON L6K 0B3
289.837.1871
www.kuntzforestry.ca
consult@kuntzforestry.ca

Client
Studio tla
20 Champlain Boulevard, Suite 102
Toronto, Ontario M3H 2Z1

Property
Erin Mills Town Centre - Block 1
Mississauga, Ontario

Existing Conditions, Proposed Site Plan Tree Inventory and Preservation Plan

Project	P4111	Figure	2/3
Date	10 September 2024		
Scale	1:300		

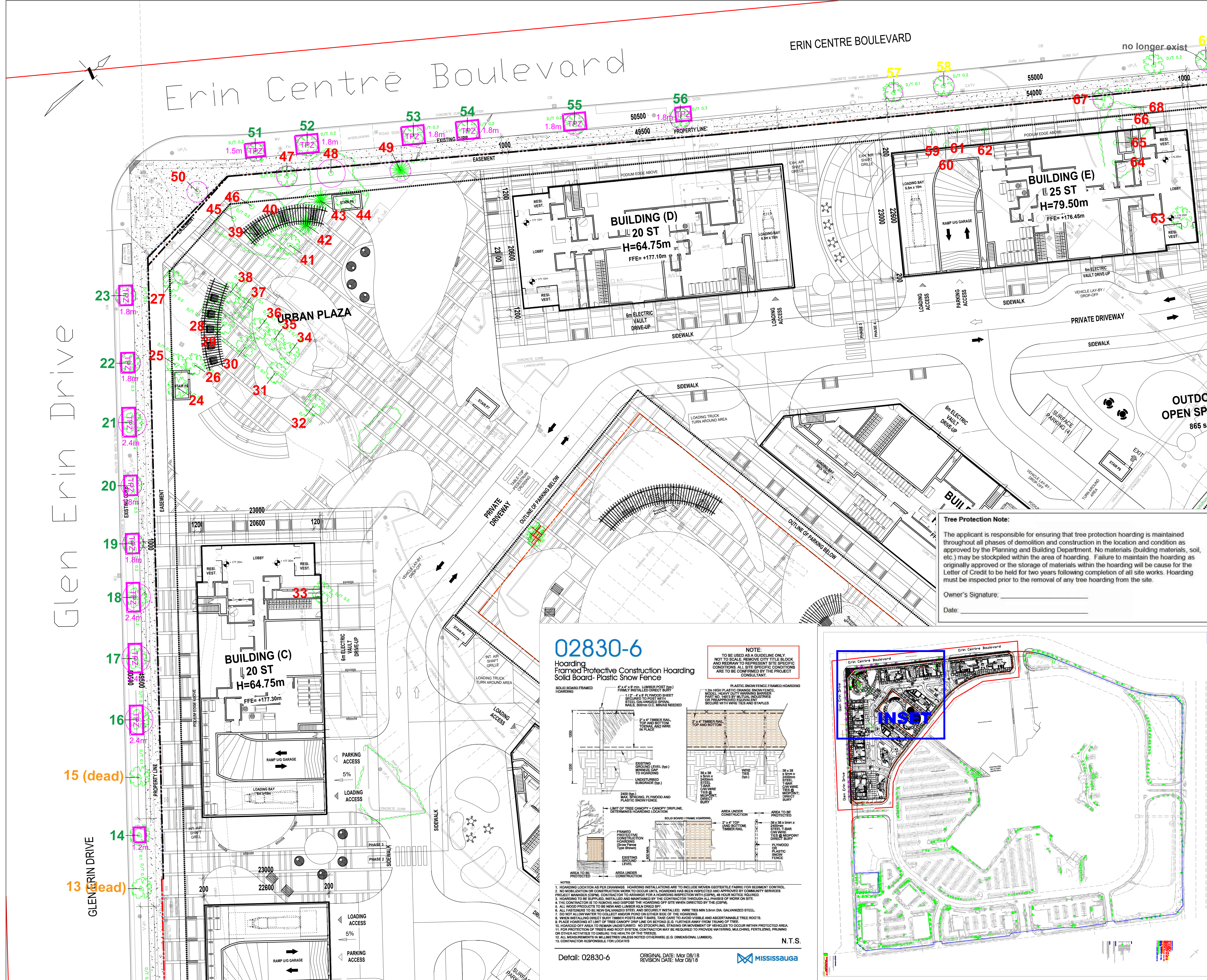

02830-6

Hoarding Fronted Protective Construction Hoarding Solid Board-Plastic Snow Fence

NOTE:
TO BE USED AS A GUIDELINE ONLY
NOT TO SCALE. REMOVE CITY TITLE BLOCK
AND REFER TO REPRESENT SITE SPECIFIC
CONDITIONS. ALL SITE SPECIFIC CONDITIONS
ARE TO BE CONFIRMED BY THE PROJECT
CONSULTANT.

SOLID BOARD FRAMED HOARDING

- 1. 4" x 4" LUMBER POST (Bp)
- 2. 2" x 4" TIMBER RAIL (TOP AND BOTTOM)
- 3. 1/2" HIGH PLASTIC ORANGE SNOW FENCE (MATERIAL TO BE PROVIDED BY CONTRACTOR)
- 4. 1/2" HIGH PLASTIC ORANGE SNOW FENCE (MATERIAL TO BE PROVIDED BY CONTRACTOR)
- 5. 1/2" HIGH PLASTIC ORANGE SNOW FENCE (MATERIAL TO BE PROVIDED BY CONTRACTOR)
- 6. 1/2" HIGH PLASTIC ORANGE SNOW FENCE (MATERIAL TO BE PROVIDED BY CONTRACTOR)
- 7. 1/2" HIGH PLASTIC ORANGE SNOW FENCE (MATERIAL TO BE PROVIDED BY CONTRACTOR)
- 8. 1/2" HIGH PLASTIC ORANGE SNOW FENCE (MATERIAL TO BE PROVIDED BY CONTRACTOR)
- 9. 1/2" HIGH PLASTIC ORANGE SNOW FENCE (MATERIAL TO BE PROVIDED BY CONTRACTOR)
- 10. 1/2" HIGH PLASTIC ORANGE SNOW FENCE (MATERIAL TO BE PROVIDED BY CONTRACTOR)
- 11. 1/2" HIGH PLASTIC ORANGE SNOW FENCE (MATERIAL TO BE PROVIDED BY CONTRACTOR)
- 12. 1/2" HIGH PLASTIC ORANGE SNOW FENCE (MATERIAL TO BE PROVIDED BY CONTRACTOR)
- 13. 1/2" HIGH PLASTIC ORANGE SNOW FENCE (MATERIAL TO BE PROVIDED BY CONTRACTOR)

FRAMED PROTECTIVE CONSTRUCTION HOARDING

- 1. 4" x 4" LUMBER POST (Bp)
- 2. 2" x 4" TIMBER RAIL (TOP AND BOTTOM)
- 3. 1/2" HIGH PLASTIC ORANGE SNOW FENCE (MATERIAL TO BE PROVIDED BY CONTRACTOR)
- 4. 1/2" HIGH PLASTIC ORANGE SNOW FENCE (MATERIAL TO BE PROVIDED BY CONTRACTOR)
- 5. 1/2" HIGH PLASTIC ORANGE SNOW FENCE (MATERIAL TO BE PROVIDED BY CONTRACTOR)
- 6. 1/2" HIGH PLASTIC ORANGE SNOW FENCE (MATERIAL TO BE PROVIDED BY CONTRACTOR)
- 7. 1/2" HIGH PLASTIC ORANGE SNOW FENCE (MATERIAL TO BE PROVIDED BY CONTRACTOR)
- 8. 1/2" HIGH PLASTIC ORANGE SNOW FENCE (MATERIAL TO BE PROVIDED BY CONTRACTOR)
- 9. 1/2" HIGH PLASTIC ORANGE SNOW FENCE (MATERIAL TO BE PROVIDED BY CONTRACTOR)
- 10. 1/2" HIGH PLASTIC ORANGE SNOW FENCE (MATERIAL TO BE PROVIDED BY CONTRACTOR)
- 11. 1/2" HIGH PLASTIC ORANGE SNOW FENCE (MATERIAL TO BE PROVIDED BY CONTRACTOR)
- 12. 1/2" HIGH PLASTIC ORANGE SNOW FENCE (MATERIAL TO BE PROVIDED BY CONTRACTOR)
- 13. 1/2" HIGH PLASTIC ORANGE SNOW FENCE (MATERIAL TO BE PROVIDED BY CONTRACTOR)

NOTES:

1. HOARDING LOCATION AS PER DRAWINGS. HOARDING INSTALLATIONS ARE TO INCLUDE WOVEN GEOTEXTILE FABRIC FOR SEDIMENT CONTROL.
2. NO DEMOLITION OR CONSTRUCTION WORK TO OCCUR UNTIL HOARDING HAS BEEN INSPECTED AND APPROVED BY COMMUNITY SERVICES PROJECT MANAGER (CSPM). CONTRACTOR TO ARRANGE FOR A HOARDING INSPECTION WITH CSPM, 48 HOUR NOTICE REQUIRED.
3. HOARDING TO BE MAINTAINED BY THE CONTRACTOR THROUGH ALL PHASES OF WORK ON SITE.
4. THE CONTRACTOR IS TO REMOVE AND DISPOSE THE HOARDING OFF SITE WHEN DIRECTED BY THE CSPM.
5. ALL WOOD PRODUCTS TO BE REPAIRED AND REFINISHED AS REQUIRED.
6. ALL FASTENERS TO BE NEW GALVANIZED STEEL AND SECURELY INSTALLED. WIRE TIES MIN 3.5mm DIA GALVANIZED STEEL.
7. DO NOT ALLOW WATER TO COLLECT AND/OR FLOOD ON OR BEHIND THE HOARDING.
8. WHEN INSTALLING DIRECT BURY TIMBER POSTS AND T-BARS, TAKE CARE TO AVOID VISIBLE AND ASCERTAINABLE TREE ROOTS.
9. PLACE HOARDING AT LIMIT OF TREE CANOPY DRIP LINE OR BEYOND. DO NOT PLACE HOARDING WITHIN TRUNK OF TREE.
10. HOARDING OFF AREA TO REMAIN UNDISTURBED. NO STOCKPILING, STAGING OR MOVEMENT OF VEHICLES TO OCCUR WITHIN PROTECTED AREA.
11. FOR PROTECTION OF TREES AND ROOT SYSTEMS CONTRACTOR MAY BE REQUIRED TO PROVIDE WATERING, MULCHING, FERTILIZING, PRUNING OR OTHER ACTIVITIES TO ENSURE THE HEALTH OF THE TREES.
12. ALL MEASUREMENTS IN MILLIMETRES UNLESS NOTED OTHERWISE (E.G. DIMENSIONAL LUMBER).
13. CONTRACTOR RESPONSIBLE FOR LOCATES.

N.T.S.

Detail: 02830-6 ORIGINAL DATE: M07 08/18 REVISION DATE: M07 08/18

