

Copyright Reserved

The Contractor shall verify and be responsible for all dimensions. DO NOT scale the drawing - any errors or omissions shall be reported to Stantec without delay. The Copyrights to all designs and drawings are the property of Stantec. Reproduction or use for any purpose other than that authorized by Stantec is forbidden.

- Legend**
- 120.00 PROPOSED ELEVATION
 - 120.90 EXISTING ELEVATIONS
 - OVERLAND FLOW
 - EXISTING OVERLAND FLOW
 - SANITARY MANHOLE
 - STORM MANHOLE
 - CATCH BASIN
 - DOUBLE CATCH BASIN
 - CATCH BASIN MANHOLE
 - AREA DRAIN
 - DOUBLE AREA DRAIN
 - VALVE AND VALVE BOX
 - ◆ HYDRANT AND VALVE
 - ===== CONCRETE CURB
 - DROPPED CURB
 - PROPERTY BOUNDARY
 - WATERMAIN
 - STORM SEWER
 - SANITARY SEWER

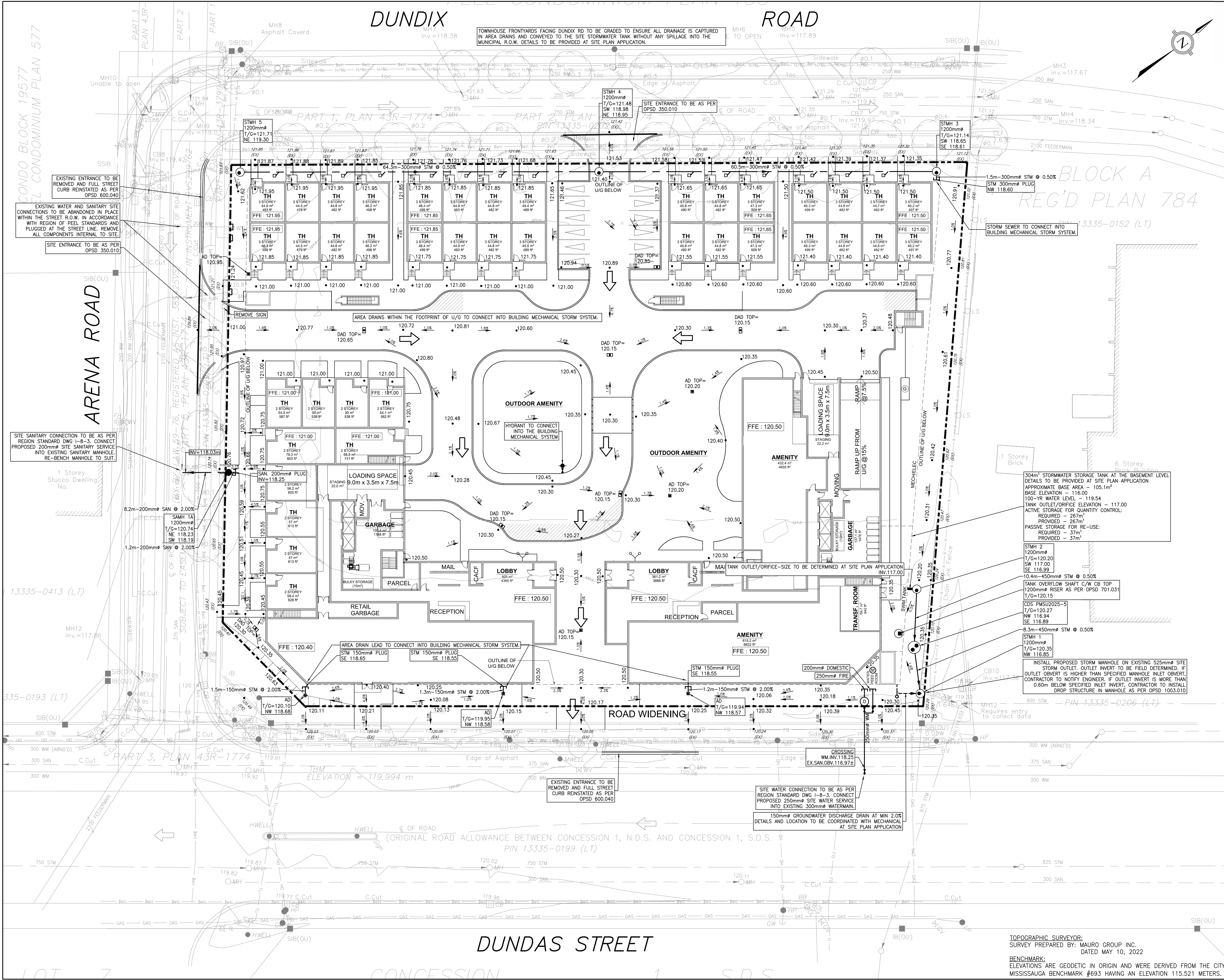

304m³ STORMWATER STORAGE TANK AT THE BASEMENT LEVEL
 DETAILS TO BE PROVIDED AT SITE PLAN APPLICATION
 APPROXIMATE BASE AREA - 105.1m²
 100-YR WATER LEVEL - 119.54
 TANK OUTLET/ORIFICE ELEVATION - 117.00
 ACTIVE STORAGE FOR QUANTITY CONTROL:
 REQUIRED - 267m³
 PROVIDED - 267m³
 PASSIVE STORAGE FOR RE-USE:
 REQUIRED - 37m³
 PROVIDED - 37m³

ISSUED FOR I&A/O&P	PF	AL	24.08.02
ISSUED FOR I&A/O&P&A	PF	AL	22.07.08
Issued	By	Appd.	YYMMDD
File Name:	PF	BC	PF
	Dwn.	Chkd.	Dgn.

Permit-Seal

Client/Project
DUNDIX REALTY HOLDINGS
 c/o SmartCentres REIT.
 PROPOSED RESIDENTIAL DEVELOPMENT
 1225 DUNDAS ST E
 Mississauga, Ontario

Title
GRADING AND SERVICING PLAN

Project No. 160623078
 Drawing No. C-101
 Scale 1:300
 Sheet 9 of 15
 Revision

TOPOGRAPHIC SURVEYOR:
 SURVEY PREPARED BY: MAURO GROUP INC.
 DATED MAY 10, 2022
 BENCHMARK:
 ELEVATIONS ARE GEODETIC IN ORIGIN AND WERE DERIVED FROM THE CITY OF MISSISSAUGA BENCHMARK #693 HAVING AN ELEVATION 115.521 METERS.

V:\01_65A\A\Drawings\160623078\Drawing\Sheet_C-101\UGP.dwg
 2024/08/01 1:07 PM by: Franck, Pomponin
 ORIGINAL SHEET - ARCH-D