

02830-6

Hoaarding Framed Protective Construction Hoaarding Solid Board- Plastic Snow Fence

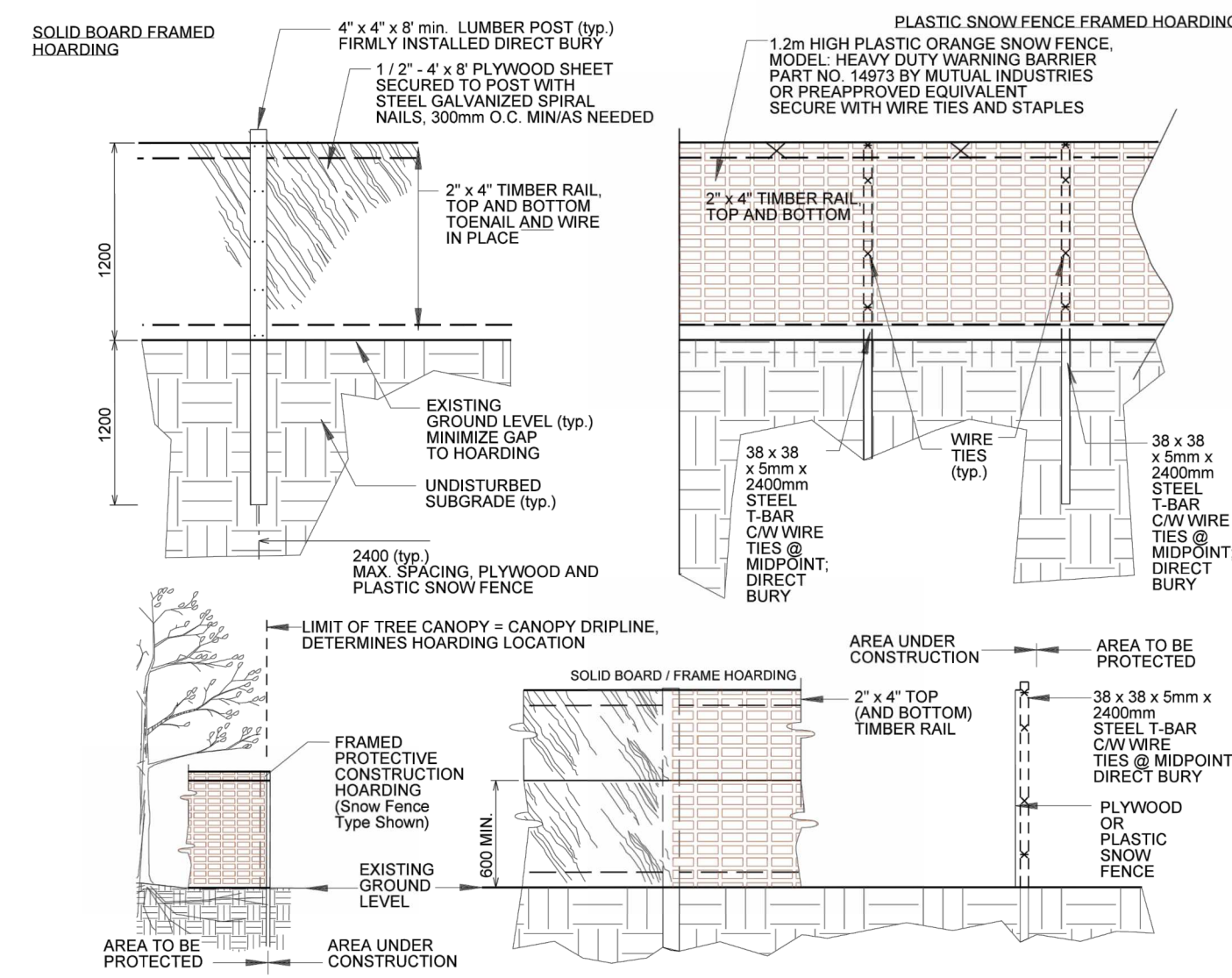

- NOTES:**
- HOARDING LOCATION AS PER DRAWINGS. HOARDING INSTALLATIONS ARE TO INCLUDE WOVEN GEOTEXTILE FABRIC FOR SEDIMENT CONTROL.
 - NO MOBILIZATION OR CONSTRUCTION WORK TO OCCUR UNTIL HOARDING HAS BEEN INSPECTED AND APPROVED BY COMMUNITY SERVICES PROJECT MANAGER (CSPM). CONTRACTOR TO ARRANGE FOR A HOARDING INSPECTION WITH (CSPM), 48 HOUR NOTICE REQUIRED.
 - HOARDING TO BE SUPPLIED, INSTALLED AND MAINTAINED BY THE CONTRACTOR THROUGH ALL PHASES OF WORK ON SITE.
 - THE CONTRACTOR IS TO REMOVE AND DISPOSE THE HOARDING OFF SITE WHEN DIRECTED BY THE (CSPM).
 - ALL WOOD PRODUCTS TO BE NEW AND LUMBER KILN DRIED SPF.
 - ALL FASTENERS TO BE NEW GALVANIZED STEEL AND SECURELY INSTALLED. WIRE TIES MIN 3.5mm DIA. GALVANIZED STEEL.
 - DO NOT ALLOW WATER TO COLLECT AND/OR POND ON EITHER SIDE OF THE HOARDING.
 - WHEN INSTALLING DIRECT BURY TIMBER POSTS AND T-BARS, TAKE CARE TO AVOID VISIBLE AND ASCERTAINABLE TREE ROOTS.
 - PLACE HOARDING AT LIMIT OF TREE CANOPY DRIP LINE OR BEYOND (E.G. FURTHER AWAY FROM TRUNK OF TREE).
 - HOARDED OFF AREA TO REMAIN UNDISTURBED. NO STOCKPILING, STAGING OR MOVEMENT OF VEHICLES TO OCCUR WITHIN PROTECTED AREA.
 - FOR PROTECTION OF TREE'S AND ROOT SYSTEM, CONTRACTOR MAY BE REQUIRED TO PROVIDE WATERING, MULCHING, FERTILIZING, PRUNING OR OTHER ACTIVITIES TO ENSURE THE HEALTH OF THE TREE(S).
 - ALL MEASUREMENTS IN MILLIMETRES UNLESS NOTED OTHERWISE (E.G. DIMENSIONAL LUMBER).
 - CONTRACTOR RESPONSIBLE FOR LOCATES.

N.T.S.

Detail: 02830-6 ORIGINAL DATE: Mar 08/18 REVISION DATE: Mar 08/18



TREE INVENTORY NOTES

Tree #	Common Name	Botanical Name	DBH (CM)	Condition	Comments	Recommendation
411	Norway Maple	Acer platanoides	20	P	Significant crown die-back and leader die-back	Retain
412	Manitoba Maple	Acer negundo	37	P	Single stem of co-dominant pair remains, moderate to significant deadwood in canopy, signs of rot at base, epicormics throughout	Retain
413	Slippery Elm	Ulmus rubra	23	F/G	Evidence of leaf miner	Retain
414	Slippery Elm	Ulmus rubra	20	F	Evidence of leaf miner	Retain
415	Slippery Elm	Ulmus rubra	21	F	Evidence of leaf miner, slightly	Retain
416	Slippery Elm	Ulmus rubra	21	F/P	Evidence of leaf miner, moderate/significant die-back on north side of crown	Retain
417	Slippery Elm	Ulmus rubra	24	F/G	Evidence of leaf miner	Retain
418	Slippery Elm	Ulmus rubra	23	F	Evidence of leaf miner	Retain
419	Slippery Elm	Ulmus rubra	24	F/G	Evidence of leaf miner	Remove due to construction
420	Slippery Elm	Ulmus rubra	23	F/G	Evidence of leaf miner	Retain
421	Slippery Elm	Ulmus rubra	26	F/G	Evidence of leaf miner	Retain
446	Honey Locust	Gleditsia triacanthos	16	F/G	Wound at trunk at 1.2 metres	Retain
447	Honey Locust	Gleditsia triacanthos	5	F/G	Newly planted, minor deadwood in canopy	Retain
448	Honey Locust	Gleditsia triacanthos	18	G	Good form, full canopy	Remove due to construction
449	Bradford Pear	Pyrus calleryana	8	F/G		Retain
450	Bradford Pear	Pyrus calleryana	9	F/G	Mild lean	Retain
451	Bradford Pear	Pyrus calleryana	10	F/G	Slight bow in trunk	Retain
453	Bradford Pear	Pyrus calleryana	6	D	Tree 100% dead	Remove due to condition
O1	White Mulberry	Morus alba	35	F	Growing between fences, self-seeded, multi-stemmed	Retain
O2	Manitoba Maple	Acer negundo	~27	F	Growing between fences, multi-stemmed, self-seeded	Retain
O3	Manitoba Maple	Acer negundo	~29	F	Growing between fences, multi-stemmed, self-seeded	Retain
O4	Colorado Spruce	Picea pungens	27	F	Top of tree crowded and stunted due to adjacent tree cover	Retain
O5	Austrian Pine	Pinus nigra	25	F	Leader growing at severe angle due to adjacent tree cover	Retain
O6	Manitoba Maple	Acer negundo	48	F	Two stems at base, minor deadwood in canopy	Retain
O7	White Mulberry	Morus alba	39	F	Poor form, moderate deadwood in canopy, twisted main limbs with included bark	Retain
A	White Mulberry	Morus alba	~10	F - F/P	4 separate stems, grown into fence	Retain

LEGEND

GENERAL NOTES

- Do not scale the drawings. All dimensions are in millimetres unless noted otherwise.
- This drawing is to be read in conjunction with the project site plan, landscape plan, and engineering plan.
- The tree inventory includes assessment of trees >10cm DBH. The trees have been assessed based on species, size and condition.
- The contractor shall check and verify all existing and proposed grading and conditions on the project and immediately report any discrepancies to the consultant before proceeding with any removals.
- The contractor is to be aware of all existing and proposed services and utilities. The contractor is responsible for having all underground services and utility lines staked by each agency having jurisdiction prior to commencing work.
- This drawing is to be used for development approval only.
- Do not leave any holes open overnight.
- Keep area outside construction zone clean and useable by others at all times. Contractor shall thoroughly clean areas surrounding the construction zone at the end of each work day.
- Contractor to make good any and all damages outside of the development area that may occur as a result of tree removals at no extra cost.
- This drawing is Copyright MHBC Planning, 2024.

2.	AUGUST 7, 2024	ISSUED FOR SPA	NV
1.	JULY 07, 2022	ISSUED FOR OPAZBA	NV
REVISION NO.	DATE	ISSUED / REVISION	BY

230-7050 WESTON ROAD WOODBRIDGE, ON, L4L 8G7 | P: 905.761.5588 F: 905.761.5589 | WWW.MHBCPLAN.COM

STAMP	DATE	JUNE 2021
	DRAWN BY	NV
	PLAN SCALE	-
	FILE NO.	1257DI
	CHECKED BY	N.M.
	OTHER	

ISSUED FOR SPA ONLY
NOT FOR CONSTRUCTION

All drawings and specifications are instruments of service and will remain the property of MHBC Planning and must be returned at the completion of the work. This drawing shall not be used for construction purposes unless the drawings are marked 'Issued for Construction' and the professional seal is signed and dated by the landscape architect.

PROJECT

1225 DUNDAS STREET EAST
MISSISSAUGA, ONTARIO

FILE NAME	DWG NO.
TREE INVENTORY, PROTECTION, AND REMOVALS	TI-2