

**MONA ROAD**

(BY REGISTERED PLAN 323)  
P.I.N. 13461-0147

**MANDATORY NOTES**

1. BE ADVISED THAT THE CREDIT VALLEY CONSERVATION AUTHORITY MAY, AT ANY TIME, WITHDRAW THIS PERMISSION, IF, IN THE OPINION OF THE AUTHORITY, THE CONDITIONS OF THE PERMIT ARE NOT BEING COMPLIED WITH. THIS APPROVAL DOES NOT EXEMPT THE PROPERTY OWNER/APPLICANT/AGENT FROM THE PROVISIONS OF ANY OTHER FEDERAL, PROVINCIAL OR MUNICIPAL STATUTES, REGULATIONS OR BY-LAWS, OR ANY RIGHTS UNDER COMMON LAW.
2. FOLLOWING INSTALLATION OF THE PROPOSED ESC MEASURES, A QUALIFIED AGENT OF THE PROPONENT, PREFERABLY AN ENVIRONMENTAL MONITOR, WILL CONDUCT REGULAR SITE VISITS TO MONITOR ALL WORKS, PARTICULARLY THE CONDITION OF THE ESC MEASURES, DEWATERING, AND IN- OR NEAR-WATER WORKS. SHOULD CONCERNS ARISE, THE ENVIRONMENTAL MONITOR WILL CONTACT THE PROPONENT, CVC, AND ANY OTHER APPROPRIATE PARTIES.
3. ALL CONSTRUCTION ACTIVITIES, INCLUDING MAINTENANCE PROCEDURES, WILL BE CONTROLLED TO PREVENT THE ENTRY OF DEBRIS, SEDIMENTS, OR OTHER DELETERIOUS PRODUCTS TO THE WATERCOURSE OR WETLAND. EQUIPMENT MAINTENANCE WILL BE CONDUCTED A MINIMUM OF 30 METRES FROM THE WATERCOURSE/WETLAND.
4. SEDIMENT LADEN RUNOFF FROM DISTURBED AREAS TO THE WATERCOURSE OR NATURAL FEATURE IS NOT ALLOWED. ALL DEWATERING SHALL BE TREATED AND THEN RELEASED AWAY FROM A WATERCOURSE OR WETLAND. DISCHARGE IS TO BE RELEASED TO AN UNDISTURBED NATURAL AREA. THESE CONTROL MEASURES SHALL BE MONITORED AND MAINTAINED OR REVISED TO ENSURE WATER QUALITY TARGETS ARE BEING ACHIEVED.
5. PLEASE REFER TO ESC GUIDELINE FOR URBAN CONSTRUCTION (DECEMBER 2006) FOR THE DESIGN AND DESIGN ALTERATION OF ESC MEASURES.
6. ESC MEASURES WILL BE IMPLEMENTED PRIOR TO, AND MAINTAINED DURING THE CONSTRUCTION PHASES, TO PREVENT ENTRY OF SEDIMENT INTO THE WATERCOURSE/NATURAL AREAS. ESC MEASURES ARE TO BE EVALUATED ON A WEEKLY BASIS AND AFTER ANY STORM EVENT. ANY REPAIRS REQUIRED ARE TO BE RECTIFIED IMMEDIATELY.
7. THE EROSION AND SEDIMENT CONTROL (ESC) PLAN IS A DYNAMIC DOCUMENT, WHICH MAY BE SUBJECT TO CHANGE OR MODIFICATIONS AS A RESULT OF SITE DEVELOPMENTS OR CHANGES ON SITE. ANY DEVIATION FROM APPROVED PLANS MUST BE DESIGNED BY A QUALIFIED PROFESSIONAL.
8. ADDITIONAL ESC MATERIALS (I.E. SILT FENCE, FILTER SOCKS, STRAW BALES, CLEAR STONES, ETC.) ARE TO BE KEPT ON SITE FOR EMERGENCIES AND REPAIRS.
9. THE PROJECT PROPONENT OR THEIR REPRESENTATIVE IS ULTIMATELY RESPONSIBLE FOR CONTROLLING SEDIMENT AND EROSION WITHIN THE CONSTRUCTION SITE FOR THE TOTAL PERIOD OF THE CONSTRUCTION.
10. DISTURBED AREAS WILL BE MINIMIZED TO THE EXTENT POSSIBLE, AND TEMPORARILY OR PERMANENTLY STABILIZED OR RESTORED AS THE WORK PROGRESSES. ALL DISTURBED GROUND LEFT INACTIVE FOR MORE THAN 30 DAYS SHALL BE STABILIZED USING APPROPRIATE EROSION CONTROL MEASURES AND AN APPROPRIATE NATIVE NON-INVASIVE SEED MIX OR WITH THE FINAL APPROVED RESTORATION PLAN.
11. ANY SEDIMENT SPILL FROM THE SITE SHOULD BE REPORTED TO MINISTRY OF ENVIRONMENT (SPILL ACTION CENTER) AT 1-800-268-6060.
12. IF EXCESSIVE SILTATION RESULTS FROM THE CONSTRUCTION ACTIVITIES, THE ONSITE SUPERVISOR/INSPECTOR AND/OR CVC RESERVE THE RIGHT TO REQUEST ADDITIONAL ESC MEASURES WHICH WOULD BE INSTALLED PRIOR TO FURTHER CONSTRUCTION ACTIVITIES.

**SITE-SPECIFIC NOTES:**

13. THE CONTRACTOR SHALL MONITOR WEATHER FORECASTS TO ENSURE THAT THE WORKS WILL BE CONDUCTED IN FAVOURABLE WEATHER. THE CONTRACTOR IS RESPONSIBLE FOR REMOVING ALL CONSTRUCTION EQUIPMENT AND MATERIALS THAT WOULD HAVE POTENTIAL TO CAUSE A SPILL OR OBSTRUCTION (I.E. FUEL TANKS, PORTABLE TOILETS, MACHINERY, ETC.), FROM THE 100 YEAR\* FLOODPLAIN IN THE CASE OF A LARGE STORM EVENT OR SITE SPECIFIC STORM EVENT. CROSSING AN ACTIVE WATERCOURSE OR WETLAND BY EQUIPMENT, VEHICLES, PERSONNEL, ETC. IS NOT PERMITTED UNLESS APPROVED BY CVC. ALL ACCESS TO WORK SITES SHALL BE FROM EITHER SIDES OF THE WATERCOURSE OR WETLAND.
14. ALL IN-WATER AND NEAR WATER WORKS WILL BE CONDUCTED IN THE DRY AND MUST BE STAGED WITH APPROPRIATE EROSION AND SEDIMENT CONTROLS. PLAN THE WORK ACCORDINGLY WITH THE WEATHER FORECAST.
15. AN AFTER-HOURS CONTACT NUMBER IS TO BE VISIBLY POSTED ON-SITE FOR EMERGENCIES. ALL THE PLANS SHOULD HAVE NAME AND CONTACT INFO OF THE PERSON RESPONSIBLE FOR ESC MEASURES.

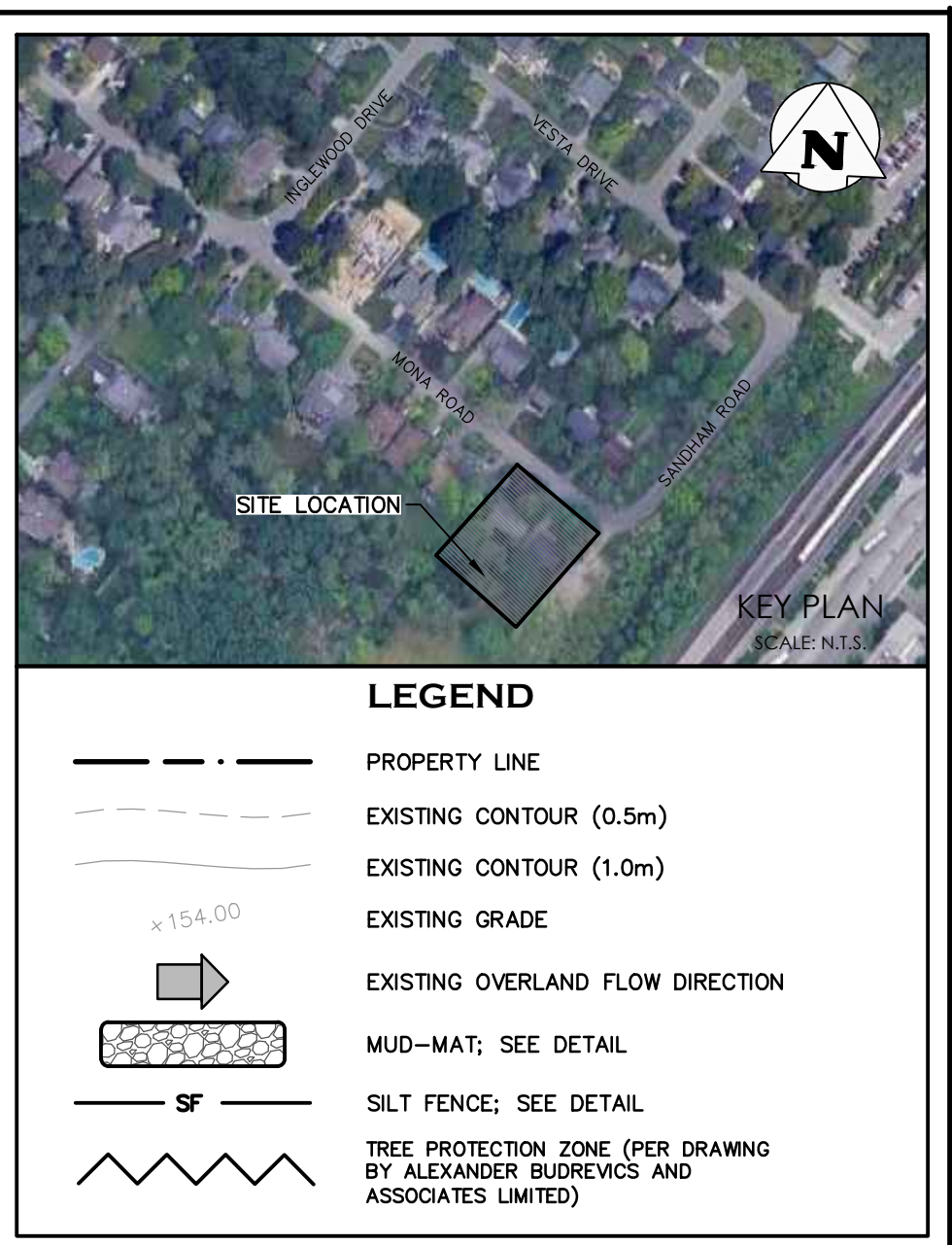

**ESC NOTES:**

1. EROSION AND SEDIMENT CONTROL METHODS ARE TO BE CONTINUOUSLY EVALUATED AND UPGRADES ARE TO BE IMPLEMENTED, WHEN NECESSARY.
2. ADDITIONAL EROSION AND SEDIMENT CONTROL MATERIALS (I.E. SILT FENCE, STRAW BALES, CLEAR STONES, ETC.) ARE TO BE KEPT ON SITE FOR EMERGENCIES AND REPAIRS.
3. THE CONTRACTOR IS ULTIMATELY RESPONSIBLE FOR CONTROLLING SEDIMENT AND EROSION WITHIN THE CONSTRUCTION SITE FOR THE TOTAL PERIOD OF THE CONSTRUCTION. THE SEDIMENT LADEN WATER WILL NOT BE ALLOWED TO DISCHARGE TO THE CREEK.
4. AN AFTER HOURS CONTACT NUMBER IS TO BE VISIBLY POSTED ON-SITE FOR EMERGENCIES.
5. ANY SEDIMENT SPILL FROM THE SITE MUST BE REPORTED TO THE MINISTRY OF THE ENVIRONMENT AND CLIMATE CHANGE (CALL SPILL ACTION CENTER AT 1 800 268 6060).

**STAGED ESC PLAN:**

1. INSTALL MUDMAT.
2. INSTALL SILT FENCE/HOARDING.
3. REMOVAL OF INDICATED TREES.
4. INSTALL SEDIMENT BAG PER TRCA "DEWATERING TREATMENT TRAIN" DETAIL ON THIS DRAWING.
5. EXCAVATION OF HDD ENTRANCE PIT.
6. INSTALL SHORING FOR HDD DRILLING.
7. INSTALL SILT SOCK AND HDD EXIT PIT.
8. CONSTRUCTION OF HEADWALL AT HDD EXIT PIT.
9. COMPLETION OF HDD. SEE HDD DRILLING NOTE FOR DETAILS OF DRILLING OPERATIONS. SEE DEWATERING NOTE FOR DETAILS OF DEWATERING WITHIN THE HDD EXCAVATION.
10. FOLLOWING DRILLING OPERATIONS, EXCAVATION OF ENTRANCE PIT TO BE FILLED TO REQUIRED FLOOR GRADE.
11. STRIP-TOPSOIL AS REQUIRED FROM REMAINDER OF SITE AND TRUCK OFFSITE. NO STOCKPILING IS TO TAKE PLACE ON SITE.
12. INSTALL SHORING FOR UNDERGROUND PARKING GARAGE EXCAVATION AT SHORING LIMITS INDICATED.
13. EXCAVATION OF UNDERGROUND PARKING GARAGE. SEE DEWATERING NOTE FOR DETAILS OF DEWATERING WITHIN THE UNDERGROUND PARKING EXCAVATION.
14. FOLLOWING CONSTRUCTION OF THE UNDERGROUND PARKING GARAGE, FOLLOWING OF SERVICING TRENCHES AND INSTALLATION OF UNDERGROUND SERVICES TO TAKE PLACE. ANY WATER ACCUMULATED WITHIN THE SERVICING TRENCHES IS TO BE PUMPED TO THE SEDIMENT BAG. SEE DEWATERING NOTE FOR DETAILS.
15. EXCAVATION AND CONSTRUCTION OF UNDERGROUND STORMWATER DETENTION CHAMBER. ANY WATER ACCUMULATED WITHIN THE EXCAVATION IS TO BE PUMPED TO THE SEDIMENT BAG. SEE DEWATERING NOTE FOR DETAILS.
16. FOLLOWING CONSTRUCTION OF ALL SURFACE WORKS, CONSTRUCTION OF INFILTRATION TRENCH TO TAKE PLACE. SEE INFILTRATION TRENCH NOTE FOR DETAILS OF CONSTRUCTION AND PROTECTION.

**NOTE:**  
NO STOCKPILING TO BE COMPLETED ON SITE. ALL FILL OBTAINED FROM THE EXCAVATION WILL BE IMMEDIATELY TRUCKED OFFSITE.

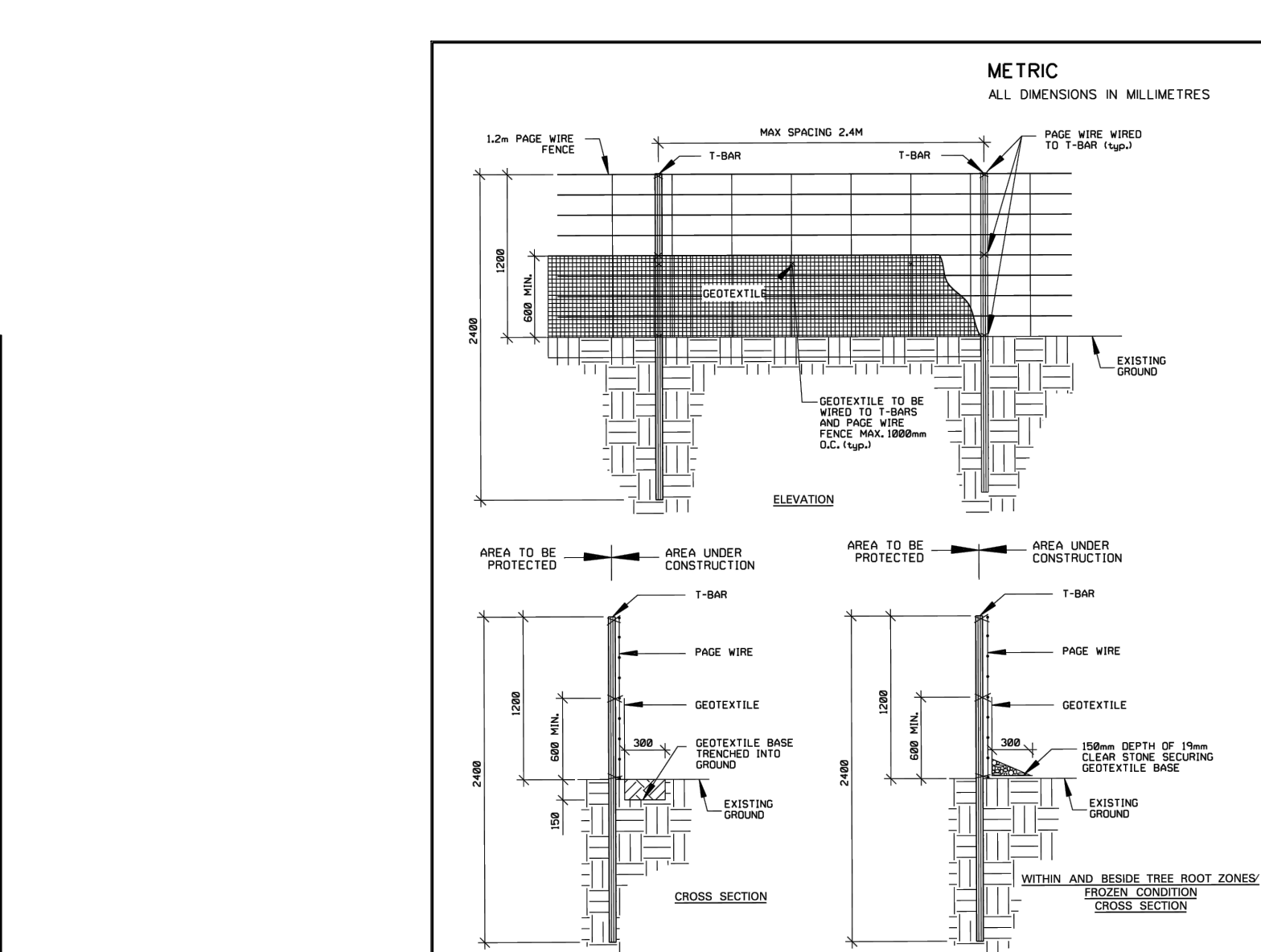
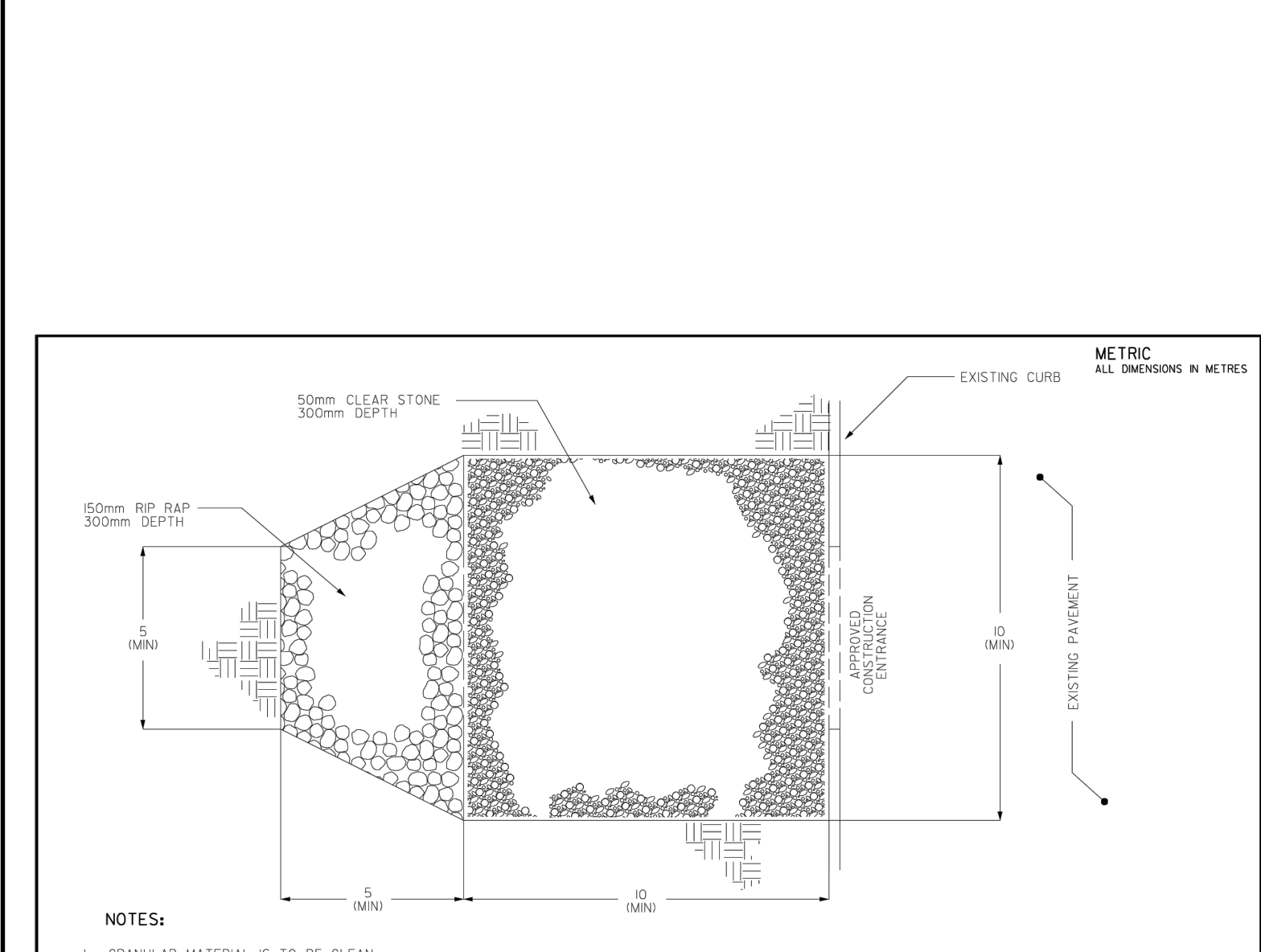

**MANDATORY NOTES**

1. BE ADVISED THAT THE CREDIT VALLEY CONSERVATION AUTHORITY MAY, AT ANY TIME, WITHDRAW THIS PERMISSION, IF, IN THE OPINION OF THE AUTHORITY, THE CONDITIONS OF THE PERMIT ARE NOT BEING COMPLIED WITH. THIS APPROVAL DOES NOT EXEMPT THE PROPERTY OWNER/APPLICANT/AGENT FROM THE PROVISIONS OF ANY OTHER FEDERAL, PROVINCIAL OR MUNICIPAL STATUTES, REGULATIONS OR BY-LAWS, OR ANY RIGHTS UNDER COMMON LAW.
2. FOLLOWING INSTALLATION OF THE PROPOSED ESC MEASURES, A QUALIFIED AGENT OF THE PROPONENT, PREFERABLY AN ENVIRONMENTAL MONITOR, WILL CONDUCT REGULAR SITE VISITS TO MONITOR ALL WORKS, PARTICULARLY THE CONDITION OF THE ESC MEASURES, DEWATERING, AND IN- OR NEAR-WATER WORKS. SHOULD CONCERNS ARISE, THE ENVIRONMENTAL MONITOR WILL CONTACT THE PROPONENT, CVC, AND ANY OTHER APPROPRIATE PARTIES.
3. ALL CONSTRUCTION ACTIVITIES, INCLUDING MAINTENANCE PROCEDURES, WILL BE CONTROLLED TO PREVENT THE ENTRY OF DEBRIS, SEDIMENTS, OR OTHER DELETERIOUS PRODUCTS TO THE WATERCOURSE OR WETLAND. EQUIPMENT MAINTENANCE WILL BE CONDUCTED A MINIMUM OF 30 METRES FROM THE WATERCOURSE/WETLAND.
4. SEDIMENT LADEN RUNOFF FROM DISTURBED AREAS TO THE WATERCOURSE OR NATURAL FEATURE IS NOT ALLOWED. ALL DEWATERING SHALL BE TREATED AND THEN RELEASED AWAY FROM A WATERCOURSE OR WETLAND. DISCHARGE IS TO BE RELEASED TO AN UNDISTURBED NATURAL AREA. THESE CONTROL MEASURES SHALL BE MONITORED AND MAINTAINED OR REVISED TO ENSURE WATER QUALITY TARGETS ARE BEING ACHIEVED.
5. PLEASE REFER TO ESC GUIDELINE FOR URBAN CONSTRUCTION (DECEMBER 2006) FOR THE DESIGN AND DESIGN ALTERATION OF ESC MEASURES.
6. ESC MEASURES WILL BE IMPLEMENTED PRIOR TO, AND MAINTAINED DURING THE CONSTRUCTION PHASES, TO PREVENT ENTRY OF SEDIMENT INTO THE WATERCOURSE/NATURAL AREAS. ESC MEASURES ARE TO BE EVALUATED ON A WEEKLY BASIS AND AFTER ANY STORM EVENT. ANY REPAIRS REQUIRED ARE TO BE RECTIFIED IMMEDIATELY.
7. THE EROSION AND SEDIMENT CONTROL (ESC) PLAN IS A DYNAMIC DOCUMENT, WHICH MAY BE SUBJECT TO CHANGE OR MODIFICATIONS AS A RESULT OF SITE DEVELOPMENTS OR CHANGES ON SITE. ANY DEVIATION FROM APPROVED PLANS MUST BE DESIGNED BY A QUALIFIED PROFESSIONAL.
8. ADDITIONAL ESC MATERIALS (I.E. SILT FENCE, FILTER SOCKS, STRAW BALES, CLEAR STONES, ETC.) ARE TO BE KEPT ON SITE FOR EMERGENCIES AND REPAIRS.
9. THE PROJECT PROPONENT OR THEIR REPRESENTATIVE IS ULTIMATELY RESPONSIBLE FOR CONTROLLING SEDIMENT AND EROSION WITHIN THE CONSTRUCTION SITE FOR THE TOTAL PERIOD OF THE CONSTRUCTION.
10. DISTURBED AREAS WILL BE MINIMIZED TO THE EXTENT POSSIBLE, AND TEMPORARILY OR PERMANENTLY STABILIZED OR RESTORED AS THE WORK PROGRESSES. ALL DISTURBED GROUND LEFT INACTIVE FOR MORE THAN 30 DAYS SHALL BE STABILIZED USING APPROPRIATE EROSION CONTROL MEASURES AND AN APPROPRIATE NATIVE NON-INVASIVE SEED MIX OR WITH THE FINAL APPROVED RESTORATION PLAN.
11. ANY SEDIMENT SPILL FROM THE SITE SHOULD BE REPORTED TO MINISTRY OF ENVIRONMENT (SPILL ACTION CENTER) AT 1-800-268-6060.
12. IF EXCESSIVE SILTATION RESULTS FROM THE CONSTRUCTION ACTIVITIES, THE ONSITE SUPERVISOR/INSPECTOR AND/OR CVC RESERVE THE RIGHT TO REQUEST ADDITIONAL ESC MEASURES WHICH WOULD BE INSTALLED PRIOR TO FURTHER CONSTRUCTION ACTIVITIES.

**SITE-SPECIFIC NOTES:**

13. THE CONTRACTOR SHALL MONITOR WEATHER FORECASTS TO ENSURE THAT THE WORKS WILL BE CONDUCTED IN FAVOURABLE WEATHER. THE CONTRACTOR IS RESPONSIBLE FOR REMOVING ALL CONSTRUCTION EQUIPMENT AND MATERIALS THAT WOULD HAVE POTENTIAL TO CAUSE A SPILL OR OBSTRUCTION (I.E. FUEL TANKS, PORTABLE TOILETS, MACHINERY, ETC.), FROM THE 100 YEAR\* FLOODPLAIN IN THE CASE OF A LARGE STORM EVENT OR SITE SPECIFIC STORM EVENT. CROSSING AN ACTIVE WATERCOURSE OR WETLAND BY EQUIPMENT, VEHICLES, PERSONNEL, ETC. IS NOT PERMITTED UNLESS APPROVED BY CVC. ALL ACCESS TO WORK SITES SHALL BE FROM EITHER SIDES OF THE WATERCOURSE OR WETLAND.
14. ALL IN-WATER AND NEAR WATER WORKS WILL BE CONDUCTED IN THE DRY AND MUST BE STAGED WITH APPROPRIATE EROSION AND SEDIMENT CONTROLS. PLAN THE WORK ACCORDINGLY WITH THE WEATHER FORECAST.
15. AN AFTER-HOURS CONTACT NUMBER IS TO BE VISIBLY POSTED ON-SITE FOR EMERGENCIES. ALL THE PLANS SHOULD HAVE NAME AND CONTACT INFO OF THE PERSON RESPONSIBLE FOR ESC MEASURES.

No.	ISSUE / REVISION	DATE
0	ISSUED FOR OPA/ZBA	2024/NOV/21
1	ISSUE / REVISION	YYYY/MM/DD

**MISSISSAUGA**  
Transportation and Works

**STANDARD**  
STONE PAD  
CONSTRUCTION ENTRANCE

EFF. DATE 2002-01-01 SCALE N.T.S.  
REV. STANDARD No. 2970.010

**MISSISSAUGA**  
Transportation and Works

**STANDARD**  
SEDIMENT CONTROL FENCE

EFF. DATE 2002-01-01 SCALE N.T.S.  
REV. STANDARD No. 2940.010

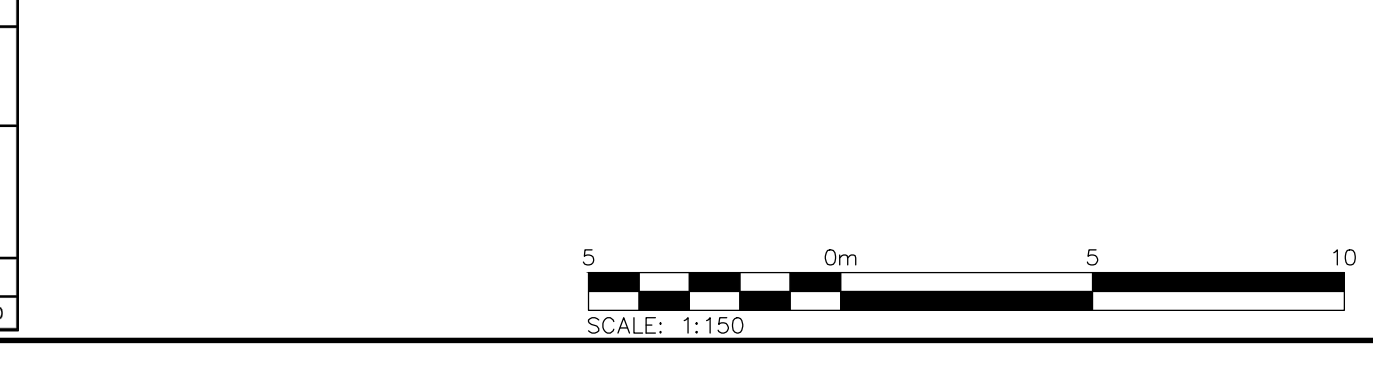

**PROFESSIONAL ENGINEER**  
J. W. SCOTT  
100214964  
NOV 21 2024  
PROVINCE OF ONTARIO

**CROZIER**  
CONSULTING ENGINEERS

Project No. **1113-7066**  
Scale 1:150 DWG. **C101**

Drawn A.A./L.E. Design K.W./J.S. Project No. 1113-7066  
Check J.S. Check J.S. Scale 1:150 DWG. C101